

CONTRACT NO. 76D61

F.A. ROUTE SECTION

999 82-1B-2

FED. AID PROJECT ILLINOIS

COUNTY ST. CLAIR

USER NAME = John Keaven

PLOT SCALE = 20.0000' / IN.

PLOT DATE = 4/14/2010

DESIGNED - HNTB

CHECKED - CMT

DRAWN - CMT / HNTB

REVISED -

REVISED -

REVISED -

REVISED -

REVISED -

REVISED -

REVISED -

REVISED -

REVISED -

REVISED -

REVISED -

REVISED -

REVISED -

REVISED -

REVISED -

REVISED -

REVISED -

REVISED -

REVISED -

REVISED -

REVISED -

REVISED -

REVISED -

REVISED -

REVISED -

REVISED -

REVISED -

REVISED -

REVISED -

REVISED -

REVISED -

REVISED -

REVISED -

REVISED -

REVISED -

REVISED -

REVISED -

REVISED -

REVISED -

REVISED -

REVISED -

REVISED -

REVISED -

REVISED -

REVISED -

REVISED -

REVISED -

REVISED -

REVISED -

REVISED -

REVISED -

REVISED -

GRADING PLAN
ACCESS ROAD DETENTION
ILLINOIS APPROACH STRUCTURE
FOR NEW I-70 MISSISSIPPI RIVER BRIDGE
STA. 60+50 TO STA. 66+00

STATE OF ILLINOIS
DEPARTMENT OF TRANSPORTATION
MISSOURI HIGHWAYS
AND TRANSPORTATION COMMISSION

HNTB
715 KIRK DRIVE
KANSAS CITY, MO 64105
TELEPHONE (816) 472-1201
CERTIFICATE OF AUTHORITY
NO. 001270

CMT
CRANFORD, MURPHY & TILLY, INC.
2750 WEST WASHINGTON STREET
SPRINGFIELD, IL 62702
TELEPHONE (217) 787-8050
ENGINEERING CORPORATION - 000631

SHEET 42 OF 81

SEE SHEET 41
MATCH LINE STA 66+00

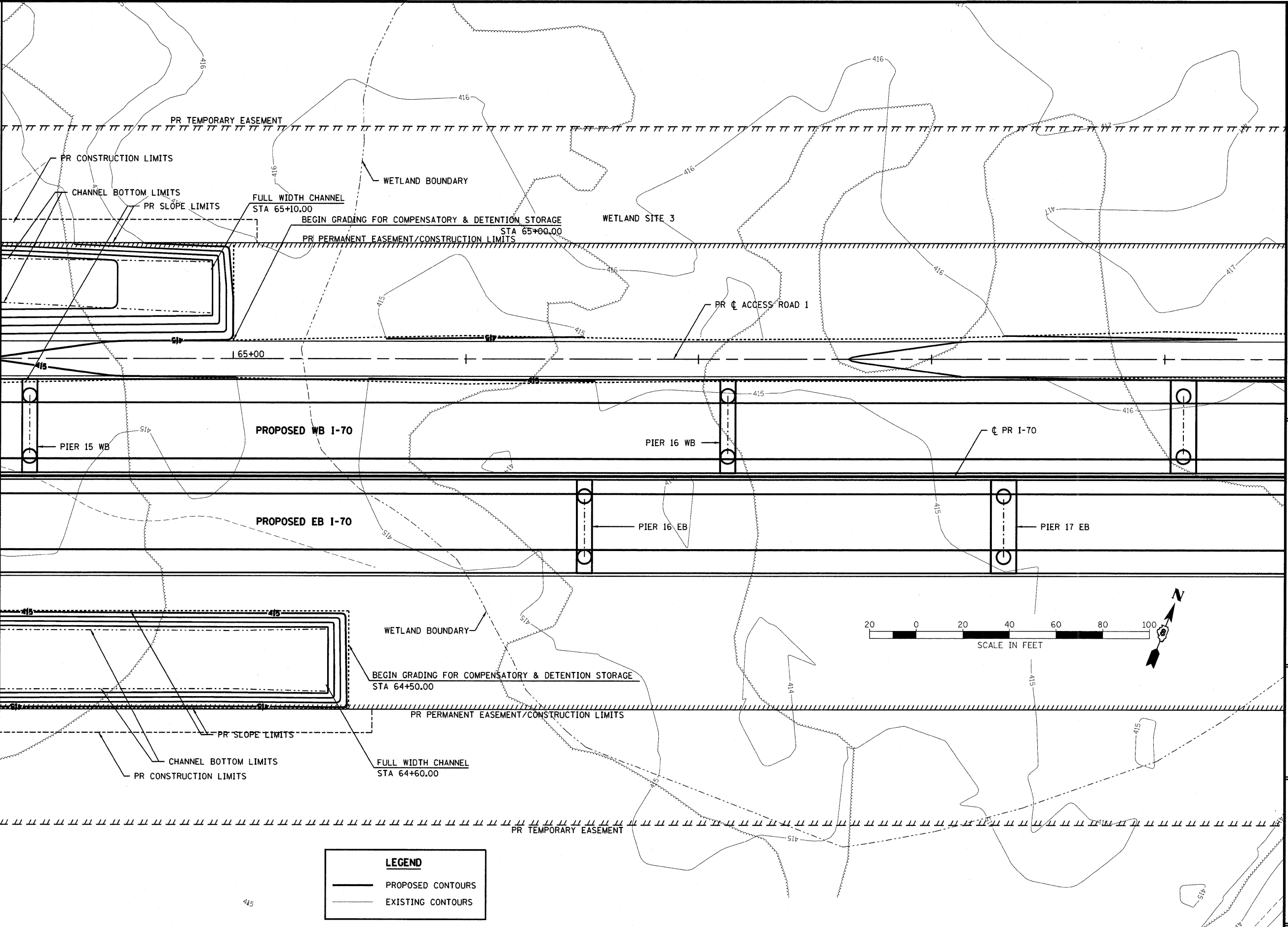

LEGEND	
	PROPOSED CONTOURS
	EXISTING CONTOURS

