

TREE REMOVAL  
 TREE REMOVAL UNITS

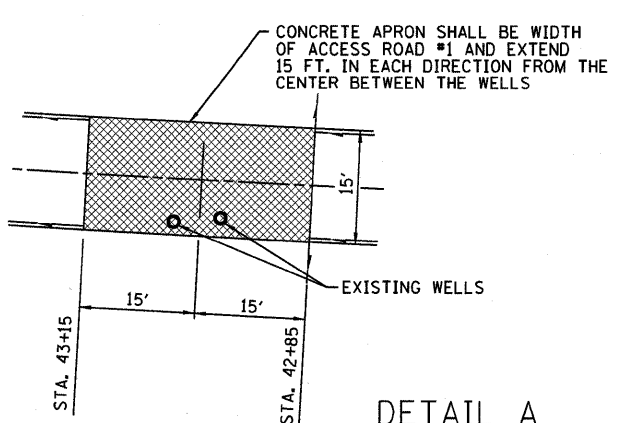
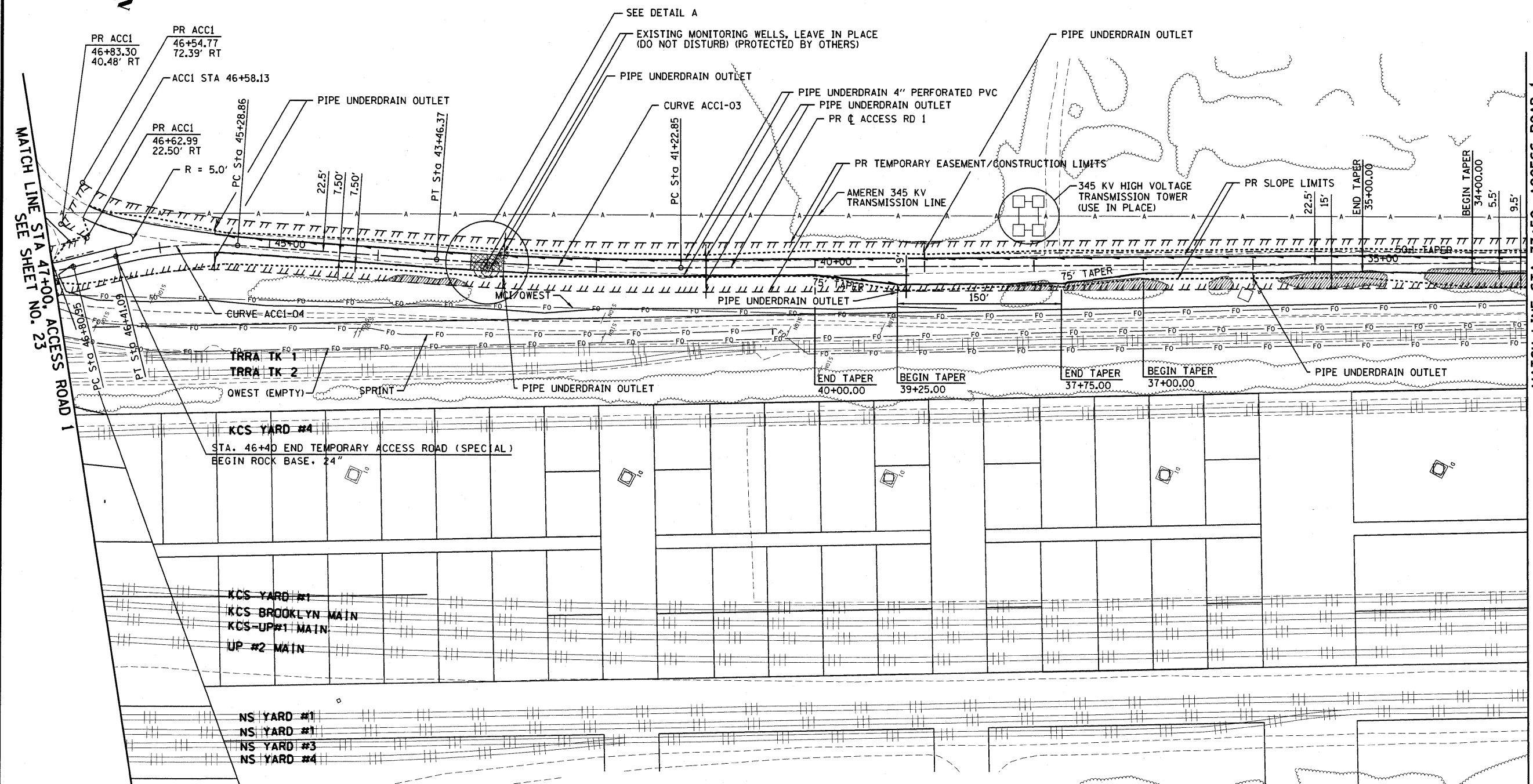

NOTE:  
 THE CONTRACTOR SHALL CONNECT TO THE UNDERDRAIN AND GEOMEMBRANE PROVIDED BY AMEREN'S CONTRACTOR. CARE SHALL BE TAKEN WHEN EXCAVATING ON BOTH ENDS OF THE CONCRETE APRON TO AVOID DAMAGING THE MATERIAL LEFT BY AMEREN'S CONTRACTOR FOR THESE CONNECTIONS. NO SEPARATE PAYMENT WILL BE MADE FOR MAKING THE CONNECTIONS. THE COST OF MAKING THESE CONNECTIONS SHALL BE INCLUDED IN THE PRICE OF THE TEMPORARY ACCESS ROAD (SPECIAL).

NOTE:  
 CONCRETE APRON BY AMEREN OR AMEREN'S CONTRACTOR IS INTENDED TO BE IN PLACE PRIOR TO CONSTRUCTION ACTIVITIES ON ACCESS ROAD #1 IN THIS AREA.

GENERAL NOTE:  
 CONTRACTOR SHALL CONTACT NORFOLK SOUTHERN (NS), TERMINAL RAILROAD ASSOCIATION OF ST. LOUIS (TRRA), KANSAS CITY SOUTHERN RAILWAY (KCS) AND UNION PACIFIC RAILWAY COMPANY (UP) DIRECTLY FOR LOCATION OF RAILROAD UTILITIES ON RAILROAD RIGHT-OF-WAY.

CONTRACT NO. 76D61	
F.A. ROUTE	SECTION
999	82-1B-2
FED. AID PROJECT	ILLINOIS
COUNTY	ST. CLAIR
USER NAME = John Keeven	
PLOT SCALE = 50,0000' / IN.	
PLOT DATE = 4/14/2010	
DESIGNED -	HNTB
CHECKED -	CMT
DRAWN -	CMT / HNTB
REVISED -	
REVISED -	
REVISED -	
REVISED -	

**PROPOSED PLAN**  
**ACCESS ROADS**  
 ILLINOIS APPROACH STRUCTURE  
 FOR NEW I-70 MISSISSIPPI RIVER BRIDGE  
 STA. 33 + 50 TO STA. 47 + 00

STATE OF ILLINOIS  
 DEPARTMENT OF TRANSPORTATION  
 MISSOURI HIGHWAYS  
 AND TRANSPORTATION COMMISSION

**HNTB**  
 715 KIRK DRIVE  
 KANSAS CITY, MO 64105  
 TELEPHONE (816) 472-1201  
 CERTIFICATE OF AUTHORITY  
 NO. 001270

**CMT**  
 CRAWFORD, MURPHY & TILLY, INC.  
 2750 WEST WASHINGTON STREET  
 SPRINGFIELD, IL 62702  
 TELEPHONE (217) 787-8050  
 ENGINEERING CORPORATION - 000631

SHEET 8 OF 10  
**ROADWAY PLANS**  
**ACCESS ROAD 1**