

AS-BUILT PLANS - S.N. 074-0055 FOR INFORMATION ONLY

ROUTE NO.	SECTION	COUNTY	TOTAL SHEETS	SHEET NO.	SHEET NO. / SHEETS 15
58-68	HB-2	MACON & PIATT	77	16	
FED. ROAD DIST. NO. 7 ILLINOIS FED. AID PROJECT					

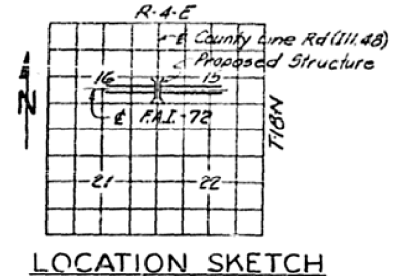

LOCATION SKETCH

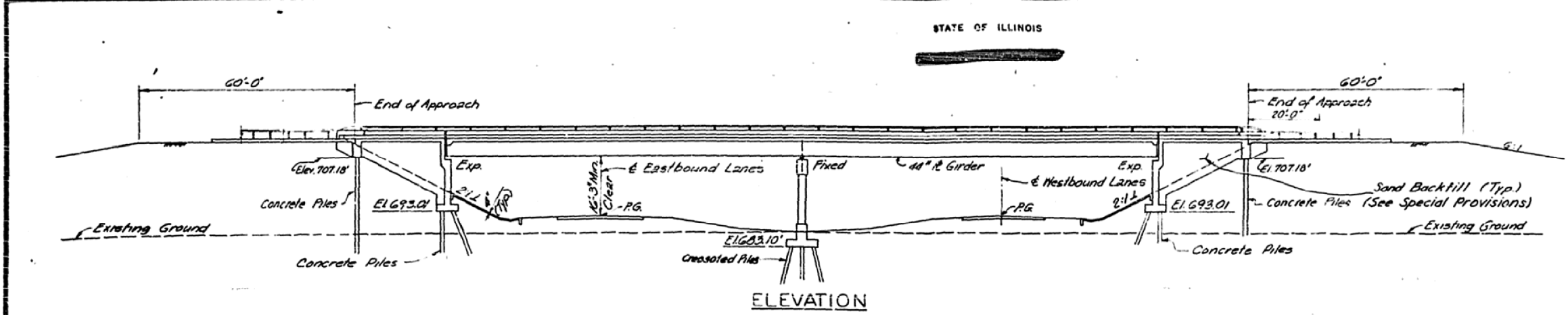
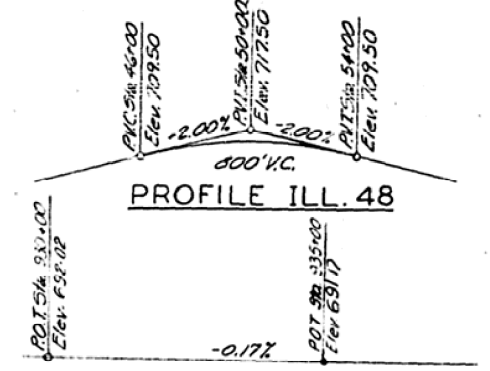

PROFILE ILL. 48

PROFILE F.A.I.-72

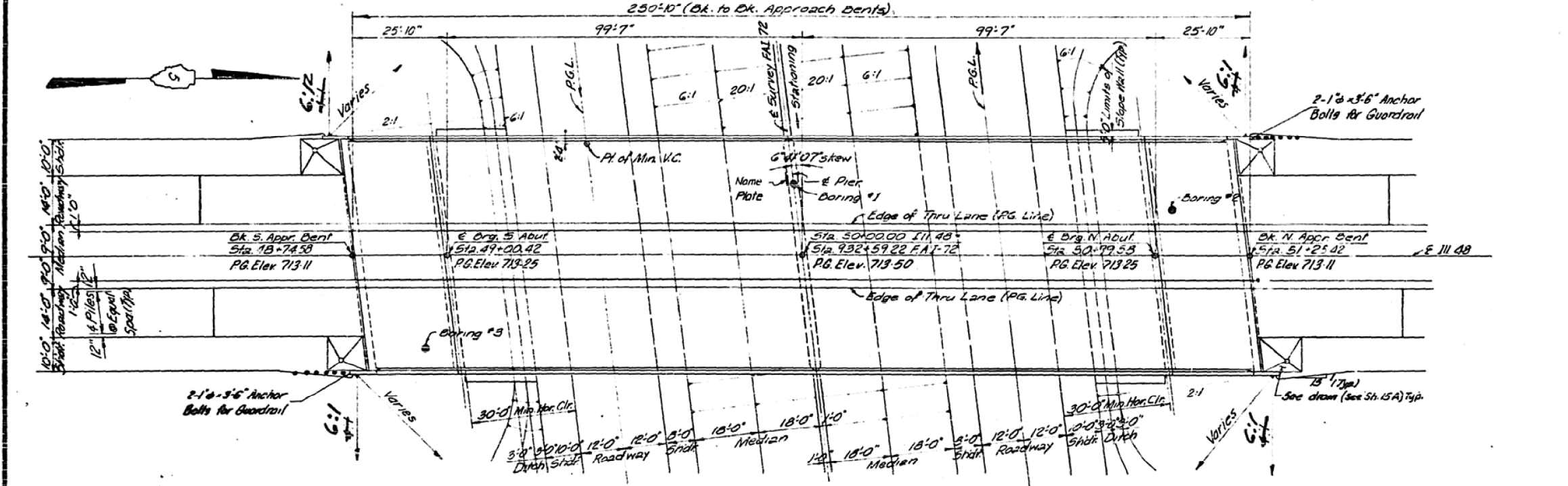

PLAN

TOTAL BILL OF MATERIALS

Item	Unit	Super	Sub	Total	
Aluminum Railing	Lin. Ft.	587	-	587	587
Sand Backfill	Cu. Yd.	-	780	780	780
Structure Excavation	Cu. Yd.	-	185	185	185
Class X Concrete	Cu. Yd.	607.2	425.6	1029.6	1029.6
Furnishing & Erecting Structural Steel	Lump Sum	1	-	1	1
Furnishing Concrete Piles	Lin. Ft.	-	3578	3578	3578
Furnishing Crossed Piles Up to 20 Feet	Lin. Ft.	-	1442	1442	1442
Drilling Timber Piles	Lin. Ft.	-	4240	4240	4240
Drilling Concrete Piles	Lin. Ft.	-	3578	3578	3578
Test Pile Concrete	Each	-	1	1	1
Test Pile Timber	Each	-	1	1	1
Name Plates	Each	-	1	1	1
Performed Joint Sealer 2 1/2"	Lin. Ft.	137	-	137	137
Slope Wall (4 Inch)	Sq. Yd.	-	419	419	419
Protective Coat	Sq. Yd.	629	-	629	629
Bituminous Core Surface Course, Class I	Ton	113	-	113	113
Waterproofing Membrane System	Sq. Yd.	4366	-	4366	4366
Stud Shear Connectors	Each	3060	-	3060	3060
Reinforcement Bars	Lb.	165830	56,000	221,830	221,830

DESIGNED	J.M.M.
CHECKED	CEB 10-71
DRAWN	J.M.M. 10-1-71
CHECKED	CEB 10-71

DESIGN STRESSES
 f_c = 1400 psi Curb, Parapet & Substructure
 f_c = 1200 psi Superstructure
 f_t = 75 psi Footing
 f_s = 20,000 psi Reinforcing
 f_s = 20,000 psi Structural
 n = 10
 LL Deflection = 1/800 (Composite)
LOADING: HS20-44
 Allow 25% for Future W.S.
 Design Specifications, AASHTO 1969
 as applicable
 B.M. H-9 - Ill. Division of Highways Monument
 1000 N. Sta. 933+35 (I-72) Elev. 688.28

APPROVED
 FOR STRUCTURAL ADEQUACY ONLY
Carl E. Shannon Jr.
 REGISTERED STRUCTURAL ENGINEER
 REGISTER OF BRIDGE & TRAFFIC STRUCTURES

GENERAL PLAN & ELEVATION
 PROJ. I-72-2 (48)52
 F.A.I. 72 SEC. 58-66-HB-2
 MACON & PIATT COUNTIES
 STA. 932+59.22 (F.A.I. 72)