

F.A.I. RTE.	SECTION	COUNTY	TOTAL SHEETS	SHEET NO.
72	*	PIATT	251	136
STA. 1297+00		TO STA. 1327+00		
FED. ROAD DIST. NO.	ILLINOIS	FED. AID PROJECT		

*(58,74-66)&(74-67&68)RS-1

- 1 SEE DETAIL FOR FLARE GUARDRAIL AT DUAL STRUCTURES.
- 2 SEE DETAIL FOR TRAFFIC BARRIER TERMINAL, TYPE 6B (SPECIAL).

EXIST CURVE (MAINLINE)
 PI STA. = 1316+94.74
 $\Delta = 49^\circ 29' 56''$ (RT)
 $D = 1^\circ 16' 00''$
 $R = 4,523.35'$
 $T = 2,085.24'$
 $L = 3,907.81'$
 $E = 457.51'$
 $e = \text{-----}$
 $T.R. = \text{-----}$
 $S.E. \text{ RUN} = \text{-----}$
 $P.C. \text{ STA} = 1296+09.50$
 $P.T. \text{ STA} = 1335+17.31$

MAINLINE PAVING OMISSION
 STA. 1300+54.10 TO STA. 1302+62.80 (EB)
 STA. 1300+45.65 TO STA. 1302+54.29 (WB)

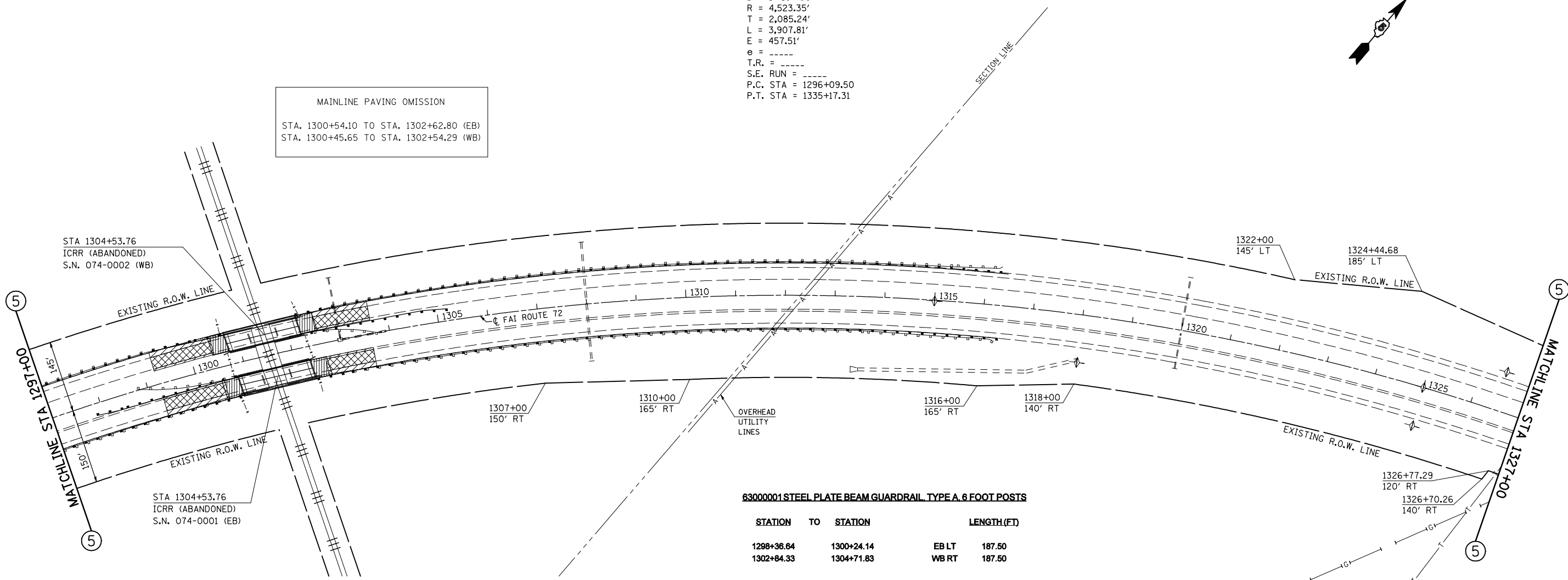

6300001 STEEL PLATE BEAM GUARDRAIL TYPE A, 6 FOOT POSTS

STATION	TO	STATION		LENGTH (FT)
1298+36.64		1300+24.14	EB LT	187.50
1302+84.33		1304+71.83	WB RT	187.50

6300003 STEEL PLATE BEAM GUARDRAIL TYPE A, 9 FOOT POSTS

STATION	TO	STATION		LENGTH (FT)
1291+27.95		1300+27.95	EB RT	900.00
1302+93.39		1316+18.39	EB RT	1325.00
1291+40.11		1300+15.11	WB LT	875.00
1302+80.52		1315+93.02	WB LT	1312.50

63100085 TRAFFIC BARRIER TERMINAL TYPE 6B (SPECIAL)

STATION	TO	STATION		EACH
1300+27.95		1300+82.97	EB RT	1.0
1300+24.14		1300+79.16	EB LT	1.0
1302+38.37		1302+93.39	EB RT	1.0
1300+15.11		1300+70.13	WB LT	1.0
1302+25.50		1302+80.52	WB LT	1.0
1302+29.31		1302+84.33	WB RT	1.0

63100045 TRAFFIC BARRIER TERMINAL TYPE 2

STATION	TO	STATION		EACH
1291+25.84		1291+40.11	WB LT	1.0
1316+18.39		1316+32.66	EB RT	1.0

63100169 TRAFFIC BARRIER TERMINAL TYPE 1 (SP) TANGENT

STATION	TO	STATION		EACH
1290+77.95		1291+27.95	EB RT	1.0
1315+93.02		1316+43.02	WB LT	1.0

63100169 TRAFFIC BARRIER TERMINAL TYPE 1 (SP) FLARED

STATION	TO	STATION		EACH
1297+86.64		1298+36.64	EB LT	1.0
1304+71.83		1305+21.83	WB RT	1.0

78201000 TERMINAL MARKER - DIRECT APPLIED

STATION		EACH
1290+77.95	EB RT	1.0
1297+86.64	EB LT	1.0
1305+21.83	WB RT	1.0
1316+43.02	WB LT	1.0

63200310 GUARDRAIL REMOVAL

STATION	TO	STATION		LENGTH (FT)
1290+88.00		1300+73.57	EB RT	985.57
1298+09.00		1300+69.76	EB LT	160.76
1302+50.27		1316+27.00	EB RT	1376.73
1291+30.00		1300+58.23	WB LT	928.23
1302+38.71		1303+88.30	WB RT	149.59
1302+34.90		1316+34.80	WB LT	1399.90

- HMA SURFACE REMOVAL, 1/2"
- HOT MIX ASPHALT SURFACE REMOVAL BUTT-JOINT
- AREA OF MILLING & RESURFACING TRANSITION

SEE MILLING AND BUTT-JOINT DETAILS

BURIED 100 PR COPPER CABLE

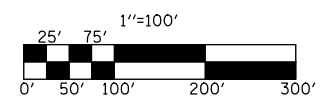

REVISIONS	
NAME	DATE

ILLINOIS DEPARTMENT OF TRANSPORTATION
PLAN VIEW
 F.A.I. ROUTE 72
 SECTION: (58,74-66)&(74-67&68)RS-1
 PIATT COUNTY
 SCALE: 1" = 100'
 DATE: 10/18/05
 DRAWN BY: CADD
 CHECKED BY:

PLAN NOTE: THERE ARE GUARDPOSTS AND DELINEATORS TO BE REMOVED AND REPLACED IN THIS SECTION. THE ENGINEER SHALL CONDUCT A PRELIMINARY SURVEY TO DETERMINE QUANTITY OF EACH ITEM PRIOR TO CONSTRUCTION.

PLOT DATE = 2/8/2010
 FILE NAME = g:\p\w\w\k\PIA\DOT\BUCKLESJJ\d0109678\100pl.amc.dgn
 PLOT SCALE = 211.7647 / IN.
 USER NAME = bucklesjj