

F.A.I. RTE.	SECTION	COUNTY	TOTAL SHEETS	SHEET NO.
72	*	PIATT	251	117
STA. 1090+00		TO STA. 1119+00		
FED. ROAD DIST. NO.	ILLINOIS	FED. AID PROJECT		

*(58,74-66)&(74-67&68)RS-1

- 1 SEE STRUCTURE PLANS, S.N. 074-0060.
- 2 PLAN NOTE: UPON COMPLETION OF THE PROJECT, THE VERTICLE CLEARANCES OF ALL AFFECTED OVERHEAD STRUCTURE SHALL BE VERIFIED AND REPORTED TO THE BUREAU OF OPERATIONS BY THE RESIDENT ENGINEER.
- 3 SEE DETAIL FOR CRASHWALL EXTENSIONS AT S.N. 074-0060.
- 4 SEE DETAIL FOR IMPACT ATTENUATORS (NON-DIRECTIVE) TEST LEVEL 3.

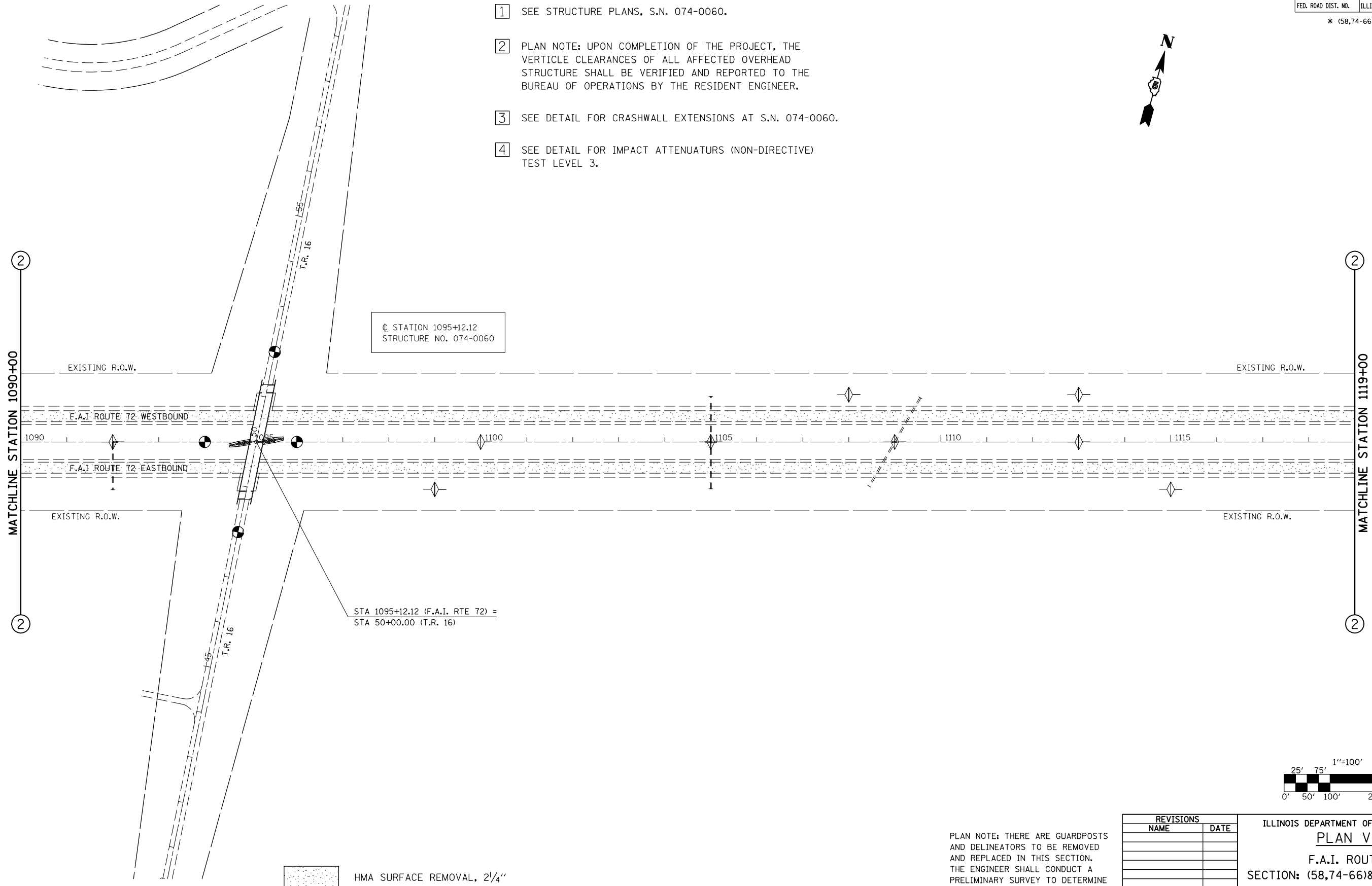

⊥ STATION 1095+12.12
STRUCTURE NO. 074-0060

STA 1095+12.12 (F.A.I. RTE 72) =
STA 50+00.00 (T.R. 16)

HMA SURFACE REMOVAL, 2 1/4"

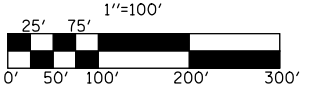

PLAN NOTE: THERE ARE GUARDPOSTS AND DELINEATORS TO BE REMOVED AND REPLACED IN THIS SECTION. THE ENGINEER SHALL CONDUCT A PRELIMINARY SURVEY TO DETERMINE QUANTITY OF EACH ITEM PRIOR TO CONSTRUCTION.

REVISIONS	
NAME	DATE

ILLINOIS DEPARTMENT OF TRANSPORTATION
PLAN VIEW
F.A.I. ROUTE 72
SECTION: (58,74-66)&(74-67&68)RS-1
PIATT COUNTY
SCALE: 1" = 100'
DATE: 10/18/05
DRAWN BY: CADD
CHECKED BY:

PLOT DATE = 2/8/2010
FILE NAME = G:\pwork\PMIDOT\BUCKLESJJ\d0109678\100pland.dgn
PLOT SCALE = 211.7647 / IN.
USER NAME = bucklesjj