

F.A.I. RTE.	SECTION	COUNTY	TOTAL SHEETS	SHEET NO.
72	*	PIATT	251	106
STA. 918+00		TO STA. 948+00		
FED. ROAD DIST. NO.	ILLINOIS	FED. AID PROJECT		

*(58,74-66)&(74-67&68)RS-1

RAMP TRAFFIC CONTROL DETAIL

STAGE I
IL 48
NORTHBOUND LANE CLOSED
SN 074-0055

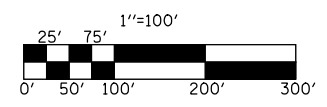
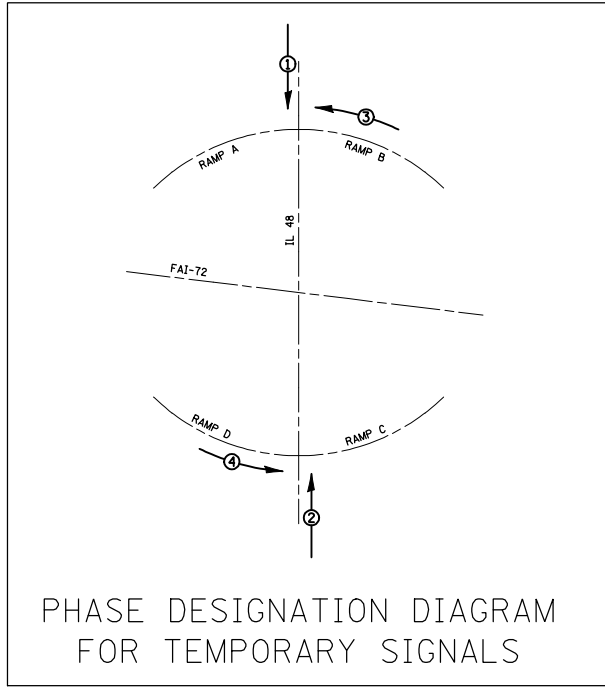
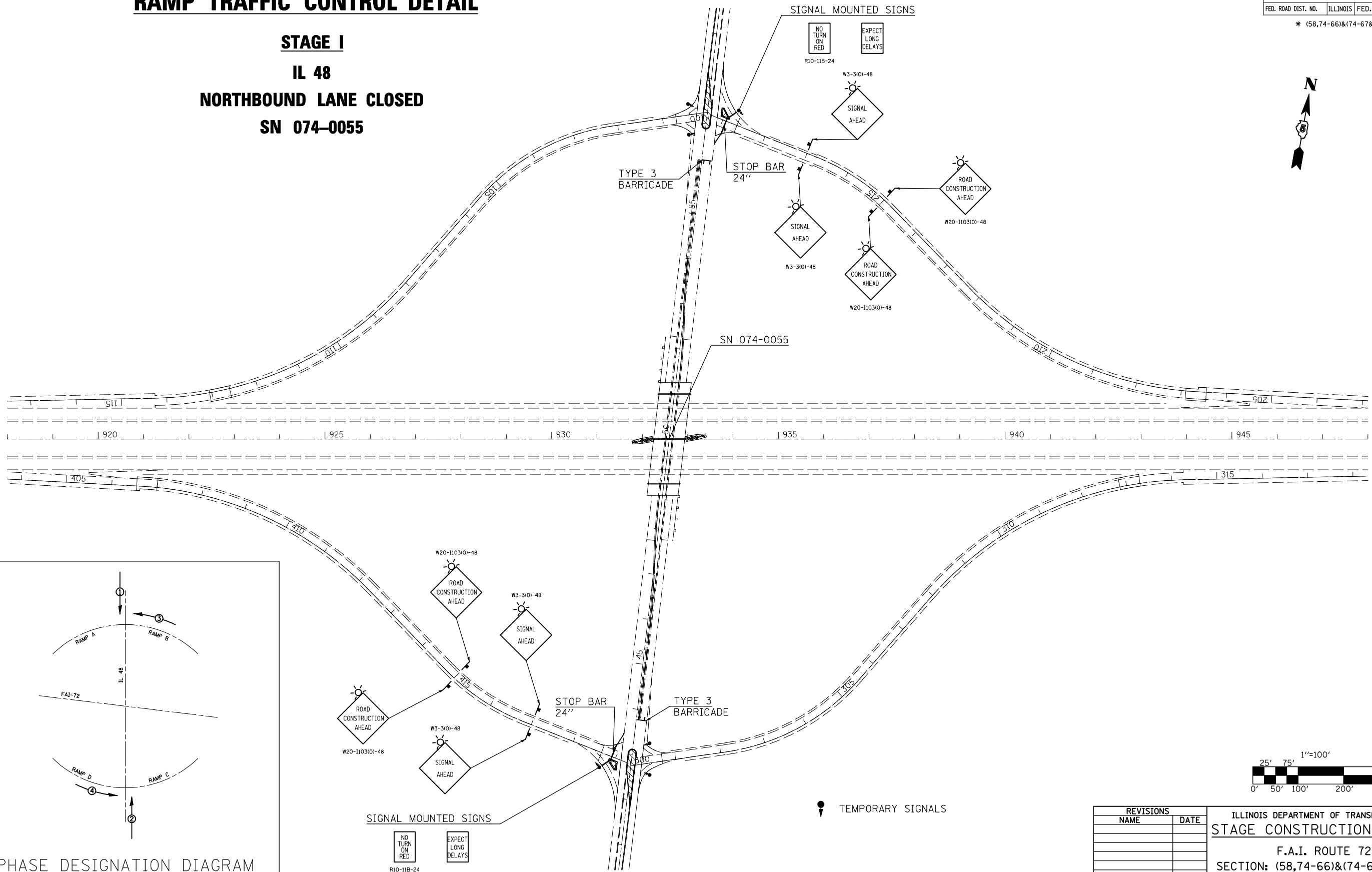

REVISIONS		ILLINOIS DEPARTMENT OF TRANSPORTATION	
NAME	DATE	STAGE CONSTRUCTION SIGNING	

F.A.I. ROUTE 72
 SECTION: (58,74-66)&(74-67&68)RS-1
 PIATT COUNTY

SCALE: 1" = 100'
 DATE: 10/18/05

DRAWN BY: CADD
 CHECKED BY:

PLOT DATE = 2/8/2010
 FILE NAME = g:\pwwork\pwwork\PIADOT\CEARLOCK\ID\0109678\0570022-sht-stagimg-IL48.dgn
 PLOT SCALE = 211.7647 / / IN.
 USER NAME = cearlockjd