

DATE	REVISION	BY

**LITCHFIELD MUNICIPAL AIRPORT
LITCHFIELD, ILLINOIS**

IL PROJ.: 31F-4046 A.I.P. PROJ.: 3-17-0063-B17

Hanson Project No. 10A0094D_0800	FILENAME R-191STK.DWG
Scale 1"=30'	Date 02/04/11
LAYOUT	BAK 02/11/11
DRAWN	BAK 02/11/11
REVIEWED	CAH 02/17/11



**TAXIWAY "C"
EXTENSION**
PROPOSED STAKING PLAN
STA. 65+76 TO STA. 72+00

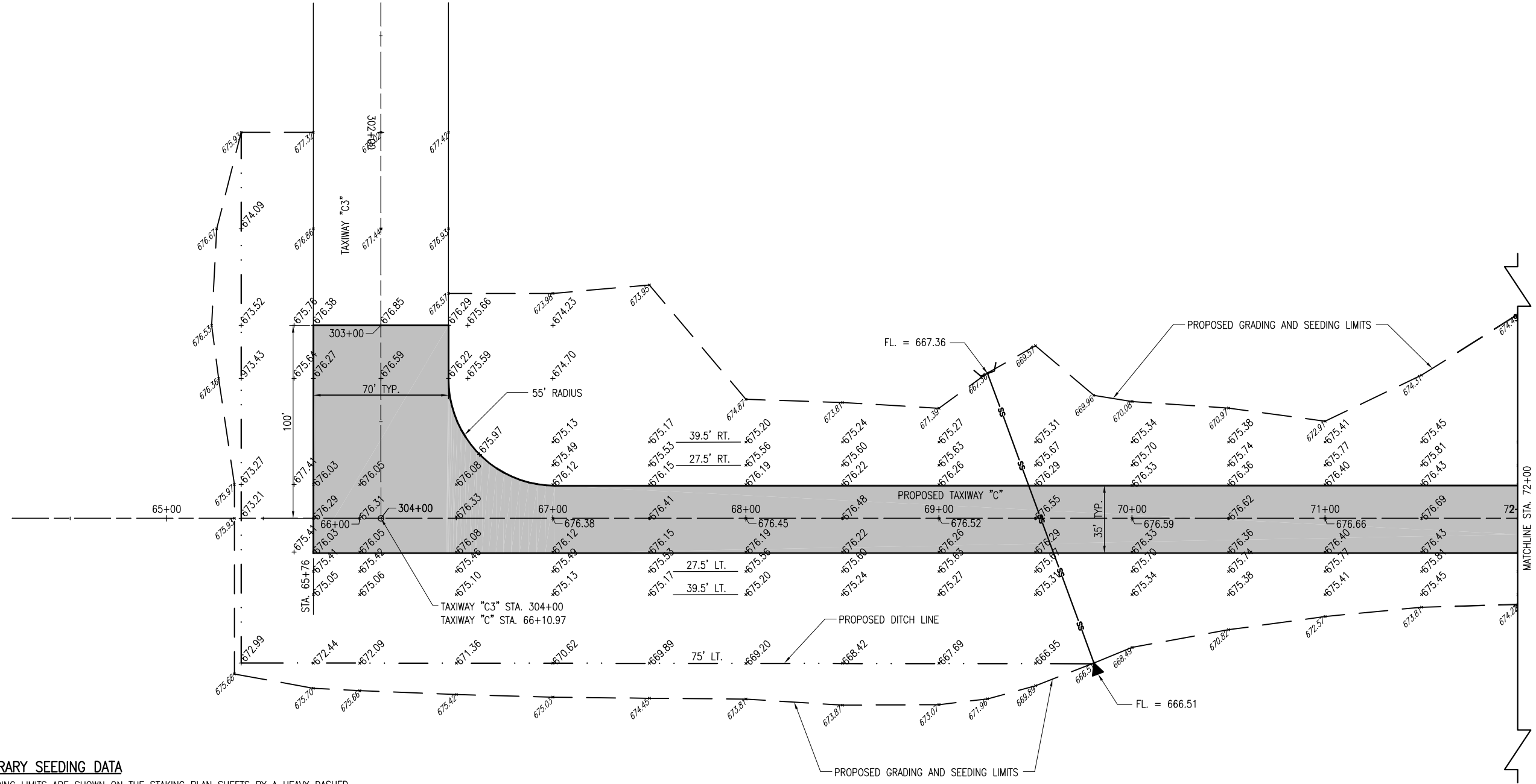

TEMPORARY SEEDING DATA
THE GRADING LIMITS ARE SHOWN ON THE STAKING PLAN SHEETS BY A HEAVY DASHED LINE (- - - -). ALL AREAS WITHIN THESE LIMITS, EXCEPT THE PROPOSED PAVEMENT, SHALL BE LIMED, FERTILIZED AND SEEDED IN ACCORDANCE WITH THE FOLLOWING FORMULA AND RATES OF APPLICATION.

SEEDING (MINIMUM POUNDS OF PURE LIVE SEED PER ACRE)
 PERENNIAL RYEGRASS _____ 50
 SPRING OATS* _____ 64
 *OTHER SEEDS MAY BE USED IF APPROVED BY THE ENGINEER.
 AREA TO BE SEEDED _____ 6.6 ACRES
 DATE SEEDING COMPLETED _____

- LEGEND**
- EXISTING IMPROVEMENTS
 - PROPOSED IMPROVEMENTS
 - PROPOSED GRADING AND SEEDING LIMITS
 - EXISTING GRADE
 - PROPOSED GRADE

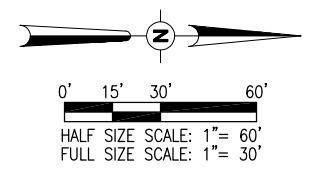

MAR 14, 2011 8:47 AM HAGL000382 I:\AIRPORTS\LITCHFIELD\10A0094\CADD\AIRPORT\SHEET\R-191STK.DWG - STA. 65+76 TO STA. 72+00