

Bench Mark: Railroad Spike in Power Pole E. Side of Bolton Road, N. of Bridge, 29' Rt. of Sta. 20+93, El. 788.23

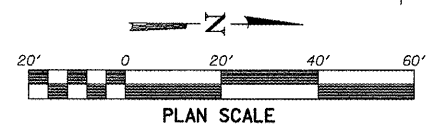

BOLTON ROAD - HORIZONTAL CONTROL POINTS					
PT #	STA.	N	E	EL.	DESCRIPTION
100	13.6' RT. 15+17.4	2057490.30	2417489.31	799.22	IP
101	13.2' RT. 19+36.9	2057909.73	2417484.84	790.21	IP
102	19.3' LT. 25+14.3	2058486.76	2417446.82	793.24	IP

BOLTON ROAD - VERTICAL CONTROL POINTS				
PT #	STA.	EL.	DESCRIPTION	
400	12.0' RT. 20+12	791.36	CHIS. "C" ON COR. OF EX. BRIDGE HEADWALL	
401	26.8' RT. 19+07	789.04	RAILROAD SPIKE IN PP	
402	29.1' RT. 20+93	788.23	RAILROAD SPIKE IN PP	

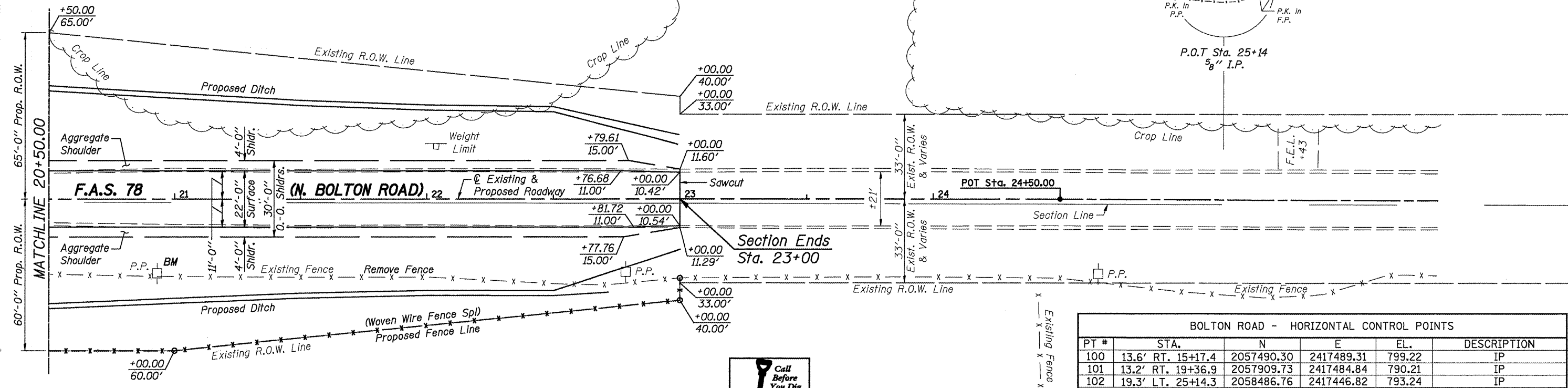
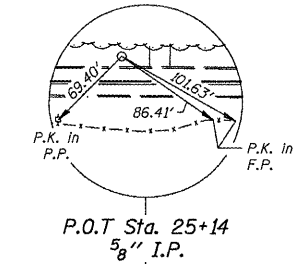
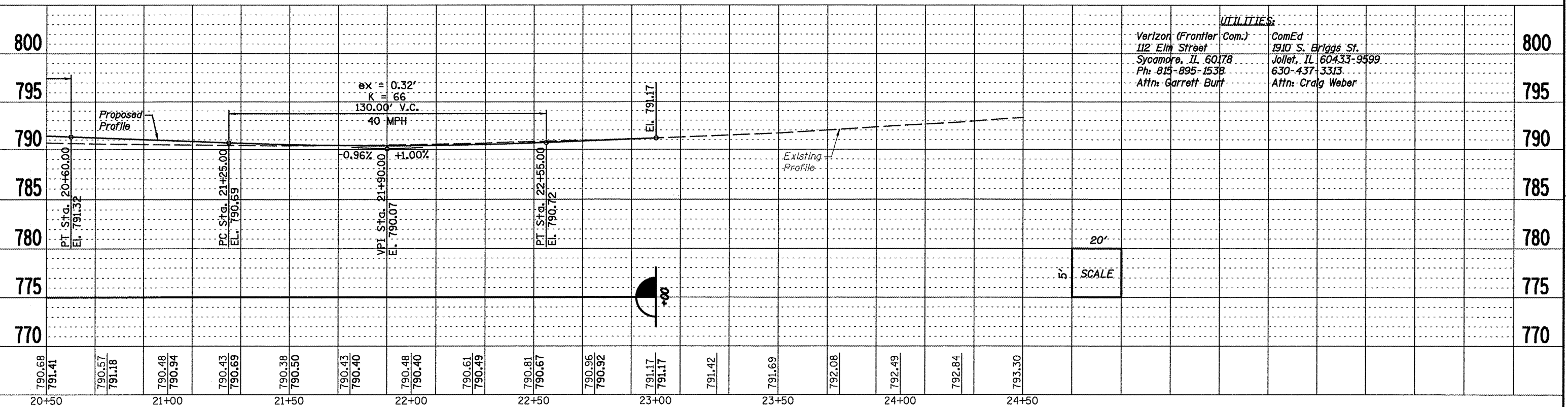

UTILITIES:
 Verizon (Frontier Com.)
 112 Elm Street
 Sycamore, IL 60178
 Ph: 815-895-1538
 Attn: Garrett Burf
 ComEd
 1910 S. Briggs St.
 Joliet, IL 60433-9599
 630-437-3313
 Attn: Craig Weber

REV.	DATE	BY	REMARKS

DRAWN
R.D.A.
CHECKED
M.A.C.
APPROVED
B.K.C.

**STEPHENSON COUNTY
 CULVERT REPLACEMENT
 F.A.S. 78 (N. BOLTON ROAD) OVER PRESTON CREEK
 2010**

WILLET, HOFMANN & ASSOCIATES, INC.
 CONSULTING ENGINEERS
 Land Surveying - Transportation - Structural
 Environmental - Architecture
 800 East Second Street, Dixon, Illinois 61021
 Phone 815-294-3381 Fax 815-294-3385
 Design Firm #184-000918
 www.willett-hofmann.com

PLAN & PROFILE

ROUTE NO.	SECTION	COUNTY	TOTAL SHEETS	SHEET NO.
F.A.S. 78	10-06118-00-BR	Stephenson	18	7
STA. 20+50.00 - STA. 24+50.00				
FED. ROAD DIST. NO. 7 ILLINOIS FED. AID PROJECT ER-0177(038)				

FILE = S:\PROJECTS\2010\11201010_Stephenson_Co_Bolton_Rd\DESIGN\STRUCT\YnpBoltonRd.dgn