

BM 304 - CHISELED "□" ON CONC SIGN BASE IN THE MEDIAN OF I-57/64, 1ST OVERHEAD SIGN SOUTH OF IL 148, EASTSIDE-FOUND AT STA 647+98, 32.5' W OF SB EOR ELEV. 475.733

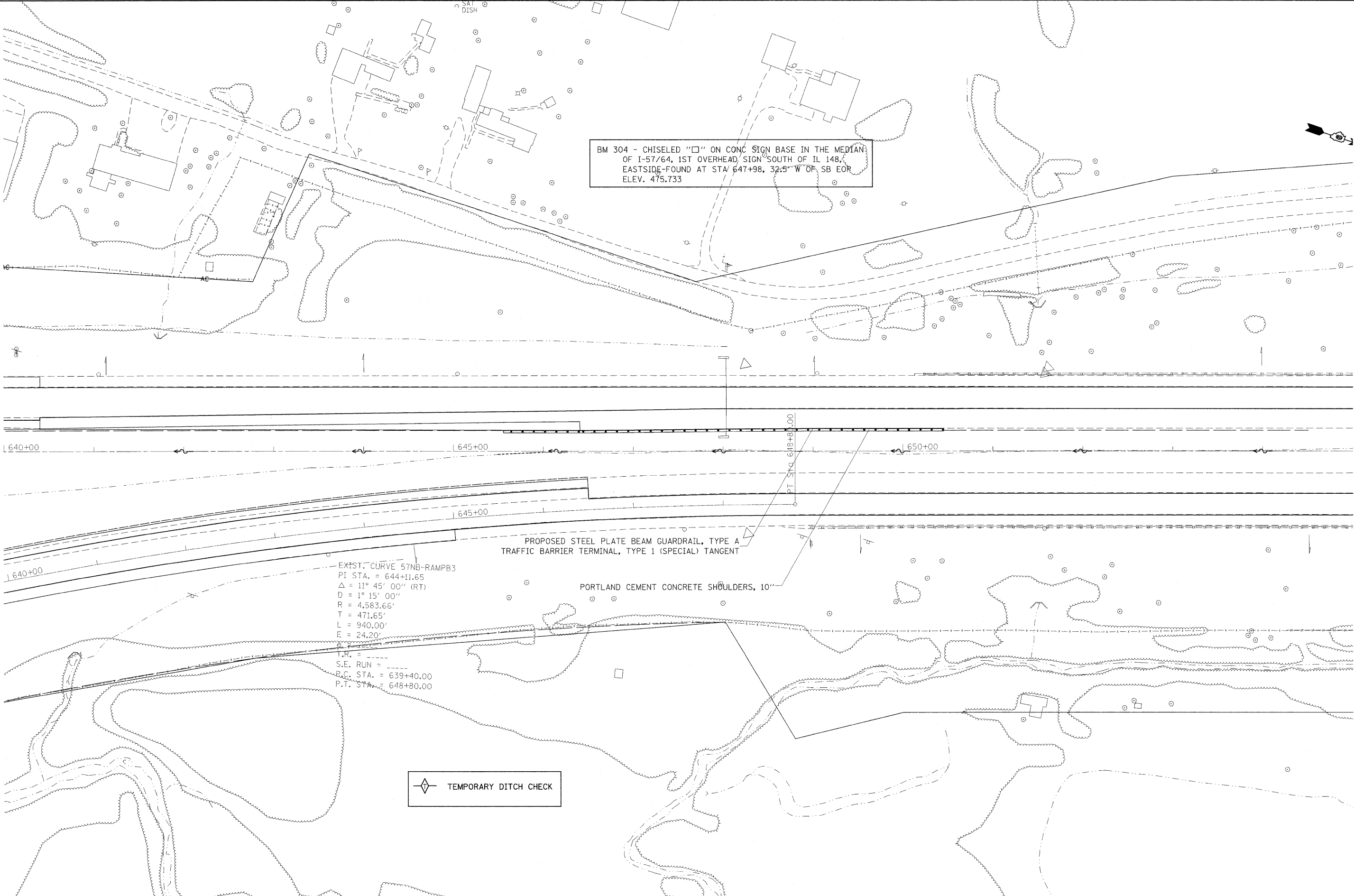

FILE NAME =	USER NAME = colemm	DESIGNED -	REVISED -
ct:\pw_work\pwwdot\colemm\d0169788\78172\sh-t-pln\dgn		DRAWN -	REVISED -
	PLOT SCALE = 50.0000' / IN.	CHECKED -	REVISED -
	PLOT DATE = 2/15/2011	DATE -	REVISED -

**STATE OF ILLINOIS
DEPARTMENT OF TRANSPORTATION**

PLAN 157

SCALE: SHEET NO. OF SHEETS STA. TO STA.

F.A.I. RTE.	SECTION	COUNTY	TOTAL SHEETS	SHEET NO.
57	*	Jefferson	422	103
CONTRACT NO. 78172			ILLINOIS FED. AID PROJECT	