



CITY OF DIXON, ILLINOIS

Post Office Box 386
Dixon, Illinois 61021
Telephone: 815.288.1485

DIXON MUNICIPAL AIRPORT
CHARLES R. WALGREEN FIELD

OVERLAY TAXIWAYS B, D AND E;
REHABILITATE FRONTAGE APRON
PAVEMENT

AIP PROJECT NO. 3-17-0036-B7
IDA PROJECT NO. C73-3436

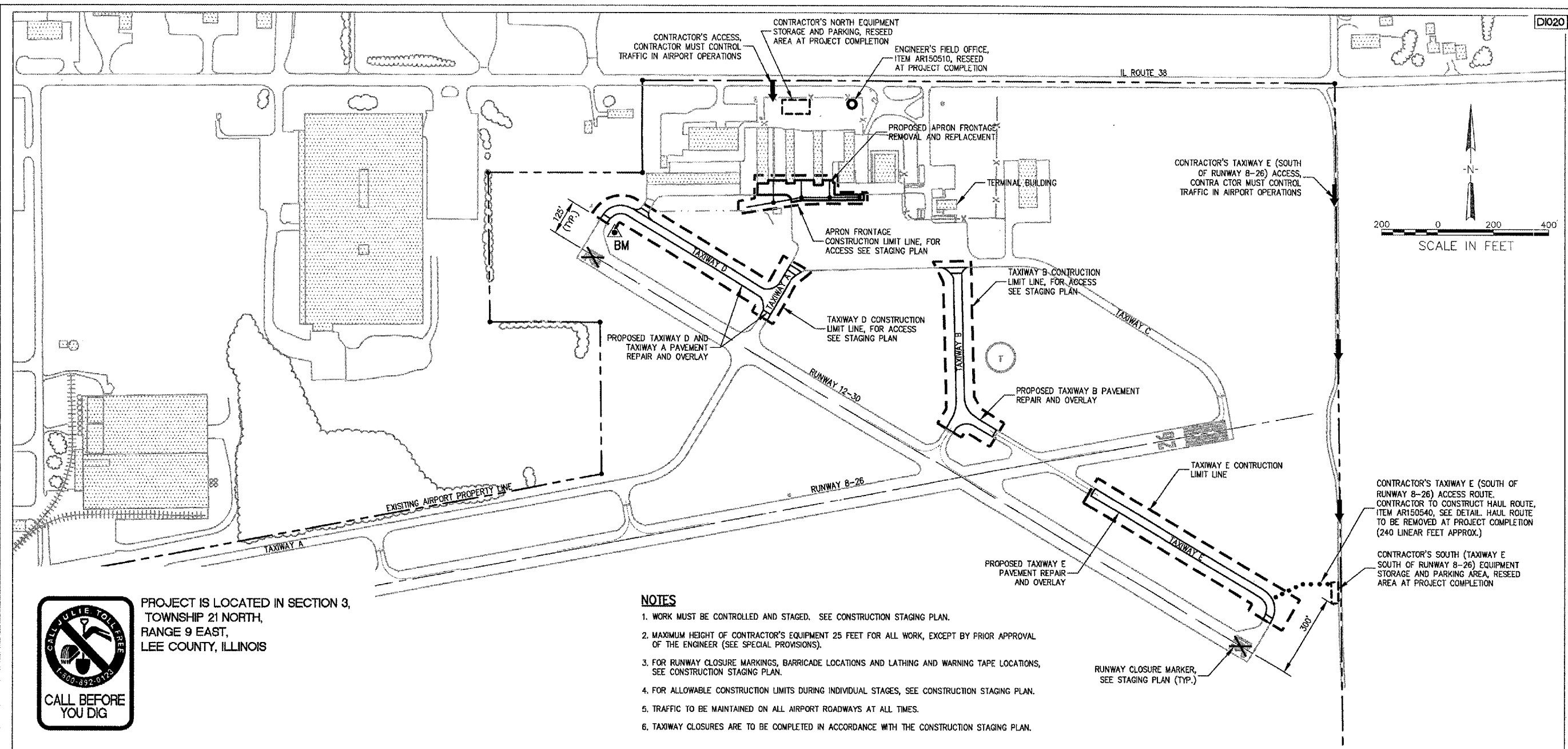

- NOTES**
1. WORK MUST BE CONTROLLED AND STAGED. SEE CONSTRUCTION STAGING PLAN.
 2. MAXIMUM HEIGHT OF CONTRACTOR'S EQUIPMENT 25 FEET FOR ALL WORK, EXCEPT BY PRIOR APPROVAL OF THE ENGINEER (SEE SPECIAL PROVISIONS).
 3. FOR RUNWAY CLOSURE MARKINGS, BARRICADE LOCATIONS AND LATHING AND WARNING TAPE LOCATIONS, SEE CONSTRUCTION STAGING PLAN.
 4. FOR ALLOWABLE CONSTRUCTION LIMITS DURING INDIVIDUAL STAGES, SEE CONSTRUCTION STAGING PLAN.
 5. TRAFFIC TO BE MAINTAINED ON ALL AIRPORT ROADWAYS AT ALL TIMES.
 6. TAXIWAY CLOSURES ARE TO BE COMPLETED IN ACCORDANCE WITH THE CONSTRUCTION STAGING PLAN.



PROJECT IS LOCATED IN SECTION 3,
TOWNSHIP 21 NORTH,
RANGE 9 EAST,
LEE COUNTY, ILLINOIS

GENERAL NOTES

- PROJECT DESCRIPTION**
- THIS PROJECT IS TO REPAIR AND OVERLAY TAXIWAYS B, D AND E AND REMOVE AND REPLACE APRON FRONTAGE PAVEMENTS AT DIXON MUNICIPAL AIRPORT, INCLUDING, AMONG OTHER INCIDENTAL WORK, THE FOLLOWING ITEMS:
- REPAIR AND OVERLAY TAXIWAYS B, D AND E**
- PATCHING OF PORTIONS OF EXISTING BITUMINOUS TAXIWAY PAVEMENTS.
 - CONSTRUCTION OF A BITUMINOUS OVERLAY OF TAXIWAYS B, D AND E AND PORTIONS OF TAXIWAY A.
 - CONSTRUCTION OF BITUMINOUS PAVEMENT TAPERS AND TRANSITIONS.
 - REGRADING OF EXISTING PAVEMENT SHOULDERS.
 - REMARKING OF OVERLAID PAVEMENTS AND ADDITION OF RETROREFLECTIVE TAXIWAY EDGE MARKERS.
 - TOPSOILING AND SEEDING AND MULCHING.
- REMOVE AND REPLACE APRON FRONTAGE PAVEMENTS**
- BITUMINOUS PAVEMENT REMOVAL.
 - UNCLASSIFIED EXCAVATION.
 - CONSTRUCTION OF PROPOSED BITUMINOUS PAVEMENT SECTION INCLUDING DRAINAGE LAYER AND AGGREGATE BASE.
 - INSTALLATION OF STORM SEWER AND UNDERDRAINS.
 - REGRADING OF EXISTING SWALES.
 - TOPSOILING AND SEEDING AND MULCHING.

PROTECTION OF EXISTING AIRPORT FACILITIES

THE CONTRACTOR IS TO BE RESPONSIBLE FOR THE PROTECTION OF EXISTING UNDERGROUND AND OVERHEAD UTILITIES AND LIGHTING EQUIPMENT; DRIVEWAY AND ROAD PAVEMENT AND SHOULDERS; RUNWAY, TAXIWAY AND APRON PAVEMENTS AND SHOULDERS; RUNWAY, TAXIWAY AND AIRPORT LIGHTING EQUIPMENT; AND SEEDED AND TURPED AREAS THAT ARE UTILIZED IN OR AFFECTED BY THE CONTRACTOR'S ACTIVITIES. ITEMS DAMAGED BY THE CONTRACTOR ARE TO BE REPAIRED AT CONTRACTOR'S EXPENSE AND TO THE SATISFACTION OF THE AIRPORT OWNER AND THE RESIDENT ENGINEER.

IN ADDITION WHEN CONDITIONS DICTATE OR AS DETERMINED BY THE AIRPORT OWNER OR THE RESIDENT ENGINEER, THE CONTRACTOR SHALL BE REQUIRED TO USE A PICK-UP TYPE SWEEPER IN ALL ACTIVE CONSTRUCTION AIRFIELD PAVEMENT AREAS AND ROADS USED AS HAUL ROUTES. THE CONTRACTOR WILL BE REQUIRED TO HAVE A SWEEPER AVAILABLE FOR USE AT ALL TIMES. THE COST OF SWEEPING SHALL BE CONSIDERED INCIDENTAL TO THE CONTRACT.

CONTRACTOR'S ACCESS AND TEMPORARY FACILITIES

CONTRACTOR'S ACCESS TO THE PROJECT WHEN ON AIRPORT PROPERTY IS SHOWN ON THIS SHEET. CONTRACTOR'S ACCESS TO THE AIRPORT ITSELF IS TO BE PROVIDED BY PUBLIC RIGHTS-OF-WAY. THE CONTRACTOR IS TO SECURE ALL NECESSARY PERMITS FOR THE USE OF ANY PUBLIC RIGHTS-OF-WAY AND IS TO MAINTAIN TRAFFIC ON THESE PUBLIC ROADS AT ALL TIMES, WITH THE COSTS OF PERMITTING, CLEANING AND REPAIRING OF PAVEMENT DAMAGED BY CONTRACTOR'S ACTIVITIES INCIDENTAL TO THE CONTRACT. USE OF AND REPAIRS TO ANY PUBLIC FACILITIES ARE TO BE COMPLETED TO THE SATISFACTION OF THE FACILITY'S OWNER.

THE CONTRACTOR IS TO PROVIDE TEMPORARY HAUL ROUTE AT THE LOCATION SHOWN ON THIS SHEET AND AS DETAILED. THE HAUL ROUTE WILL BE PAID UNDER ITEM AR150540. OTHER TEMPORARY CONSTRUCTION ROADS WITHIN THE CONSTRUCTION LIMIT LINES AS MAY BE REQUIRED BY HIS ACTIVITIES AT HIS OWN EXPENSE AND DISCRETION, SUBJECT TO THE APPROVAL OF THE RESIDENT ENGINEER. HEAVY VEHICLES SHALL NOT CROSS EXISTING OR NEW PAVEMENT SURFACES EXCEPT AS APPROVED BY THE AIRPORT OWNER AND THE RESIDENT ENGINEER. ANY DAMAGE TO PAVEMENTS THAT MAY OCCUR BY THE CONTRACTOR'S ACTIVITIES SHALL BE REPAIRED AT THE CONTRACTOR'S EXPENSE AND TO THE SATISFACTION OF THE AIRPORT OWNER AND THE RESIDENT ENGINEER.

THE CONTRACTOR IS TO PROVIDE CONTRACTOR'S EQUIPMENT STORAGE AND PARKING AREAS AT THE LOCATIONS SHOWN ON THIS SHEET. THE CONTRACTOR WILL BE UTILIZING AN EXISTING GATED ENTRANCE ON THE AIRPORT. IT IS THE CONTRACTOR'S RESPONSIBILITY TO MAINTAIN THE CONSTRUCTION ENTRANCE AND ACCESS, ROADS AND THE STORAGE AREA DURING CONSTRUCTION AND TO RESTORE THE AREAS AT PROJECT COMPLETION TO CONDITIONS SUITABLE TO THE AIRPORT OWNER AND THE RESIDENT ENGINEER. AT THE AIRPORT OWNER'S DISCRETION, THE TEMPORARY FACILITIES MAY REMAIN, BUT THEY MUST BE LEFT IN CONDITIONS SUITABLE TO THE AIRPORT OWNER. THE COST OF PROVIDING, MAINTAINING AND RESTORING THE TEMPORARY FACILITIES IS INCIDENTAL TO THE CONTRACT.

RESPONSIBILITY FOR EXISTING UTILITIES

THE LOCATION, SIZE AND/OR TYPE OF MATERIAL OF EXISTING UNDERGROUND OR OVERHEAD UTILITIES AS MAY BE INDICATED ON THESE CONSTRUCTION PLANS IS NOT REPRESENTED AS BEING ACCURATE, SUFFICIENT OR COMPLETE. NEITHER THE OWNER NOR THE PROJECT ENGINEER HAVE INDEPENDENTLY VERIFIED THIS INFORMATION AND NEITHER ASSUMES ANY RESPONSIBILITY WHATSOEVER IN RESPECT TO THE ACCURACY, SUFFICIENCY OR COMPLETENESS OF THE INFORMATION AND GIVE NO EXPRESSED OR IMPLIED GUARANTEE THAT ANY CONDITIONS INDICATED ARE REPRESENTATIVE OF ACTUAL CONDITIONS TO BE ENCOUNTERED.

IT SHALL BE THE CONTRACTOR'S RESPONSIBILITY TO DETERMINE THE ACTUAL LOCATION OF ALL SUCH FACILITIES, INCLUDING SERVICE CONNECTIONS TO UNDERGROUND UTILITIES. PRIOR TO CONSTRUCTION, THE CONTRACTOR SHALL NOTIFY ALL UTILITY COMPANIES AND AGENCIES OF HIS CONSTRUCTION PLANS AND SHALL OBTAIN FROM EACH PARTY DETAILED INFORMATION AND ASSISTANCE RELATIVE TO THE LOCATION OF ALL UTILITIES AND THE WORKING SCHEDULE OF ANY REMOVALS OR ADJUSTMENTS REQUIRED OF THE UTILITY. THE CONTRACTOR SHALL CONTACT J.U.L.L.E. (PHONE 800-892-0123) TO ASSIST IN THE ABOVE.

THE CONTRACTOR SHALL PROTECT ANY FACILITIES TO THE SATISFACTION OF THE UTILITY OR OWNING-AGENCY WITH THE COST OF ANY REQUIRED PROTECTION TO BE INCIDENTAL TO THE CONTRACT. IN THE EVENT A UTILITY LINE OR SERVICE IS UNEXPECTEDLY ENCOUNTERED DURING CONSTRUCTION, THE CONTRACTOR SHALL IMMEDIATELY NOTIFY THE RESIDENT ENGINEER AND THE UTILITY COMPANY OR AGENCY OF JURISDICTION, ANY SUCH UTILITIES DISTURBED BY THE CONTRACTOR'S OPERATIONS SHALL BE RESTORED TO SERVICE AT ONCE.

EXISTING BENCHMARK

BENCHMARK IS AS FOLLOWS:

ELEVATION: 772.78 (NAVD 88)
CUT SQUARE ON RIM OF INLET NEAR WEST END OF RUNWAY 12 NORTH OF CENTERLINE.
COORDINATES OF INLET (STATE-PLANE ILLINOIS-WEST COORDINATES, NAD 83): N: 1883684.499 E: 2492285.44

OTHER TEMPORARY BENCHMARKS ARE LOCATED ON-FIELD BUT THEIR USE MUST BE FIELD-VERIFIED.

No.	Drawing Issue Description	Date	By

Date: 11 MARCH 2005
Sheet Title:

SITE PLAN AND GENERAL NOTES

843-04B8007
Project Number
KLK 02/03/05
Date
KLK, TMM 02/03/05
Designed By Date
RMH 03/11/05
Reviewed By Date
KLK
Drawn By

I:\04\005\0084\3\04B8007\DRAWINGS\SHEETS\03-SITE PLAN.DWG MAR 22, 2005 9:20AM KLK