

F.A.U. RTE.	SECTION	COUNTY	TOTAL SHEETS	SHEET NO.
266I	00-00095+BR	LAKE	28	5
ALIGNMENT, TIE AND BENCHMARK PLAN				
C-9-169-00		ILLINOIS		CONTRACT NO.: 83789

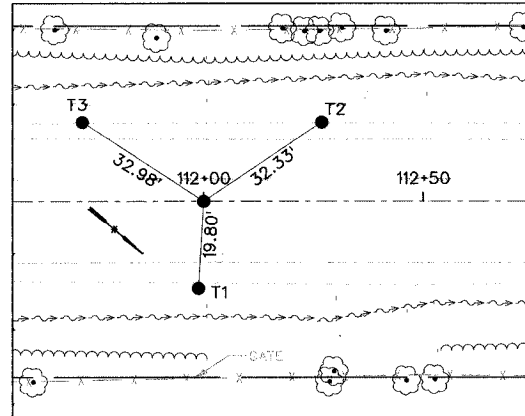

P.O.T. STA.	NORTHING	EASTING	ELEVATION	DESCRIPTION
112+00	4633.86	5033.09		PK NAIL
TIE				
T1	4633.63	5052.90	686.01	SPIKE
T2	4659.83	5013.84		SPIKE
T3	4605.37	5016.49		SPIKE

SCALE 1" = 20'

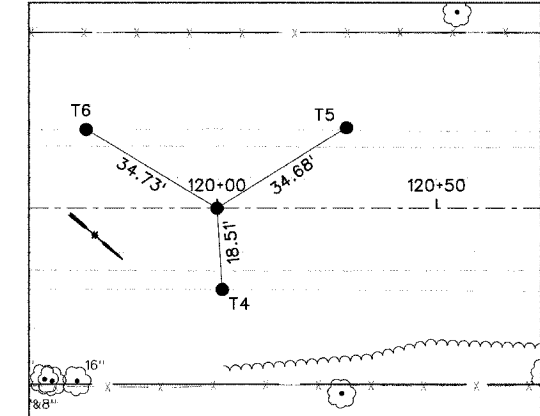

P.O.T. STA.	NORTHING	EASTING	ELEVATION	DESCRIPTION
120+00	5432.92	4994.42		PK NAIL
TIE				
T4	5435.01	5012.81	682.63	SPIKE
T5	5461.50	4974.75		SPIKE
T6	5402.31	4978.04		SPIKE

SCALE 1" = 20'

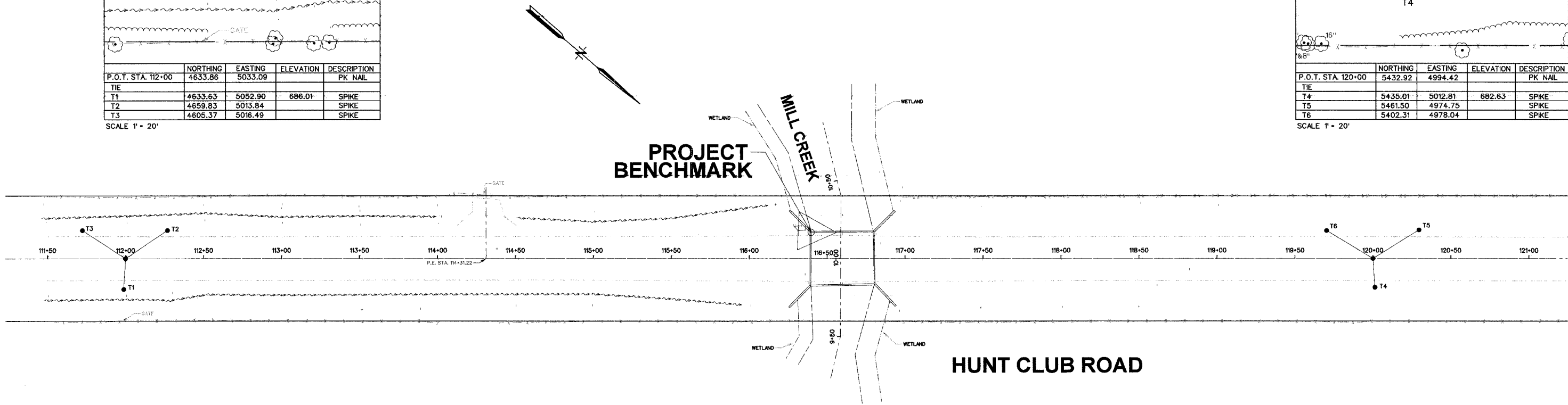

**PROJECT BENCHMARK**

**HUNT CLUB ROAD**

**CONTROL / BENCHMARK DATA**

PROJECT BENCHMARK CHISLED "□" ON RIGHT UPSTREAM WINGWALL STA 116+39.7, 17' LT EL. 686.12

REVISIONS	
NAME	DATE
MCCLURE ENGINEERING	02/03/09

ILLINOIS DEPARTMENT OF TRANSPORTATION

**ALIGNMENT, TIE AND BENCHMARK PLAN**

SCALE: VERT. 1" = 30'  
HORIZ. 1" = 30'

DATE \_\_\_\_\_ DRAWN BY AJP  
CHECKED BY CRF