

steffermk
 10/26/2004
 c:\projects\74048\d02904pa.dgn

FAP NO.	SECTION	COUNTY	TOTAL SHEETS	SHEET NO.
821		JEFFERSON	//	9

CONTRACT NO. 74048
 (13-2)RS-2,13ZRS-3

CURVE DATA
 P.I. STA= 590+73.24
 Δ = 12° 32' 00.00" LT
 D= 1° 59' 60.00"
 R= 2,864.79
 T= 314.59
 L= 626.67
 E= 17.22
 S.E.=
 P.C. STA= 587+58.65
 P.T. STA= 593+85.32

CURVE DATA
 P.I. STA= 590+73.24
 Δ = 12° 32' 00.00" LT
 D= 1° 59' 60.00"
 R= 2,864.79
 T= 314.59
 L= 626.67
 E= 17.22
 S.E.=
 P.C. STA= 587+58.65
 P.T. STA= 593+85.32

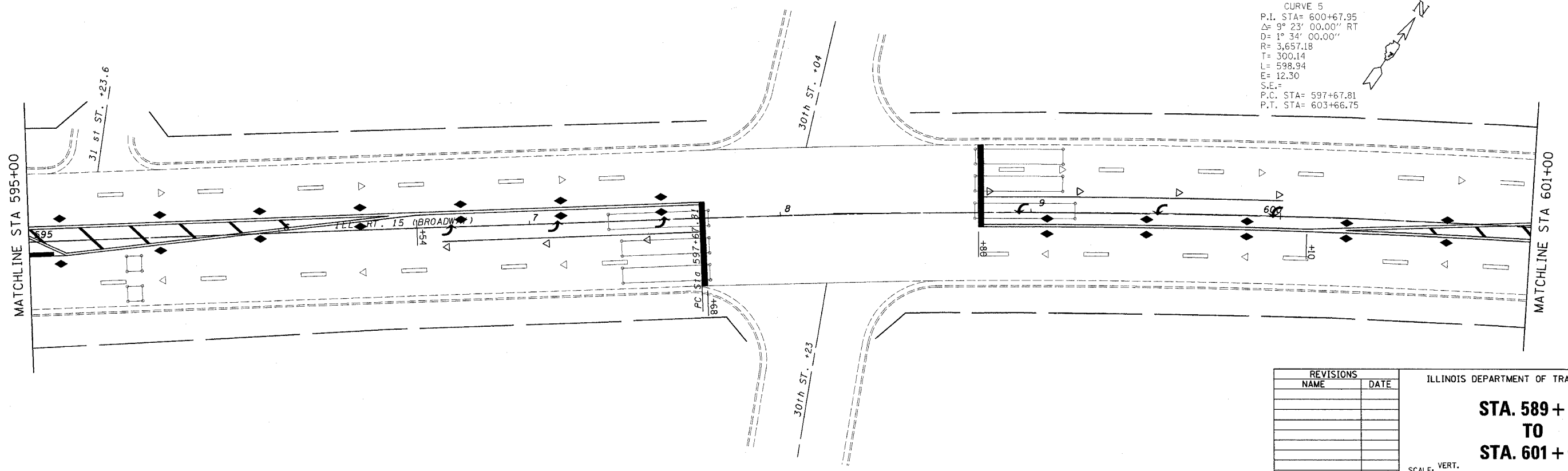
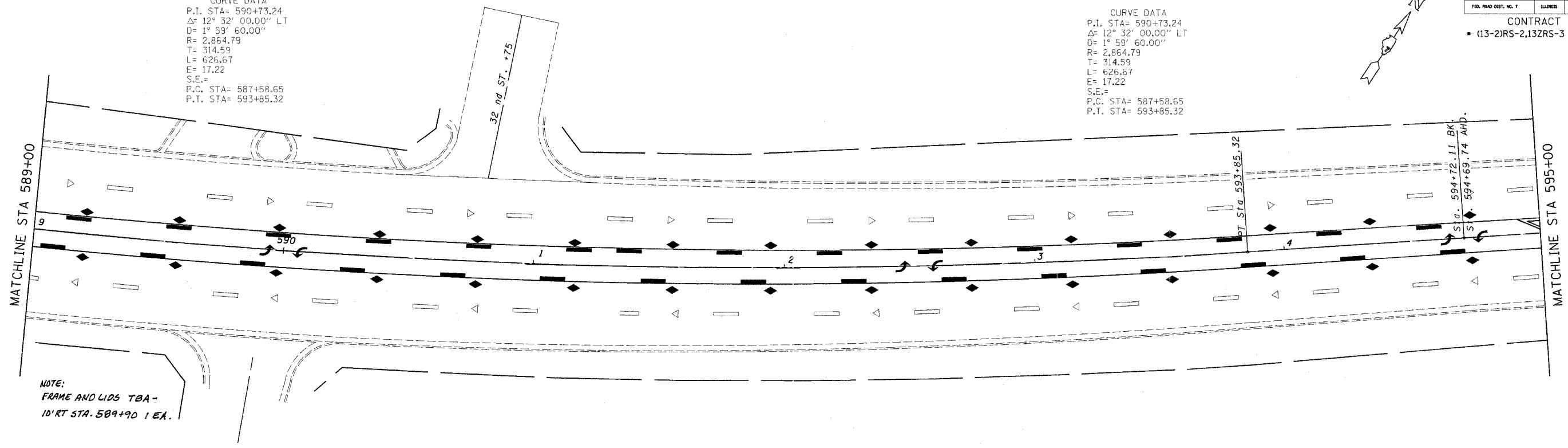

CURVE 5
 P.I. STA= 600+67.95
 Δ = 9° 23' 00.00" RT
 D= 1° 34' 00.00"
 R= 3,657.18
 T= 300.14
 L= 598.94
 E= 12.30
 S.E.=
 P.C. STA= 597+67.81
 P.T. STA= 603+66.75

REVISIONS	
NAME	DATE

ILLINOIS DEPARTMENT OF TRANSPORTATION
STA. 589 + 00
TO
STA. 601 + 00
 SCALE: VERT. DATE
 HORIZ. DATE
 DRAWN BY
 CHECKED BY