

72938

F.A.P. RTE.	SECTION	COUNTY	TOTAL SHEETS	SHEET NO.
714	134B	CHRISTIAN	23	7
STA. 431+92 TO STA. 432+72				
FED. ROAD DIST. NO. 1 ILLINOIS FED. AID PROJECT				

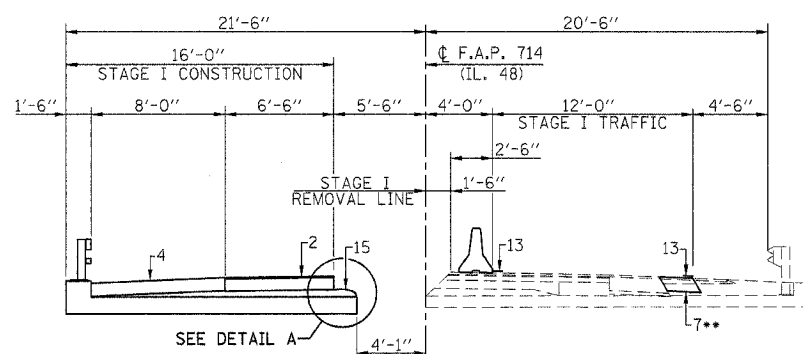

STAGE I TRAFFIC OVER CULVERT ***
(LOOKING EAST)

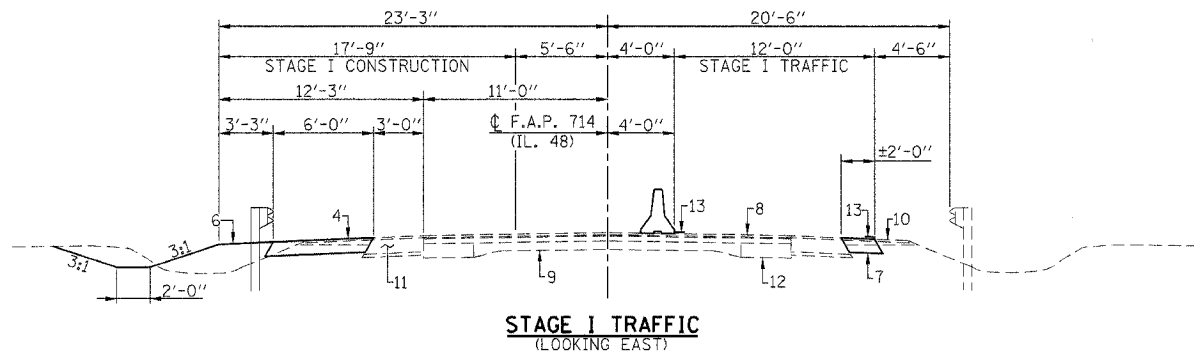
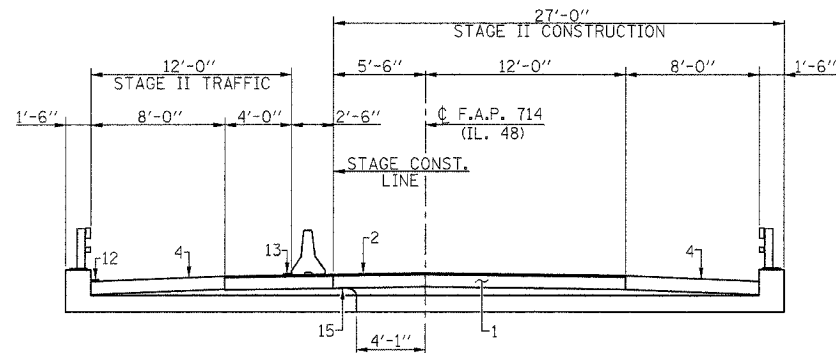
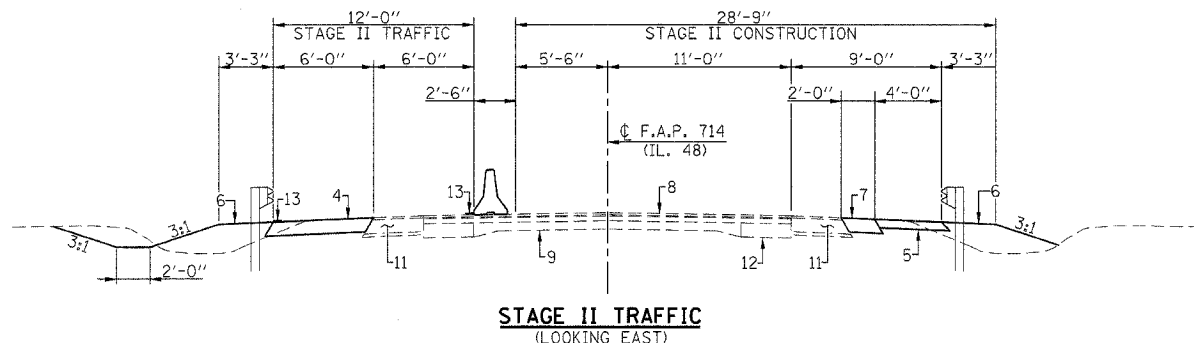

STAGE II TRAFFIC OVER CULVERT ***
(LOOKING EAST)

* TO BE PLACED AFTER BOTH STAGES HAVE BEEN COMPLETED.

** TO BE REMOVED AND INCLUDED IN THE COST OF "PAVEMENT REMOVAL".

*** GEOTECHNICAL FABRIC TO BE PLACED UNDERNEATH P.C.C. BASE COURSE AND PAVEMENT FABRIC TO BE PLACED WITHIN P.C.C. BASE COURSE FROM STA. 432+11 TO STA. 432+53 (SEE STD. 420701) (COST OF GEOTECHNICAL FABRIC TO BE INCLUDED IN GRANULAR CULVERT BACKFILL AND COST OF PAVEMENT FABRIC INCLUDED IN P.C.C. BASE COURSE).
ESTIMATED QUANTITY - 112 SQ. YD. FOR BOTH GEOTECHNICAL AND PAVEMENT FABRIC.

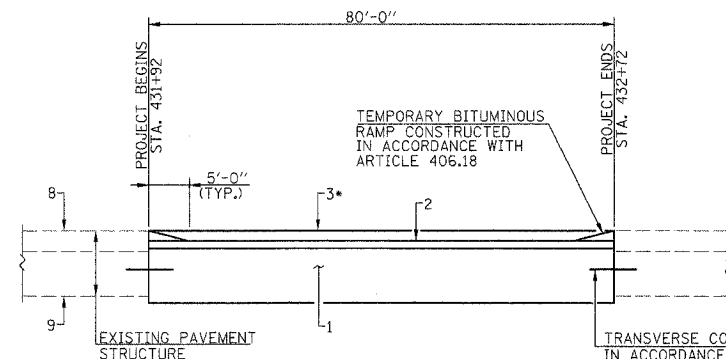

TEMPORARY RAMP DETAIL

TRANSVERSE CONSTRUCTION JOINT IN ACCORDANCE WITH ARTICLE 353.07, NO. 6 TIE BAR, 36" LONG AT 15" CENTERS. COST INCLUDED IN P.C.C. BASE COURSE SEE DETAIL B

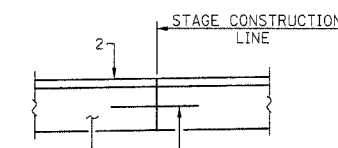

LONGITUDINAL CONSTRUCTION JOINT IN ACCORDANCE WITH ARTICLE 420.10(b), NO. 6 TIE BAR, 30" LONG AT 30" CENTERS. COST INCLUDED IN P.C.C. BASE COURSE

DETAIL B

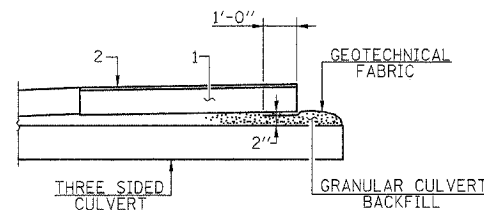

DETAIL A

PAVEMENT LEGEND

1. PROPOSED PORTLAND CEMENT CONCRETE BASE COURSE 9"
2. PROPOSED LEVELING BINDER (MACHINE METHOD) SUPERPAVE, N50 1"
3. PROPOSED BITUMINOUS CONCRETE SURFACE COURSE SUPERPAVE, MIXTURE C, N 50 1/2"
4. PROPOSED BITUMINOUS BASE COURSE SUPERPAVE 10"
5. PROPOSED AGGREGATE SHOULDER (6")
6. PROPOSED EARTH SHOULDER
7. BITUMINOUS CONCRETE BASE COURSE WIDENING, SUPERPAVE, 10" (TO REMAIN IN PLACE)
8. EXISTING BITUMINOUS OVERLAYS ($\pm 4"$)
9. EXISTING P.C.C. PAVEMENT (9-6-9)
10. EXISTING AGGREGATE SHOULDER ($\pm 4"$)
11. EXISTING BITUMINOUS SHOULDER
12. EXISTING P.C.C. WIDENING
13. TEMPORARY PAVEMENT MARKING - LINE 5"
14. PAINT PAVEMENT MARKING - LINE 5"
15. GEOTECHNICAL FABRIC AND GRANULAR CULVERT BACKFILL

WORK THIS SHEET WITH SHEETS 8,9 & 10 OF 23.

**STAGE CONSTRUCTION TRAFFIC DETAILS
IL. ROUTE 48 OVER BUCKHART CREEK
F.A.P. ROUTE 714 - SECTION 134B
CHRISTIAN COUNTY
STA. 432+32
S.N. 011-2505**