

| F.A.I. RTE. | SECTION | COUNTY | TOTAL SHEETS | SHEET NO. |
|-----------------------|-----------------------|---------------------------|--------------|-----------|
| 74 | 00-1R-2903,14,14-1R-1 | TAZEWELL | 1366 | 305 |
| STA. | | TO STA. | | |
| FED. ROAD DIST. NO. 4 | | ILLINOIS FED. AID PROJECT | | |

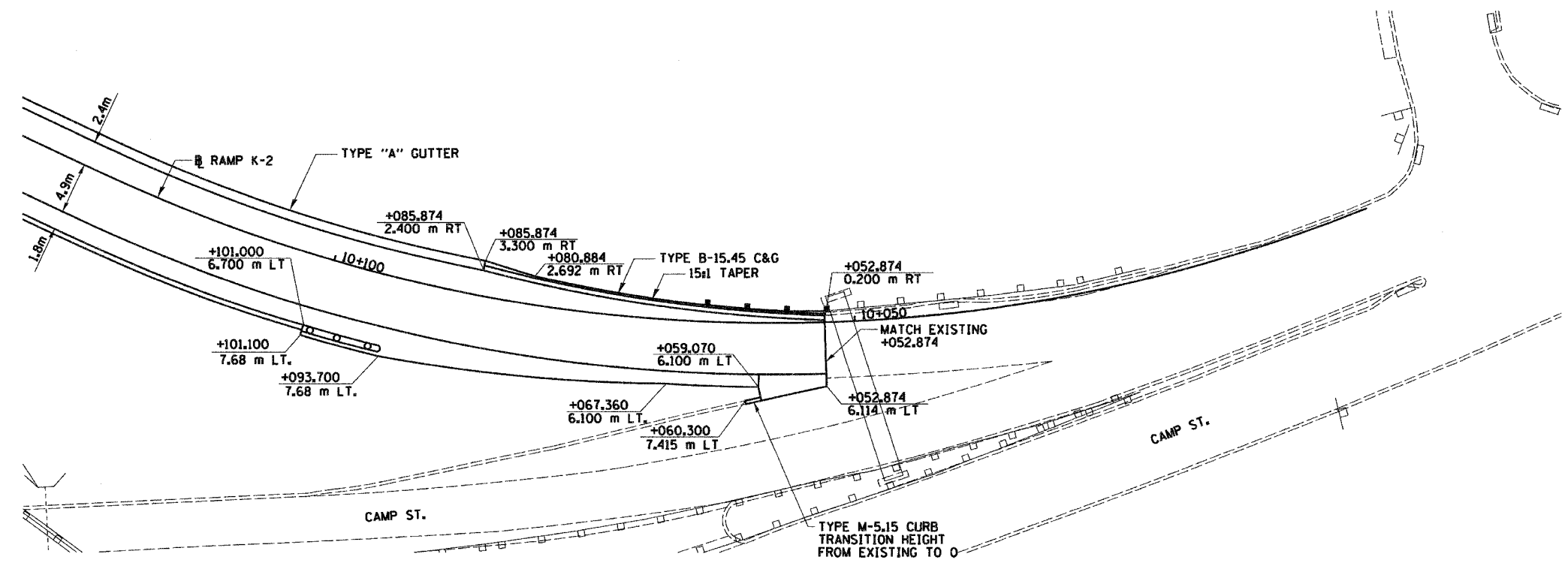

PLAN VIEW
(SHOWING HORIZONTAL CONTROL)

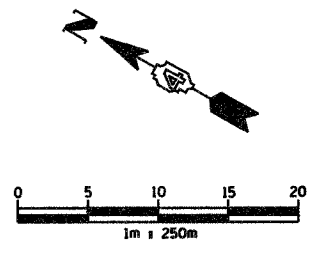
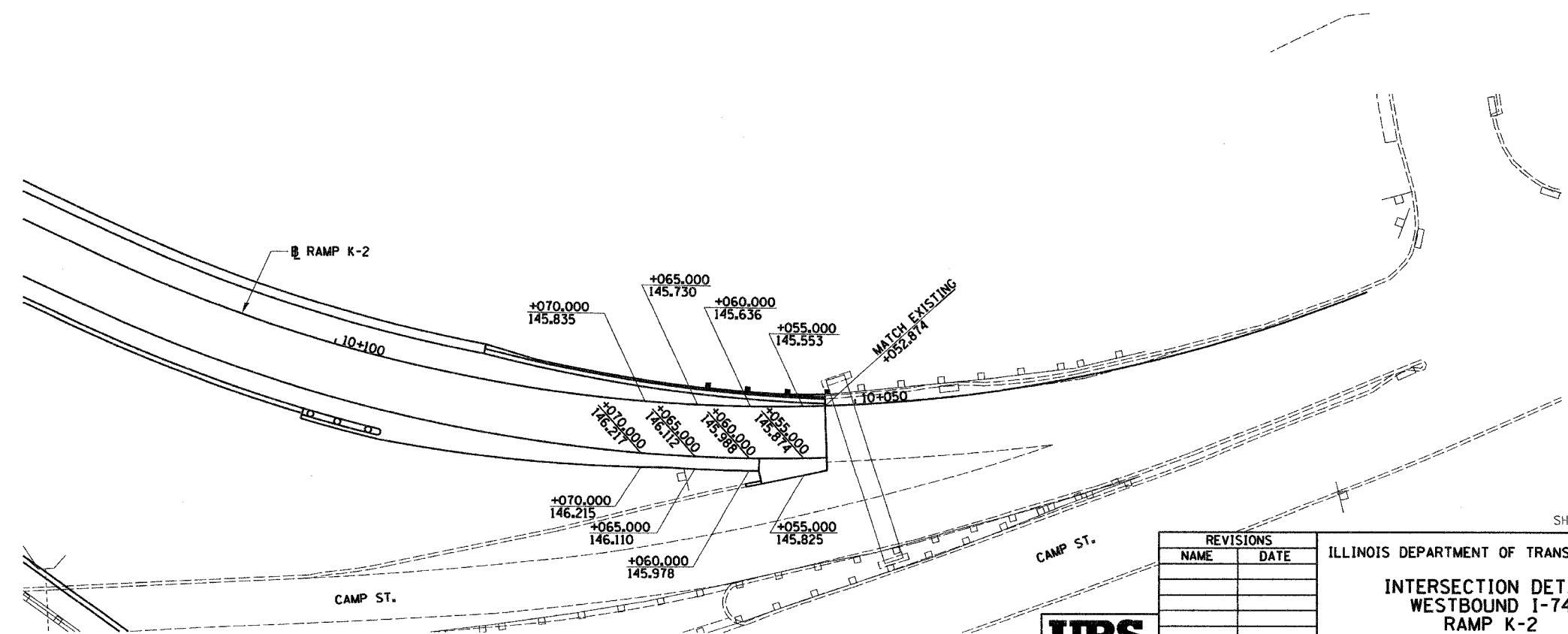

PLAN VIEW
(SHOWING VERTICAL CONTROL)

| REVISIONS | |
|-----------|------|
| NAME | DATE |
| | |
| | |
| | |
| | |
| | |

ILLINOIS DEPARTMENT OF TRANSPORTATION
INTERSECTION DETAIL
WESTBOUND I-74
RAMP K-2
DRAWN BY JEH
CHECKED BY MLB
DATE 12/20/04

