

F.A.I. RTE.	SECTION	COUNTY	TOTAL SHEETS	SHEET NO.
74	(72-7R-3)	PEORIA	1360	1341
STA.	TO STA.			
FED. ROAD DIST. NO.	ILLINOIS FED. AID PROJECT			
68200				

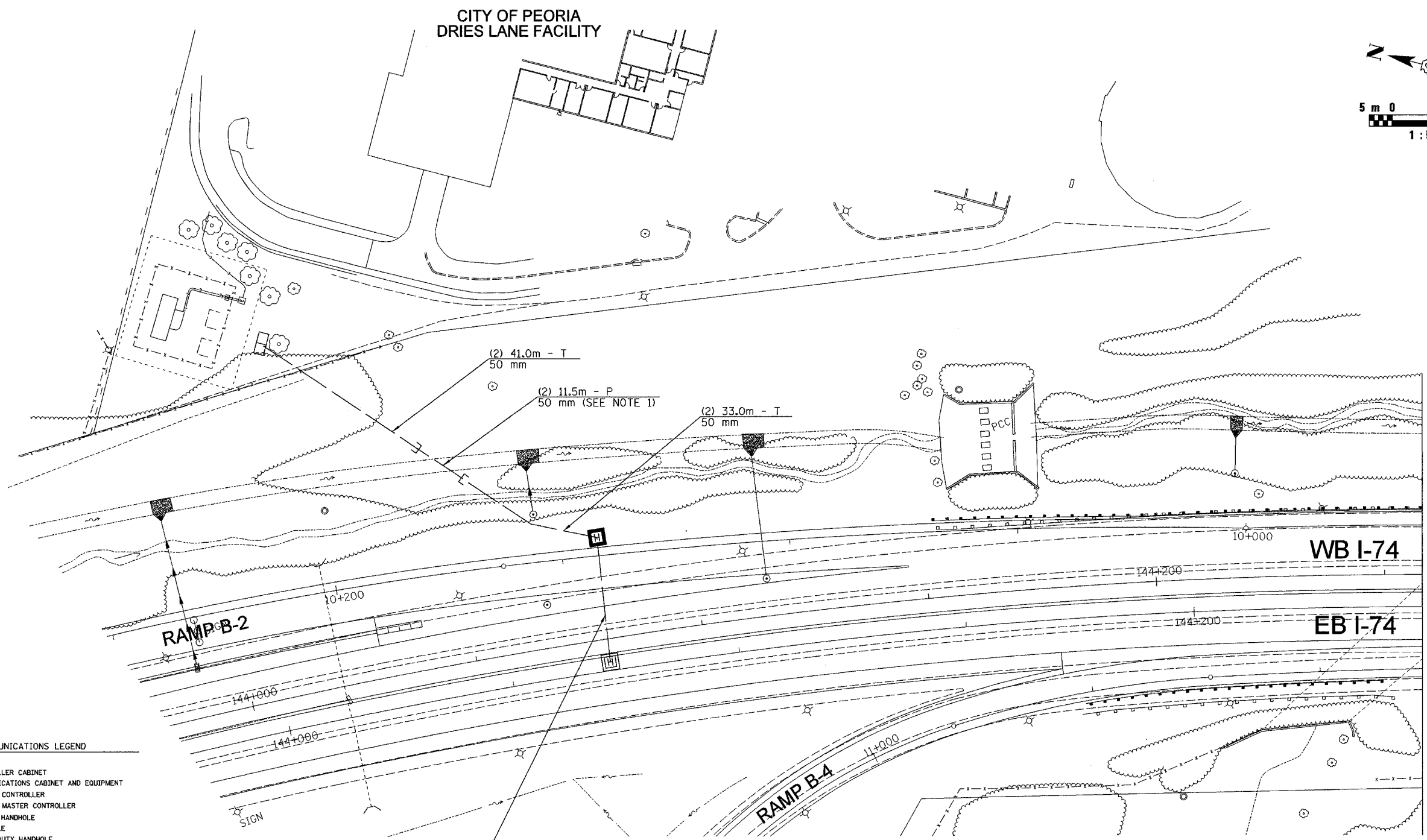
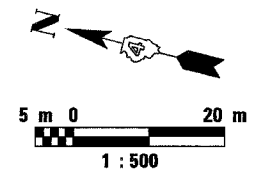

FIBER OPTIC COMMUNICATIONS LEGEND

PROPOSED	EXISTING	DESCRIPTION
[Symbol]	[Symbol]	CONTROLLER CABINET
[Symbol]	[Symbol]	COMMUNICATIONS CABINET AND EQUIPMENT
[Symbol]	[Symbol]	MASTER CONTROLLER
[Symbol]	[Symbol]	MASTER MASTER CONTROLLER
[Symbol]	[Symbol]	DOUBLE HANDHOLE
[Symbol]	[Symbol]	HANDHOLE
[Symbol]	[Symbol]	HEAVY DUTY HANDHOLE
[Symbol]	[Symbol]	COMMUNICATIONS VAULT
[Symbol]	[Symbol]	CONDUIT IN TRENCH OR PUSHED
[Symbol]	[Symbol]	INTERSECTION AND SAMPLING (SYSTEM) DETECTORS
[Symbol]	[Symbol]	PROPOSED FIBER OPTIC BACKBONE CABLE (* DENOTES FIBER COUNT)
[Symbol]	[Symbol]	EXISTING INTERCONNECT CABLE NO. 62.5/125 12F FIBER OPTIC CABLE
[Symbol]	[Symbol]	INTERCONNECT CABLE NO. 19 3 PAIR TWISTED, SHIELDED
[Symbol]	[Symbol]	LOOP DETECTOR CABLE 2/C TWISTED, SHIELDED
[Symbol]	[Symbol]	TRACER CABLE NO. 14 1/C
[Symbol]	[Symbol]	SAMPLING (SYSTEM) DETECTORS
[Symbol]	[Symbol]	EXISTING INTERSECTION DETECTORS AND PROPOSED SAMPLING (SYSTEM) DETECTORS
[Symbol]	[Symbol]	EXISTING SAMPLING (SYSTEM) DETECTORS AND PROPOSED INTERSECTION AND SAMPLING (SYSTEM) DETECTORS
[Symbol]	[Symbol]	TELEPHONE CONNECTION
[Symbol]	[Symbol]	COMMON TRENCH
[Symbol]	[Symbol]	UNIT DUCT
[Symbol]	[Symbol]	INTERSECTION

BILL OF MATERIALS

PAY ITEM	UNIT	QUANTITY
HEAVY DUTY HANDHOLE	EACH	1
CONDUIT IN TRENCH, 50MM DIA., PVC	METER	148.0
CONDUIT PUSHED, 50MM DIA., PVC	METER	78.0
TRENCH AND BACKFILL FOR ELECTRICAL WORK	METER	74.0

NOTE:
 1. CONTRACTOR SHALL CONFIRM FINAL LOCATION OF RELOCATED DRAINAGE CHANNEL BEFORE INSTALLING PUSHED CONDUIT.



REVISIONS

NAME	DATE

ITS SHEET 10 OF 13

ILLINOIS DEPARTMENT OF TRANSPORTATION
 ITS PLAN

FIBER OPTIC COMMUNICATIONS
 SYSTEM LAYOUT I-74 FROM
 DRIES LANE TO STA 144+250

SCALE: _____ DRAWN BY MJL
 DATE 11/02/04 CHECKED BY JEZ

PRINTED 11/05/2004

c:\01001301\1\its final design\cond\wk files\contract 10\app\004-7.dgn