

STATE OF ILLINOIS
DEPARTMENT OF TRANSPORTATION

ROUTE No.	SECTION	COUNTY	TOTAL SHEETS	SHEET NO.
FAI 74	*	PEORIA	1300	1303
STA.		TO STA.		
F.H.W.A. REGION		ILLINOIS	PROJECT	
		* (72-7)R-3		
CONTRACT NO. 68200				

Walkway Grating, Walkway Supports, Handrail and Lighting are not included. Information shown on this sheet shall be used for Truss Grating, Sign Brackets and Sign Panel locations only.

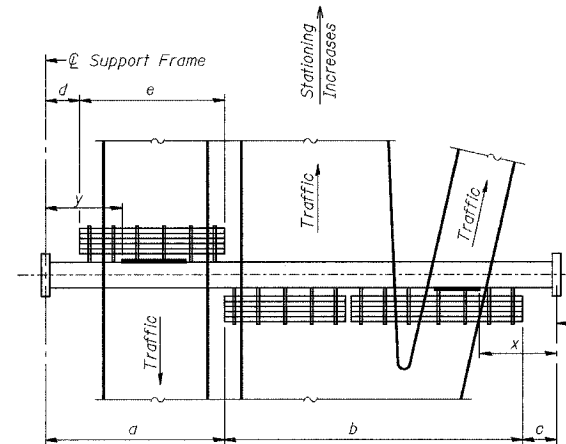

PLAN
WALKWAY AND HANDRAIL SKETCH

(Road plan beneath truss varies)
"x" and "y" are measured along ϕ of truss to edge of nearest sign panel. See Signing Plans for sign panel details and spacing between panels.

BRACKET TABLE

W150x14		Number Brackets Required
Sign Width Greater Than	Less Than or Equal To	
	3.0	2
3.0	4.9	3
4.9	6.7	4
6.7	8.6	5
8.6	10.4	6

Notes: **Space walkway brackets W150x14 for efficiency and within limits shown:

- f = 300 mm maximum, 100 mm minimum (End of sign to ϕ of nearest bracket)
- g = 300 mm maximum, 100 mm minimum (End of walkway grating to ϕ of nearest support bracket)
- h = 1.85 m maximum (ϕ to ϕ sign and/or walkway support brackets, W150x14)
- k = 50 mm maximum gap between adjacent walkway grating sections and handrail ends

***If walkway bracket at safety chain location is behind sign, add angle to bracket, see Alternate Safety Chain Attachment on Base Sheet OS-S-11(M).

For Details T and W, Section B-B and Grating Splice Details, see Base Sheet OS-S-10(M).
For Details D, F, G and P and Handrail Splice Details, see Base Sheet OS-S-11(M).

DESIGNED	RJW
CHECKED	KJN
DRAWN	RJW
CHECKED	KJN

EXAMINED	2884
PASSED	ENGINEER OF STRUCTURAL SERVICES
	ENGINEER OF BRIDGES AND STRUCTURES

NUMBER	REVISION	DATE

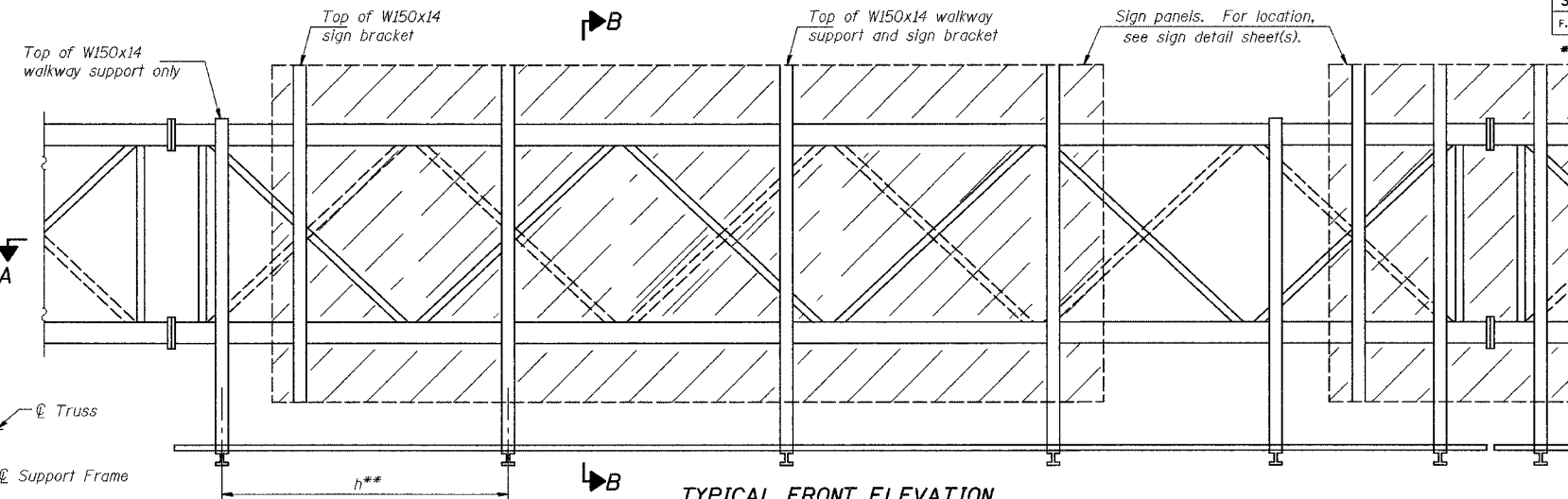

TYPICAL FRONT ELEVATION
With lights and handrail omitted for clarity.
For Section B-B, see Base Sheet OS-S-10(M).

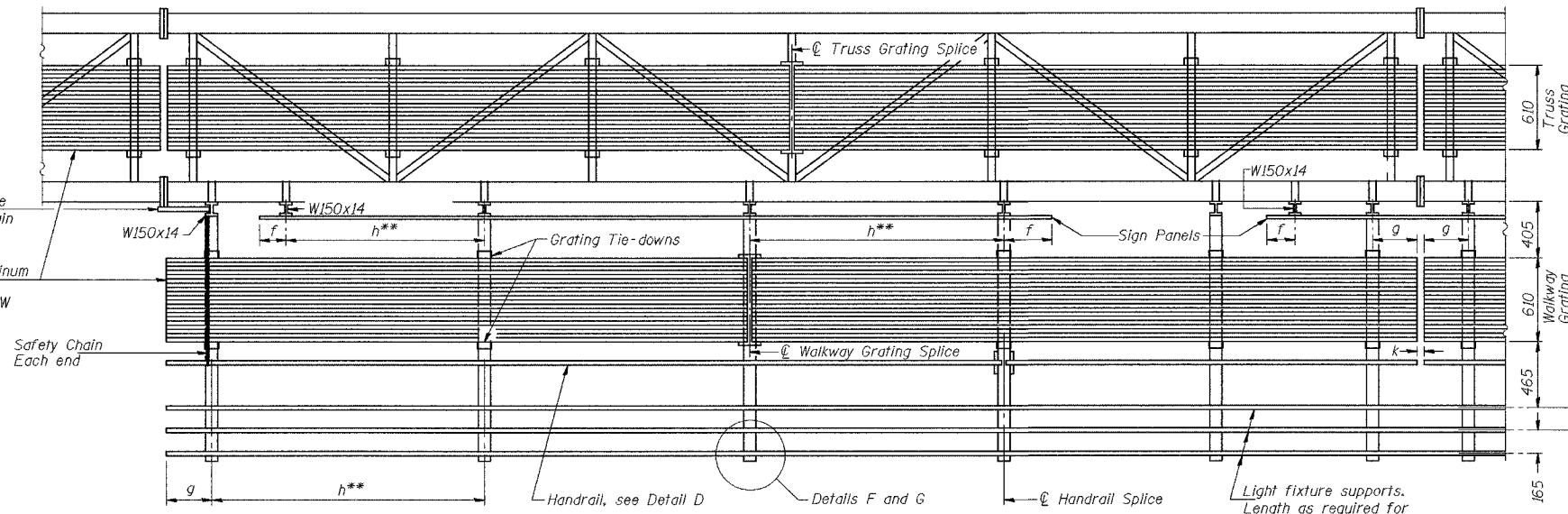

SECTION A-A

Handrail and walkway shall span a minimum of three brackets between splices and/or gap joints. Place all sign and walkway brackets as close to panel points as practical. Grating, handrail and light support splices placed as needed.

Walkway and Truss Grating width dimensions are nominal and may vary ± 13 mm based on available standard widths.

Truss grating to facilitate inspection shall run full length (center to center of support frames) ± 305 mm on overhead trusses. Cost of truss grating is included in "Overhead Sign Structure..."

Structure Number	Station	a (m)	b (m)	c (m)	d (m)	e (m)	x (m)	y (m)	Walkway Grating and Handrail Lengths
4S0721074L089.3	143+798.000							6.944	
4S0721074L089.4	144+154.000							4.774	
4S0721074L089.7	144+540.000							5.091	

1 The outside foundation, end supports, truss and signing are included in this contract. The median foundation was provided in a previous contract.

SIGNING SHEET 55 OF 83

**OVERHEAD SIGN STRUCTURES
STEEL WALKWAY DETAILS**

ILLINOIS DEPARTMENT OF TRANSPORTATION

SIGNING PLAN
W.B. I-74 STA. 143+798, S.N. 4S0721074L089.3
W.B. I-74 STA. 144+154, S.N. 4S0721074L089.4
W.B. I-74 STA. 144+540, S.N. 4S0721074L089.7

PEORIA CO., IL.

DATE: II-II-04

M:\Pro\13573\Sign Structures\Contract 10/sp1001-7Aoh-sfl.dgn

OS-S-9(M) 7/1/2001