

F.A.I. RTE.	SECTION	COUNTY	TOTAL SHEETS	SHEET NO.
74	(72-71R-3)	PEORIA	1360	1482
STA. 146+070.000		TO STA. 146+410.000		
FED. ROAD DIST. NO.	ILLINOIS	FED. AID PROJECT	CONTRACT NO. 68200	

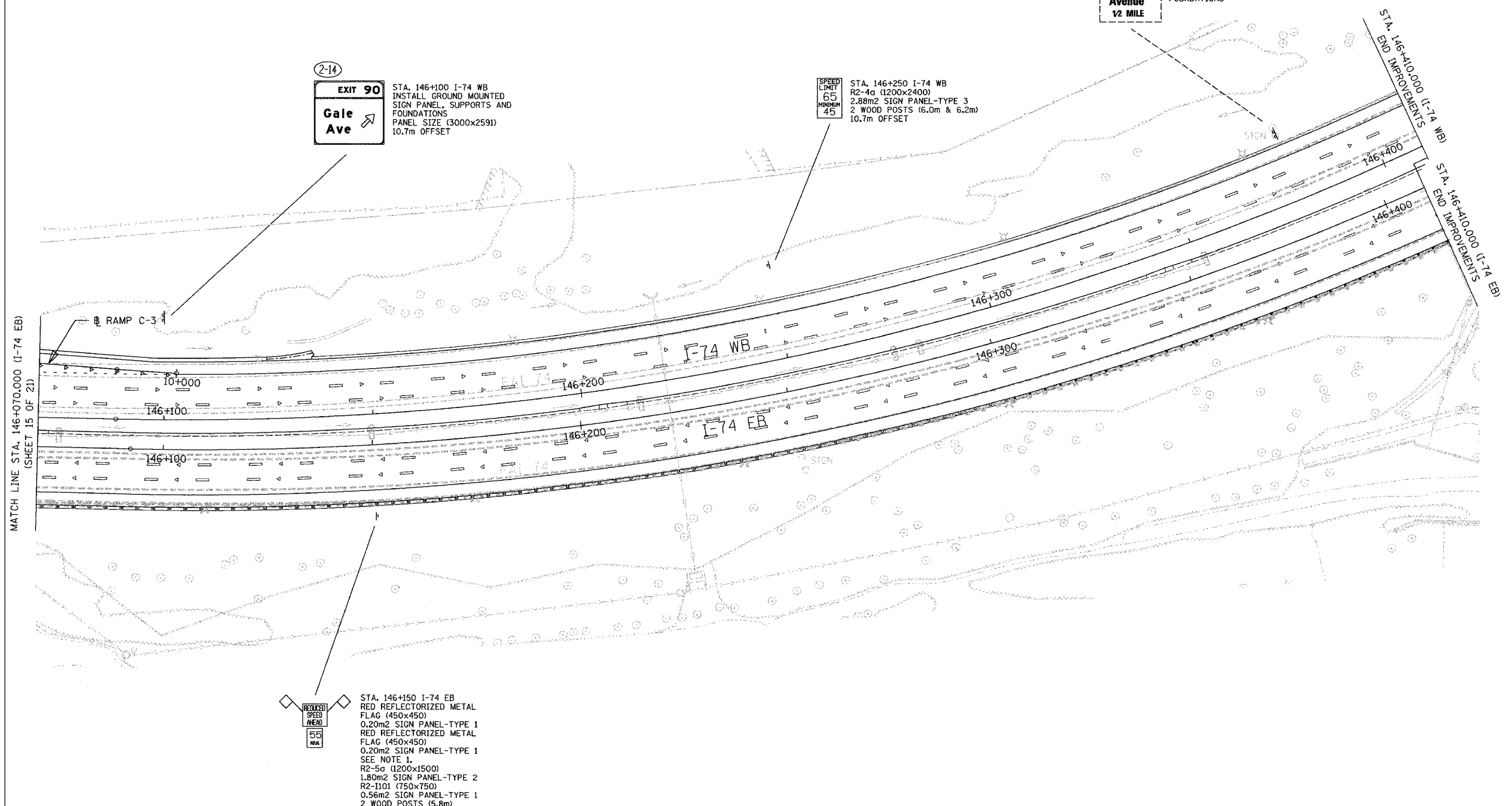

2-14
EXIT 90
Gale Ave ↗

STA. 146+100 I-74 WB
 INSTALL GROUND MOUNTED SIGN PANEL, SUPPORTS AND FOUNDATIONS
 PANEL SIZE (3000x2591)
 10.7m OFFSET

SPEED LIMIT
 65
 MINIMUM
 45

STA. 146+250 I-74 WB
 R2-4c (1200x2400)
 2.80m² SIGN PANEL-TYPE 3
 2 WOOD POSTS (6.0m & 6.2m)
 10.7m OFFSET

EXIT 90
Gale Avenue
 1/2 MILE

REMOVE 2 GROUND MOUNTED SIGN PANELS, SUPPORTS AND FOUNDATIONS

MATCH LINE STA. 146+070.000 (I-74 EB)
 (SHEET 15 OF 21)

REFLECTORIZED SPEED AHEAD
 55
 MAX

STA. 146+150 I-74 EB
 RED REFLECTORIZED METAL FLAG (450x450)
 0.20m² SIGN PANEL-TYPE 1
 RED REFLECTORIZED METAL FLAG (450x450)
 0.20m² SIGN PANEL-TYPE 1
 SEE NOTE 1.
 R2-5a (1200x1500)
 1.80m² SIGN PANEL-TYPE 2
 R2-I101 (750x750)
 0.56m² SIGN PANEL-TYPE 1
 2 WOOD POSTS (5.8m)
 5.0m OFFSET

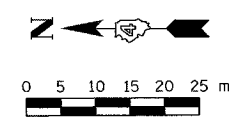

SIGNING SHEET 34 OF 83

NOTE
 1. THE COST OF ALL SUPPORTS AND MOUNTING HARDWARE FOR INSTALLATION OF THE REFLECTORIZED METAL FLAGS IS INCLUDED IN THE COST OF "SIGN PANELS-TYPE 1".

- LEGEND**
- (A) CITY OWNED SIGNS TO BE RETAINED
 - (B) CITY OWNED SIGNS TO BE REMOVED
 - (C) CITY OWNED SIGNS TO BE RELOCATED
 - * BY OTHERS
 - (3-88) NON-STANDARD SIGN NUMBER

REVISIONS	
NAME	DATE

ILLINOIS DEPARTMENT OF TRANSPORTATION
 PROPOSED PAVEMENT MARKING PLAN
 FAI ROUTE 74 (I-74)
 STA. 146+070 TO STA. 146+410
 (SHEET 16 OF 21)
 SCALE 1:500
 DATE 11/13/2004
 DRAWN BY MEG
 CHECKED BY BCG



11/13/2004 11:12:00 AM 10/13/2004 10:10:10 AM 10/13/2004 10:10:10 AM