

| | | | | |
|---------------------|------------|---------------------|--------------|-----------|
| F.A.I. RTE. | SECTION | COUNTY | TOTAL SHEETS | SHEET NO. |
| 74 | (72-71R-3) | PEORIA | 1550 | 208 |
| STA. 141+950.000 | | TO STA. 142+300.000 | | |
| FED. ROAD DIST. NO. | ILLINOIS | FED. AID PROJECT | | |
| CONTRACT NO. 68200 | | | | |

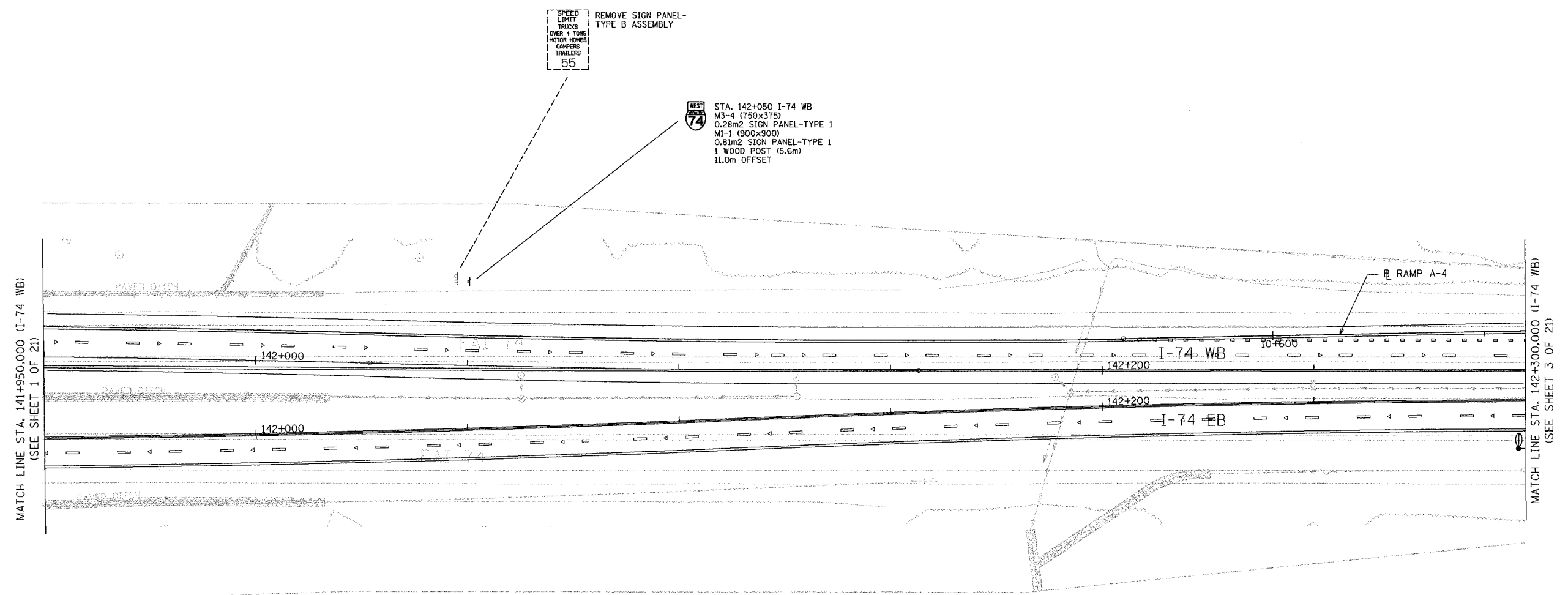

MATCH LINE STA. 141+950.000 (I-74 WB)
(SEE SHEET 1 OF 21)

MATCH LINE STA. 142+300.000 (I-74 WB)
(SEE SHEET 3 OF 21)

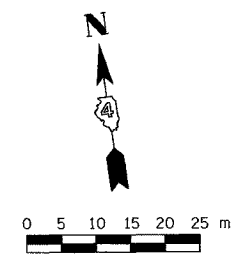

- LEGEND**
- (A) CITY OWNED SIGNS TO BE RETAINED
 - (B) CITY OWNED SIGNS TO BE REMOVED
 - (C) CITY OWNED SIGNS TO BE RELOCATED
 - * BY OTHERS
 - (3-88) NON-STANDARD SIGN NUMBER

| REVISIONS | |
|-----------|------|
| NAME | DATE |
| | |
| | |
| | |
| | |
| | |
| | |
| | |
| | |

ILLINOIS DEPARTMENT OF TRANSPORTATION

SIGNING PLAN
F.A.I. ROUTE 74
STA. 141+950 TO STA. 142+300
(SHEET 2 OF 21)

SCALE 1:500
DATE 11/15/2004

DRAWN BY MEG
CHECKED BY BCG



11/15/2004 11:15:20 AM c:\projects\contract\10\p1052_76.dgn