

F.A.I. RTE.	SECTION	COUNTY	TOTAL SHEETS	SHEET NO.
74	72-7R-3	PEORIA	1360	1161
STA.		TO STA.		
FED. ROAD DIST. NO.		ILLINOIS FED. AID PROJECT		
28	30	32	34	36

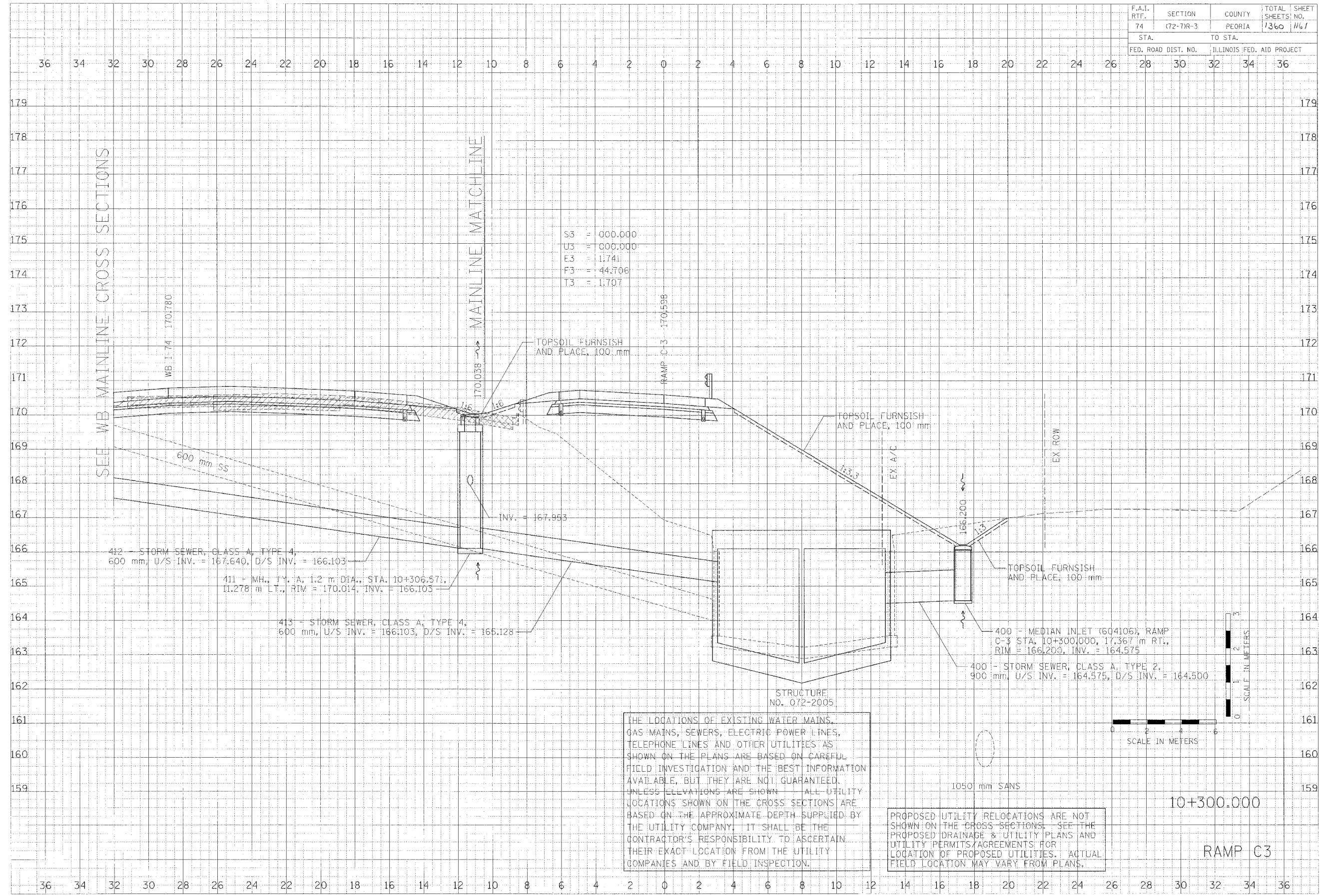

S3 = 000.000
 U3 = 000.000
 E3 = 1.1741
 F3 = 44.706
 T3 = 1.1707

SEE WB MAINLINE CROSS SECTIONS

MAINLINE MATCHLINE

DATE
 BY
 CHECKED
 DESIGNED
 DRAWN
 IN CHARGE
 PROJECT NO.
 SHEET NO.
 DATE
 BY
 CHECKED
 DESIGNED
 DRAWN
 IN CHARGE
 PROJECT NO.
 SHEET NO.
 DATE
 BY
 CHECKED
 DESIGNED
 DRAWN
 IN CHARGE
 PROJECT NO.
 SHEET NO.

CLARK ENGINEERS, INC.

DATE
 BY
 CHECKED
 DESIGNED
 DRAWN
 IN CHARGE
 PROJECT NO.
 SHEET NO.
 DATE
 BY
 CHECKED
 DESIGNED
 DRAWN
 IN CHARGE
 PROJECT NO.
 SHEET NO.

THE LOCATIONS OF EXISTING WATER MAINS, GAS MAINS, SEWERS, ELECTRIC POWER LINES, TELEPHONE LINES AND OTHER UTILITIES AS SHOWN ON THE PLANS ARE BASED ON CAREFUL FIELD INVESTIGATION AND THE BEST INFORMATION AVAILABLE, BUT THEY ARE NOT GUARANTEED. UNLESS ELEVATIONS ARE SHOWN ALL UTILITY LOCATIONS SHOWN ON THE CROSS SECTIONS ARE BASED ON THE APPROXIMATE DEPTH SUPPLIED BY THE UTILITY COMPANY. IT SHALL BE THE CONTRACTOR'S RESPONSIBILITY TO ASCERTAIN THEIR EXACT LOCATION FROM THE UTILITY COMPANIES AND BY FIELD INSPECTION.

PROPOSED UTILITY RELOCATIONS ARE NOT SHOWN ON THE CROSS SECTIONS. SEE THE PROPOSED DRAINAGE & UTILITY PLANS AND UTILITY PERMITS/AGREEMENTS FOR LOCATION OF PROPOSED UTILITIES. ACTUAL FIELD LOCATION MAY VARY FROM PLANS.

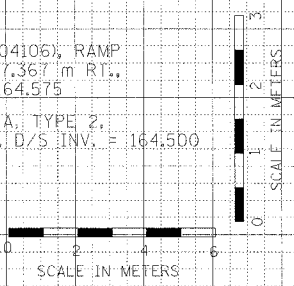

10+300.000

RAMP C3