

F.A.I. RTE. 74	SECTION 172-71R-3	COUNTY PEORIA	TOTAL SHEET NO. 1360	SHEET NO. 1087
STA. FED. ROAD DIST. NO.		TO STA. ILLINOIS FED. AID PROJECT		
14	16	18	20	22

DATE	BY
DATE	BY
DATE	BY
DATE	BY

CLARK ENGINEERS, INC.

DATE	BY
DATE	BY
DATE	BY
DATE	BY

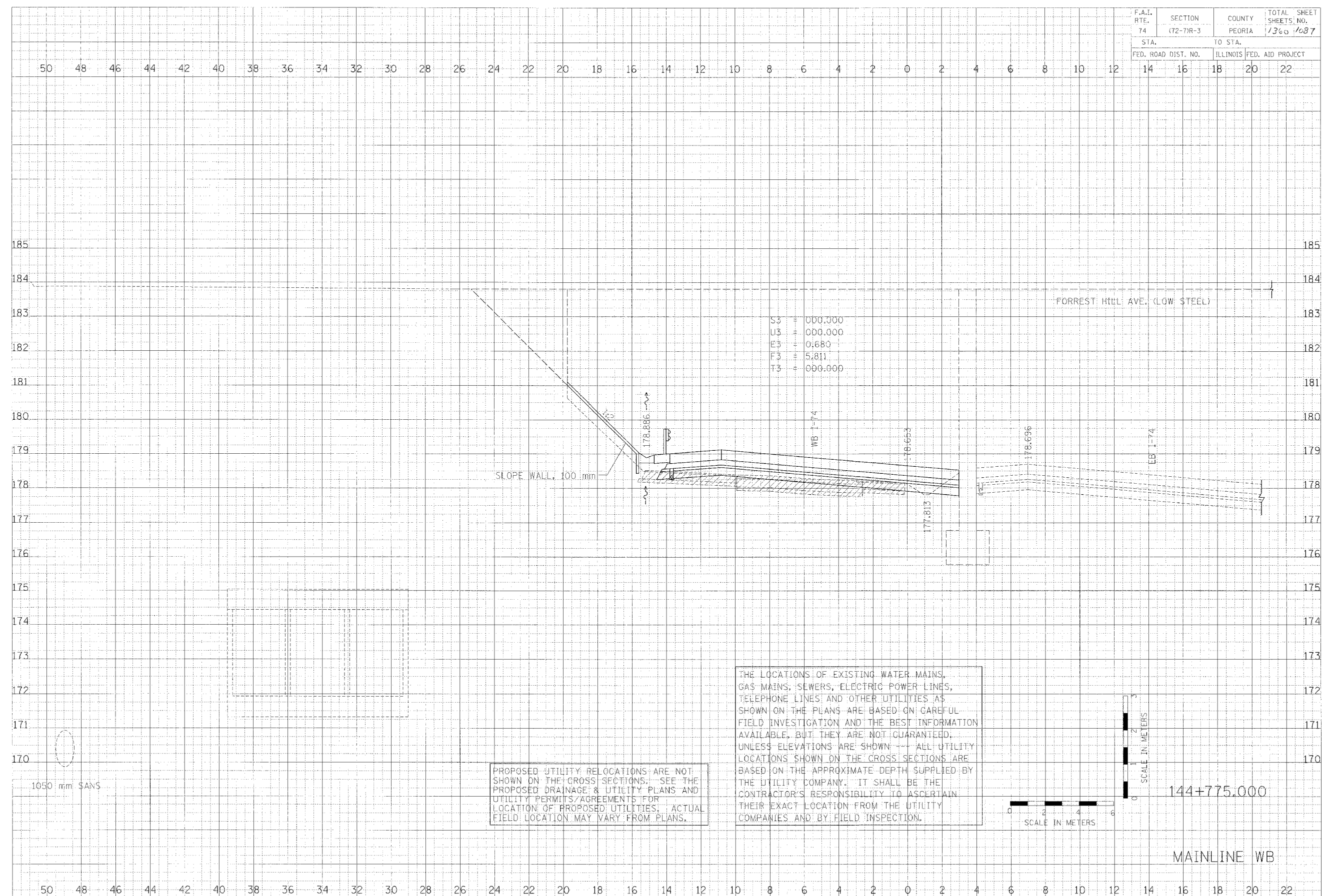

1050 mm SANS

PROPOSED UTILITY RELOCATIONS ARE NOT SHOWN ON THE CROSS SECTIONS. SEE THE PROPOSED DRAINAGE & UTILITY PLANS AND UTILITY PERMITS/AGREEMENTS FOR LOCATION OF PROPOSED UTILITIES. ACTUAL FIELD LOCATION MAY VARY FROM PLANS.

THE LOCATIONS OF EXISTING WATER MAINS, GAS MAINS, SEWERS, ELECTRIC POWER LINES, TELEPHONE LINES AND OTHER UTILITIES AS SHOWN ON THE PLANS ARE BASED ON CAREFUL FIELD INVESTIGATION AND THE BEST INFORMATION AVAILABLE, BUT THEY ARE NOT GUARANTEED. UNLESS ELEVATIONS ARE SHOWN --- ALL UTILITY LOCATIONS SHOWN ON THE CROSS SECTIONS ARE BASED ON THE APPROXIMATE DEPTH SUPPLIED BY THE UTILITY COMPANY. IT SHALL BE THE CONTRACTOR'S RESPONSIBILITY TO ASCERTAIN THEIR EXACT LOCATION FROM THE UTILITY COMPANIES AND BY FIELD INSPECTION.

SCALE IN METERS

SCALE IN METERS

144+775.000

MAINLINE WB