

All Dimensions are in millimeters (mm) unless noted otherwise.

\*\* See Culvert Cross Section Sheet 11 of 15 for Invert El. location.

See Sheet 9 of 15 for details at ends of Culvert Extension and Section D-D.

See Sheet 12 of 15 for  $h_{12}$  (E) &  $v_5$  (E) Bar Cutting Diagrams.

STATE OF ILLINOIS  
DEPARTMENT OF TRANSPORTATION

ROUTE NO.	SECTION	COUNTY	TOTAL SHEETS	SHEET NO.	SHEET NO. 7 of 15 SHEETS
F.A.I. 74	*	PEORIA	1360	1029	
FED. ROAD DIST. NO. 7		ILLINOIS	FED. AID PROJECT-		

\* (72-7)R-3 Contract 68200

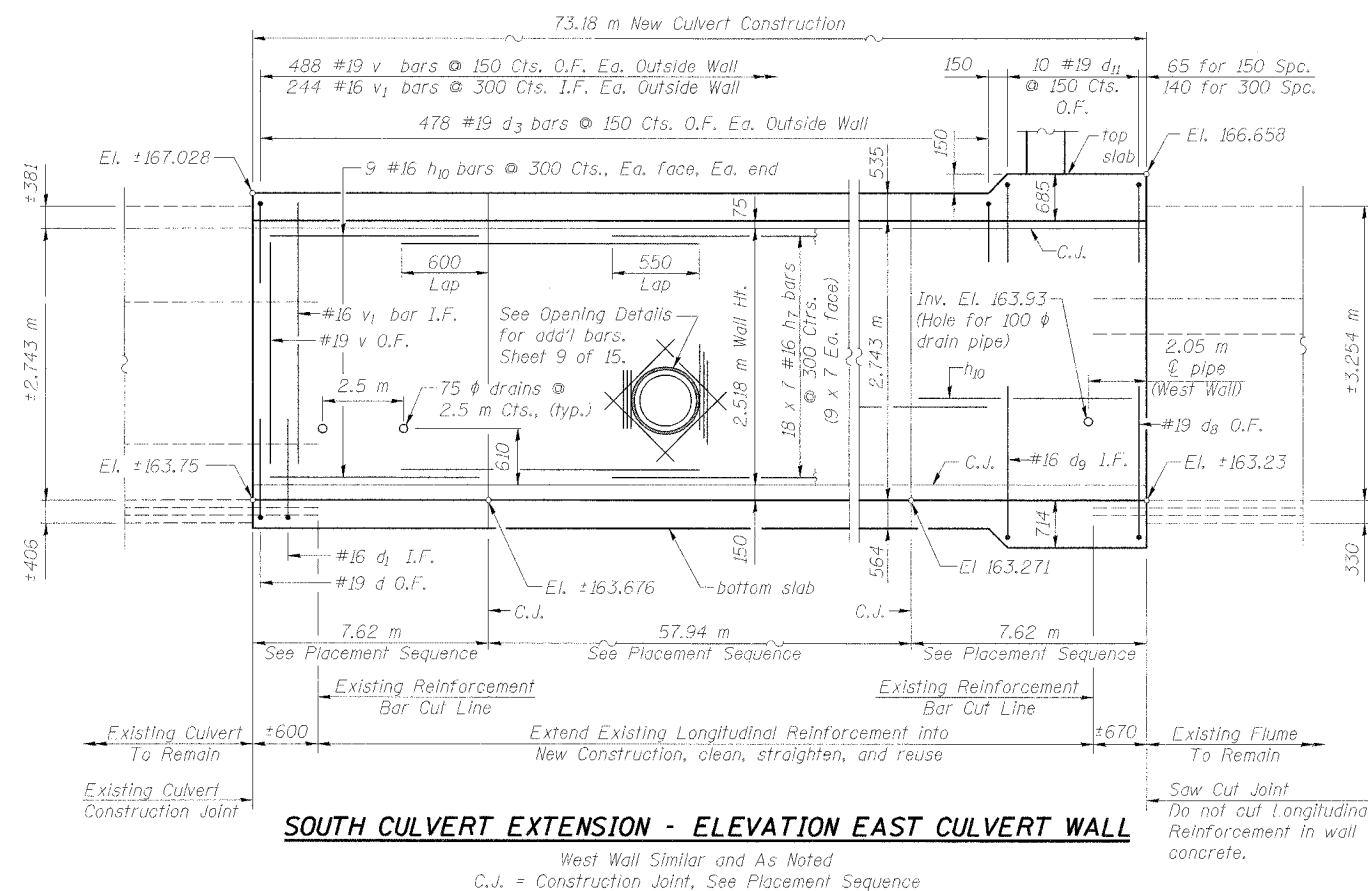
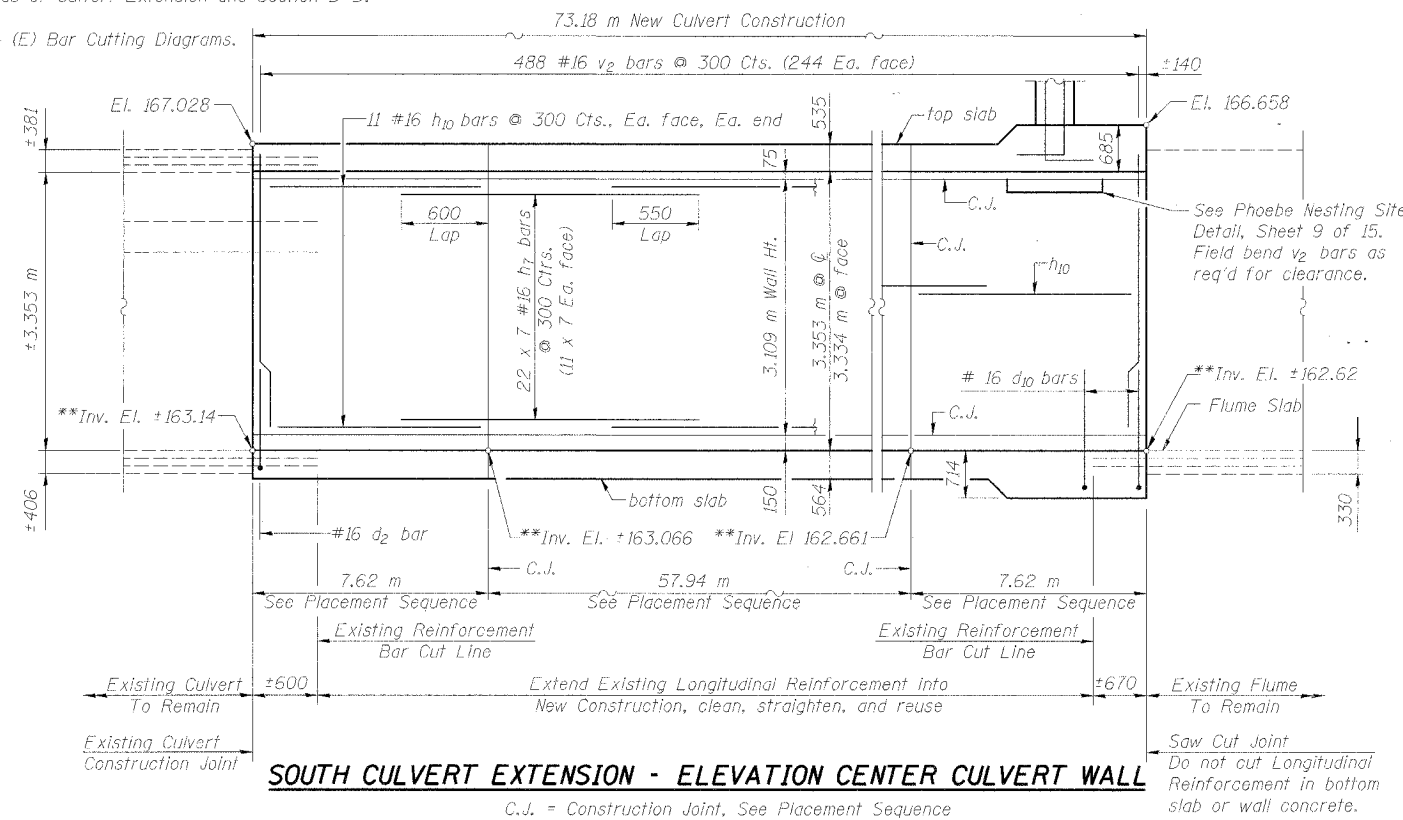

**PLACEMENT SEQUENCE**

- Center portion of walls are placed first.
- 7 days shall pass between time of center portion placement and end portions of culvert walls.

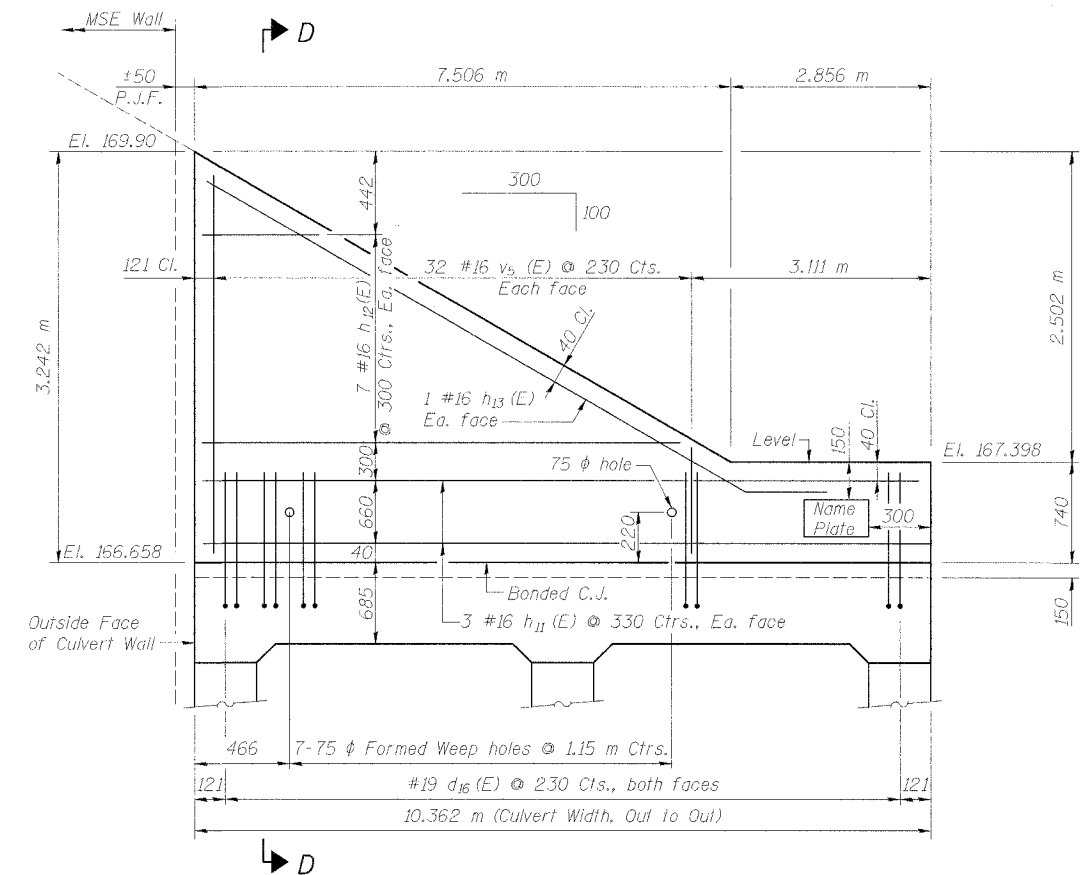

DESIGNED	LLV
CHECKED	P.JL
DRAWN	MGM
CHECKED	LLV

EAST, CENTER, & WEST WALL ELEVATION  
SOUTH CULVERT EXTENSION  
RAMP C-3 OVER DRY RUN CREEK  
F.A.I. ROUTE 74(I-74) SECTION (72-7)R-3  
PEORIA COUNTY  
STATION 10+277.51 TO  
STA. 10+441.66 (RAMP C-3)  
STRUCTURE NUMBER 072-2005



111 NE Jefferson Ave.  
Peoria, Illinois 61602  
Ph(309)676-8464  
FAX(309)676-5445

11/07/07 2:00:26 PM 01/27/05 07:35:17 AM