

F.A.I. RTE.	SECTION	COUNTY	TOTAL SHEETS	SHEET NO.
74	(72-718-3)	PEORIA	1360	769
STA. 144+718		TO STA. 145+050		
FED. ROAD DIST. NO.		ILLINOIS FED. AID PROJECT		

- NOTES:
1. ALL STATIONS INDICATED ON PLANS ARE WESTBOUND EXCEPT WHERE NOTED OTHERWISE.
 2. SEE MAINTENANCE OF TRAFFIC SHEETS FOR REMOVAL, RELOCATION AND INSTALLATION OF TEMPORARY CONCRETE BARRIERS.
 3. SEE CORRESPONDING RAMP GORE ELEVATION DETAIL SHEET FOR ADDITIONAL INFORMATION.

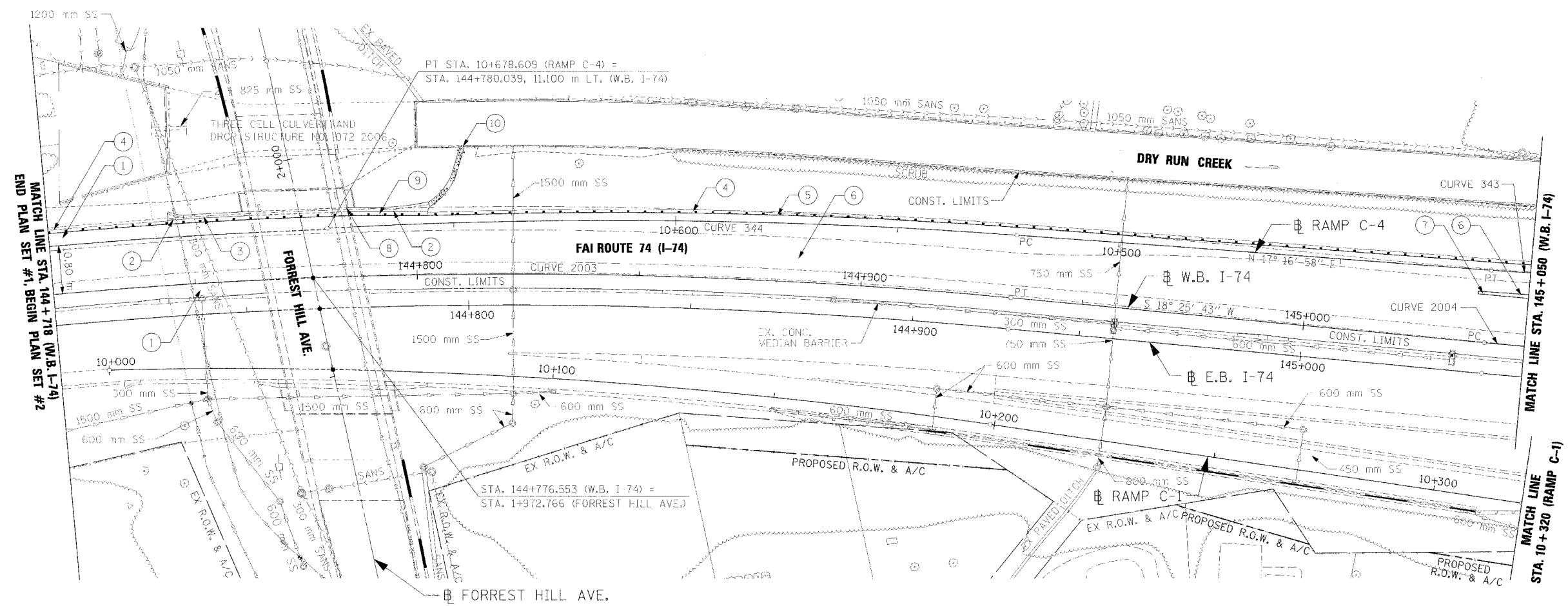

- ① PCC SHLD., 290 mm, BIT. CONC. BIND. CSE., 150 mm, AGG. SUB-BASE, 300 mm
WB LT. STA. 144+718.000 TO STA. 145+050.000
WB RT. STA. 144+718.000 TO STA. 145+050.000
- ② CLASS SI CONCRETE (OUTLET)
WB STA. 144+748.252, 14.700 m LT.
WB STA. 144+792.171, 14.521 m LT.
- ③ CONCRETE GUTTER, TYPE A (MODIFIED)
WB LT. STA. 144+748.252 TO STA. 144+792.171
- ④ GUARDRAIL AGGREGATE EROSION CONTROL.
WB LT. STA. 144+718.000 TO STA. 144+744.735
RAMP C-4 RT. STA. 10+407.101 TO STA. 10+655.766
- ⑤ STEEL PLATE BEAM GUARDRAIL, TYPE A,
WB LT. STA. 144+718.000 TO STA. 145+050.000
- ⑥ CONT. REINF PCC PYMT., 290 mm, BIT. CONC. BIND. CSE., 150 mm, AGG. SUB-BASE, 300 mm
WB LT. STA. 144+718.000 TO STA. 145+050.000
WB LT. STA. 145+038.527 TO STA. 145+050.000
- ⑦ GORE AREA, WB LT. STA. 145+038.527 TO STA. 145+050.000, SEE GORE DETAIL SHEET
- ⑧ SLOPE WALL 100 mm, WB LT. STA. 144+760.626 TO STA. 144+786.513
- ⑨ PCC SHLD., 250 mm, WB LT. STA. 144+744.736 TO STA. 144+802.609
- ⑩ CHAIN LINK FENCE, 1.2 m, WB LT. STA. 144+808.410 TO STA. 144+812.410

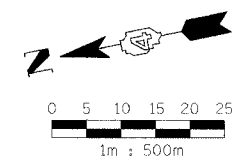

* BITUMINOUS CONCRETE BINDER COURSE, SUPERPAVE, IL-19.0L (LOW ESAL)

REVISIONS	
NAME	DATE

ILLINOIS DEPARTMENT OF TRANSPORTATION

PROPOSED ROADWAY PLAN
FAI ROUTE 74 (I-74)
WB STA. 144+718 - STA. 145+050

DATE 11/23/04

DRAWN BY CAM
CHECKED BY LSA

