

F.A.I. RTE.	SECTION	COUNTY	TOTAL SHEETS	SHEET NO.
74	(72-7)R-3	PEORIA	136	739
STA. 145+050		TO STA. 145+390		
FED. ROAD DIST. NO.	ILLINOIS	FED. AID PROJECT		

TRAFFIC CONTROL  
PROJECT STANDARD 701411-174

MAINTENANCE OF TRAFFIC LEGEND			
	WORK ZONE		EX TEMPORARY CONCRETE BARRIER
	TRAFFIC FLOW DIRECTION		PR TEMPORARY CONCRETE BARRIER
	LANE(S) CLOSED		VERTICAL PANEL
	ARROW BOARD		BARRICADE TYPE I OR TYPE II OR DRUM
	DRUM WITH STEADY BURNING MONODIRECTIONAL LIGHT		SIGN
	TYPE III BARRICADE WITH FLASHING LIGHT		CONSTRUCTION SPEED LIMIT SIGN
	TYPE III BARRICADE		FLAGGER WITH TRAFFIC CONTROL SIGN
			BARRICADE OR DRUM WITH STEADY BURNING MONODIRECTIONAL LIGHT
			BARRICADE OR DRUM WITH FLASHING LIGHT

NOTES:

1. ALL REQUIRED PAVEMENT MARKINGS MUST BE IN PLACE PRIOR TO SHIFTING TRAFFIC.

PROJECT STANDARD 701411-174 SHALL BE USED TO CLOSE RAMP C-3 AND RAMP C-4. IN ADDITION TYPE III BARRICADES, PER PROJECT STANDARD 701411-174, SHALL BE INSTALLED AT THE TOP OF RAMP C-3.

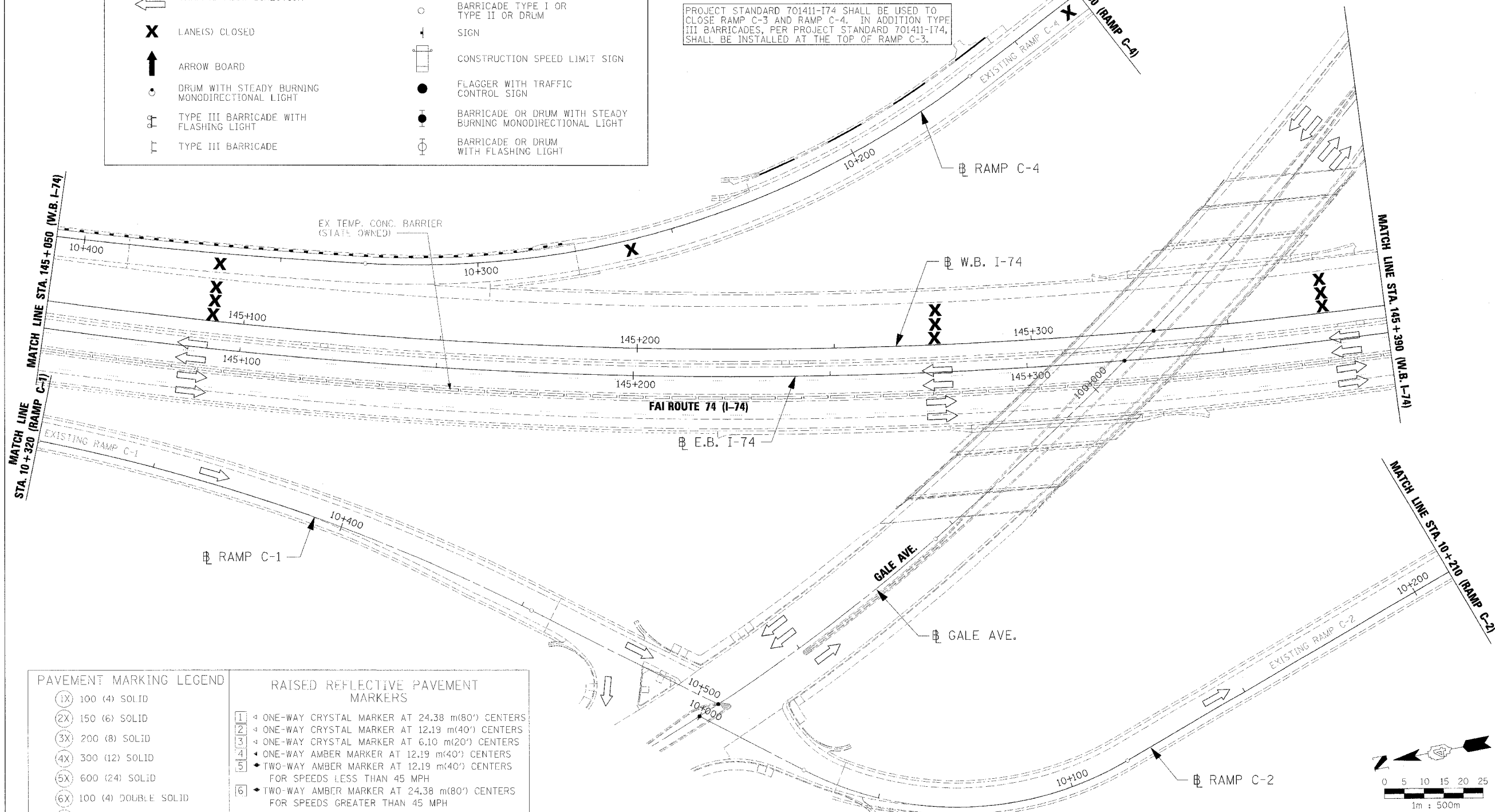

PAVEMENT MARKING LEGEND

- (1X) 100 (4) SOLID
- (2X) 150 (6) SOLID
- (3X) 200 (8) SOLID
- (4X) 300 (12) SOLID
- (5X) 600 (24) SOLID
- (6X) 100 (4) DOUBLE SOLID
- (7X) 100 (4) SKIP DASH
- (8X) 150 (6) SKIP DASH
- (9X) 200 (8) SKIP DASH
- (10X) 200 (8) DOTTED
- (11X) LETTERS AND ARROWS

RAISED REFLECTIVE PAVEMENT MARKERS

- 1 ONE-WAY CRYSTAL MARKER AT 24.38 m(80') CENTERS
- 2 ONE-WAY CRYSTAL MARKER AT 12.19 m(40') CENTERS
- 3 ONE-WAY CRYSTAL MARKER AT 6.10 m(20') CENTERS
- 4 ONE-WAY AMBER MARKER AT 12.19 m(40') CENTERS
- 5 TWO-WAY AMBER MARKER AT 12.19 m(40') CENTERS FOR SPEEDS LESS THAN 45 MPH
- 6 TWO-WAY AMBER MARKER AT 24.38 m(80') CENTERS FOR SPEEDS GREATER THAN 45 MPH

WHERE "X" DESIGNATES:

- E = EPOXY
- P = PAINT
- T = THERMOPLASTIC
- U = POLYUREA

- TP= TEMPORARY PAVEMENT MARKING
  - T3= PAVEMENT MARKING TAPE, TYPE III
  - W3= WET TEMPORARY PAVEMENT MARKING TAPE, TYPE III
- All dimensions are in millimeters (inches) unless otherwise shown.

REVISIONS	
NAME	DATE

ILLINOIS DEPARTMENT OF TRANSPORTATION  
MAINTENANCE OF TRAFFIC  
STAGE 3-3  
WB STA. 145+050 - STA. 145+390

DATE 11/23/04  
DRAWN BY RDY  
CHECKED BY LSA

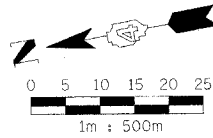

11/23/04 10:00 AM