

F.A.I. RTE.	SECTION	COUNTY	TOTAL SHEETS	SHEET NO.
74	(72-7)R-3	PEORIA	1360	738
STA. 144+718		TO STA. 145+050		
FED. ROAD DIST. NO.	ILLINOIS	FED. AID PROJECT		

MAINTENANCE OF TRAFFIC LEGEND			
	WORK ZONE		EX TEMPORARY CONCRETE BARRIER
	TRAFFIC FLOW DIRECTION		PR TEMPORARY CONCRETE BARRIER
	LANE(S) CLOSED		VERTICAL PANEL
	ARROW BOARD		BARRICADE TYPE I OR TYPE II OR DRUM
	DRUM WITH STEADY BURNING MONODIRECTIONAL LIGHT		SIGN
	TYPE III BARRICADE WITH FLASHING LIGHT		CONSTRUCTION SPEED LIMIT SIGN
	TYPE III BARRICADE		FLAGGER WITH TRAFFIC CONTROL SIGN
			BARRICADE OR DRUM WITH STEADY BURNING MONODIRECTIONAL LIGHT
			BARRICADE OR DRUM WITH FLASHING LIGHT

NOTES:
1. ALL REQUIRED PAVEMENT MARKINGS MUST BE IN PLACE PRIOR TO SHIFTING TRAFFIC.

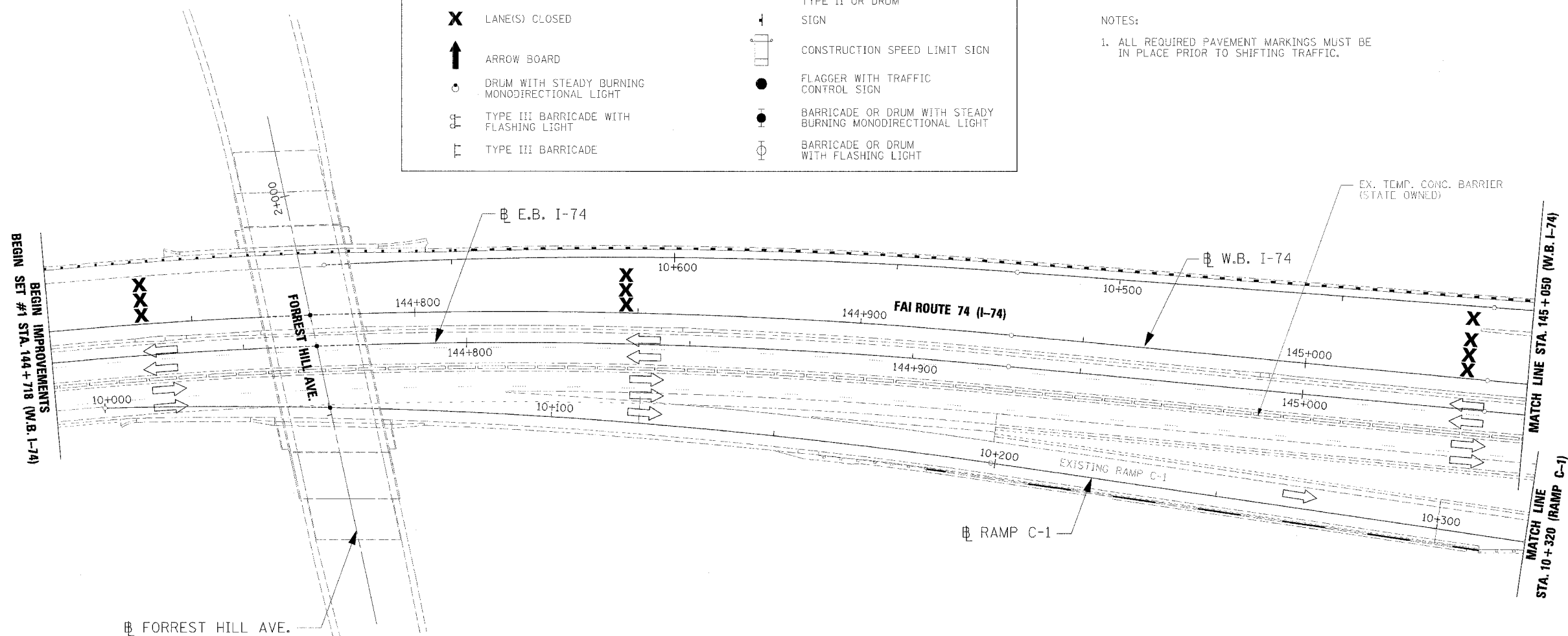

PAVEMENT MARKING LEGEND

- (1X) 100 (4) SOLID
- (2X) 150 (6) SOLID
- (3X) 200 (8) SOLID
- (4X) 300 (12) SOLID
- (5X) 600 (24) SOLID
- (6X) 100 (4) DOUBLE SOLID
- (7X) 100 (4) SKIP DASH
- (8X) 150 (6) SKIP DASH
- (9X) 200 (8) SKIP DASH
- (10X) 200 (8) DOTTED
- (11X) LETTERS AND ARROWS

RAISED REFLECTIVE PAVEMENT MARKERS

- 1 ◀ ONE-WAY CRYSTAL MARKER AT 24.38 m(80') CENTERS
- 2 ◀ ONE-WAY CRYSTAL MARKER AT 12.19 m(40') CENTERS
- 3 ◀ ONE-WAY CRYSTAL MARKER AT 6.10 m(20') CENTERS
- 4 ◀ ONE-WAY AMBER MARKER AT 12.19 m(40') CENTERS
- 5 ▶ TWO-WAY AMBER MARKER AT 12.19 m(40') CENTERS FOR SPEEDS LESS THAN 45 MPH
- 6 ▶ TWO-WAY AMBER MARKER AT 24.38 m(80') CENTERS FOR SPEEDS GREATER THAN 45 MPH

WHERE "X" DESIGNATES:
 E = EPOXY
 P = PAINT
 T = THERMOPLASTIC
 U = POLYUREA
 TP= TEMPORARY PAVEMENT MARKING
 T3= PAVEMENT MARKING TAPE, TYPE III
 W3= WET TEMPORARY PAVEMENT MARKING TAPE, TYPE III
 All dimensions are in millimeters (inches) unless otherwise shown.



REVISIONS	
NAME	DATE

ILLINOIS DEPARTMENT OF TRANSPORTATION

MAINTENANCE OF TRAFFIC
STAGE 3-3
WB STA. 144+718 - STA. 145+050

DATE 11/23/04

DRAWN BY RDY
CHECKED BY LSA

