

F.A.I. RTE.	SECTION	COUNTY	TOTAL SHEETS	SHEET NO.
74	(72-71R-3)	PEORIA	1360	937
STA. 146+070		TO STA. 146+410		
FED. ROAD DIST. NO.	ILLINOIS	FED. AID PROJECT		

**MAINTENANCE OF TRAFFIC LEGEND**

WORK ZONE	EX TEMPORARY CONCRETE BARRIER
TRAFFIC FLOW DIRECTION	PR TEMPORARY CONCRETE BARRIER
LANE(S) CLOSED	VERTICAL PANEL
ARROW BOARD	BARRICADE TYPE I OR TYPE II OR DRUM
DRUM WITH STEADY BURNING MONODIRECTIONAL LIGHT	SIGN
TYPE III BARRICADE WITH FLASHING LIGHT	CONSTRUCTION SPEED LIMIT SIGN
TYPE III BARRICADE	FLAGGER WITH TRAFFIC CONTROL SIGN
	BARRICADE OR DRUM WITH STEADY BURNING MONODIRECTIONAL LIGHT
	BARRICADE OR DRUM WITH FLASHING LIGHT

NOTES:  
1. ALL REQUIRED PAVEMENT MARKINGS MUST BE IN PLACE PRIOR TO SHIFTING TRAFFIC.

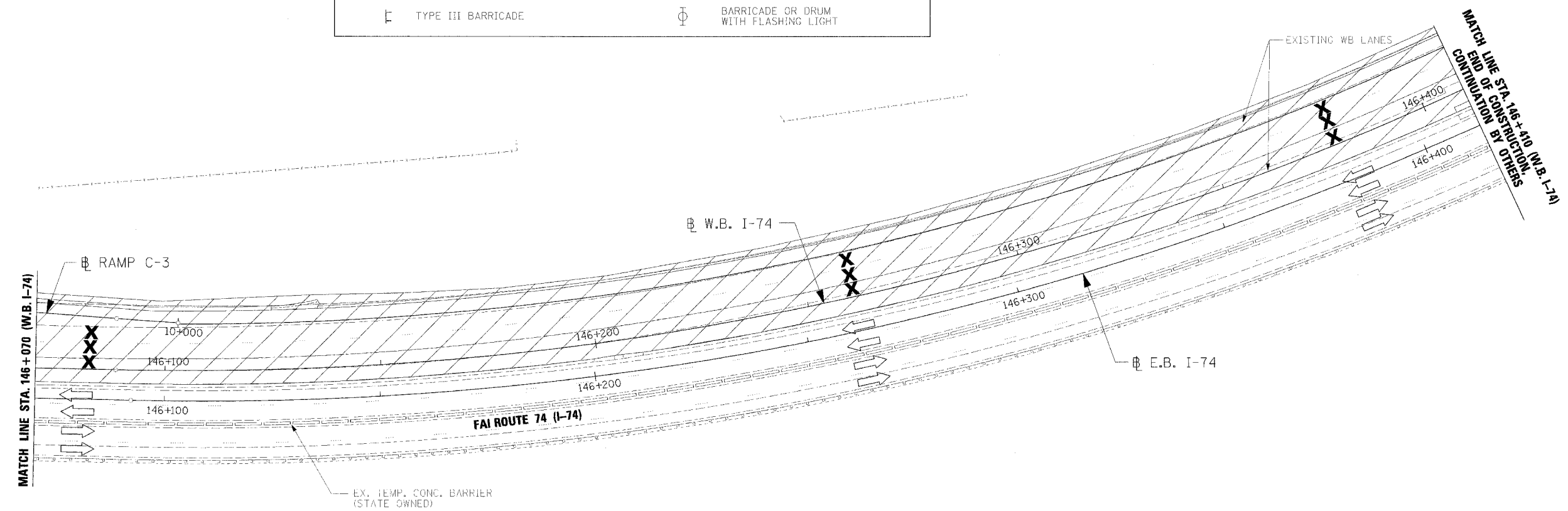

**PAVEMENT MARKING LEGEND**

- (1X) 100 (4) SOLID
- (2X) 150 (6) SOLID
- (3X) 200 (8) SOLID
- (4X) 300 (12) SOLID
- (5X) 600 (24) SOLID
- (6X) 100 (4) DOUBLE SOLID
- (7X) 100 (4) SKIP DASH
- (8X) 150 (6) SKIP DASH
- (9X) 200 (8) SKIP DASH
- (10X) 200 (8) DOTTED
- (11X) LETTERS AND ARROWS

**RAISED REFLECTIVE PAVEMENT MARKERS**

- 1 ONE-WAY CRYSTAL MARKER AT 24.38 m(80') CENTERS
- 2 ONE-WAY CRYSTAL MARKER AT 12.19 m(40') CENTERS
- 3 ONE-WAY CRYSTAL MARKER AT 6.10 m(20') CENTERS
- 4 ONE-WAY AMBER MARKER AT 12.19 m(40') CENTERS
- 5 TWO-WAY AMBER MARKER AT 12.19 m(40') CENTERS FOR SPEEDS LESS THAN 45 MPH
- 6 TWO-WAY AMBER MARKER AT 24.38 m(80') CENTERS FOR SPEEDS GREATER THAN 45 MPH

WHERE "X" DESIGNATES:  
E = EPOXY  
P = PAINT  
T = THERMOPLASTIC  
U = POLYUREA

— WHITE  
— YELLOW

1P= TEMPORARY PAVEMENT MARKING  
T3= PAVEMENT MARKING TAPE, TYPE III  
W3= WET TEMPORARY PAVEMENT MARKING TAPE, TYPE III  
All dimensions are in millimeters (inches) unless otherwise shown.

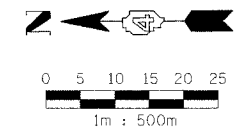

REVISIONS	
NAME	DATE

ILLINOIS DEPARTMENT OF TRANSPORTATION

MAINTENANCE OF TRAFFIC  
STAGE 3-2  
WB STA. 146+070 - STA. 146+410

DRAWN BY RDY  
CHECKED BY LSA

DATE 11/23/04

