

ROUTE NO.	SECT.	COUNTY	SHEET NO.	TOTAL SHEETS
F.A.I. 74	(72-7) R-3	PEORIA	548	1360
FED. ROAD DIST. NO. 7	ILLINOIS	FED. AID PROJECT		

CONTRACT NO. 68200

**BILL OF MATERIAL**

Bar	No.	Size	Length (m)	Shape
a <sub>10</sub>	556	19	8.40	—
a <sub>11</sub>	488	16	3.51	—
a <sub>12</sub>	500	25	2.20	—
a <sub>13</sub>	16	19	6.50	—
a <sub>14</sub>	20	16	4.10	—
a <sub>15</sub>	14	16	4.50	—
a <sub>16</sub>	16	25	3.10	—
b	54	16	8.36	—
d <sub>10</sub>	48	16	1.50	—
h	76	16	5.85	—
h <sub>1</sub>	38	16	3.95	—
h <sub>2</sub>	8	16	7.30	—
h <sub>10</sub>	792	16	7.10	—
h <sub>11</sub>	462	16	8.03	—
n	96	19	2.07	—
n <sub>1</sub>	92	16	1.54	—
s <sub>10</sub>	40	13	1.63	□
s <sub>11</sub>	40	13	1.63	□
v	104	16	4.19	—
v <sub>1</sub>	124	16	3.35	—
v <sub>10</sub>	639	25	3.10	—
v <sub>11</sub>	639	25	1.28	—
Concrete Box Culverts		m <sup>3</sup>	508.6	
Reinforcement Bars		kg	47,670	

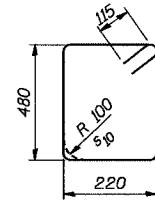

**BARS s<sub>10</sub> & s<sub>11</sub>**

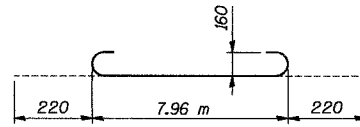

**BAR a<sub>10</sub>**

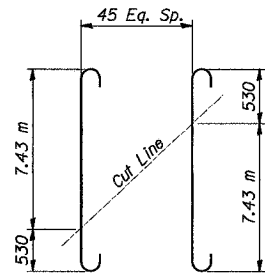

**CUTTING DIAGRAM**

**BAR a<sub>10</sub>**

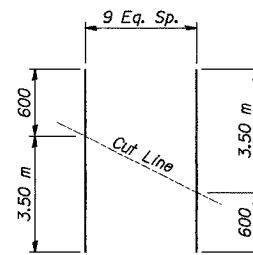

**CUTTING DIAGRAM**

**BAR a<sub>14</sub>**

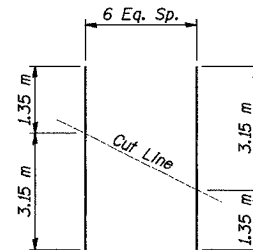

**CUTTING DIAGRAM**

**BAR a<sub>15</sub>**

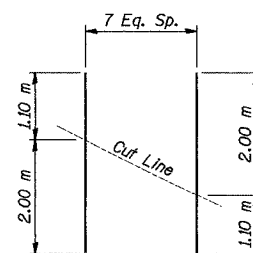

**CUTTING DIAGRAM**

**BAR a<sub>16</sub>**

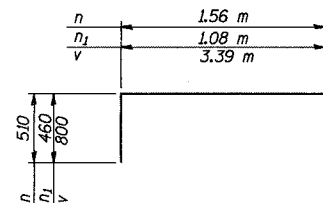

**BARS n, n<sub>1</sub> & v**

Time: 11/21/04 AM

Date: 11/22/2004

Filename: P:\643996\structural\072-2030-culvert\sheet\Tracings\RE0003-1A0722030.dgn

Designed by: WEE  
 Checked by: RW  
 Drafted by: RKS  
 Checked by: RW

Note:  
 All dimensions are in millimeters (mm) unless otherwise noted.

REVISION	DATE	DESCRIPTION
STATE OF ILLINOIS DEPARTMENT OF TRANSPORTATION		
BAR DETAILS AND BILL OF MATERIAL		
RAMP B-3 OVER DRY RUN CREEK F.A.I. ROUTE 74 SEC. (72-7)R-3 PEORIA COUNTY STA. 11+072.082 (RAMP B-3) STRUCTURE NUMBER 072-2030		
PARSONS TRANSPORTATION GROUP CHICAGO, ILLINOIS		
DRAWING NO. 5	SCALE N.T.S.	DATE 8/31/04
		SHEET NO. 5