

F.A. RTE.	SECTION	COUNTY	TOTAL SHEETS	SHEET NO.
74	(72-71R-3)	PEORIA	1360	908
STA.		TO STA.		
FED. ROAD DIST. NO.		ILLINOIS FED. AID PROJECT		

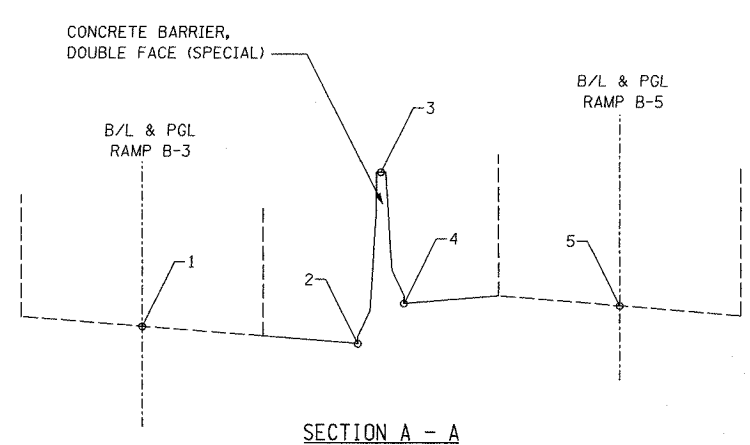

- NOTES:**
1. BARRIER BASE WIDTH EQUALS 0.685m
  2. BARRIER HEIGHT EQUALS 1.295m ON HIGH SIDE OF SHOULDER. ON LOW SIDE OF SHOULDER, HEIGHT EQUALS DIFFERENCE BETWEEN SHOULDER ELEVATION AND TOP OF BARRIER ELEVATION.
  3. BARRIER ON LOW SIDE OF SHOULDER RETAINS GM-SHAPE TO 1.295m HIGH THEN PROVIDES VERTICAL FACE TO ACHIEVE REQUIRED HEIGHT. SEE CONCRETE BARRIER, DOUBLE FACE (SPECIAL) DETAIL.

RAMP B3 STATION	ELEVATIONS					RAMP B5 STATION
	1	2	3	4	5	
10+690.000	200.379	200.381	201.681	200.386	200.384	10+415.565
10+695.000	200.274	200.276	201.575	200.280	200.278	10+410.565
10+700.000	200.168	200.170	201.470	200.175	200.173	10+405.565
10+705.000	200.063	200.065	201.365	200.070	200.068	10+400.565
10+710.000	199.958	199.960	201.259	199.964	199.962	10+395.565
10+715.000	199.852	199.854	201.154	199.859	199.857	10+390.565
10+720.000	199.747	199.749	201.048	199.753	199.751	10+385.565
10+725.000	199.641	199.643	200.943	199.648	199.646	10+380.565
10+730.000	199.536	199.538	200.837	199.542	199.540	10+375.565
10+735.000	199.430	199.432	200.732	199.437	199.435	10+370.565
10+740.000	199.325	199.327	200.626	199.331	199.329	10+365.565
10+745.000	199.220	199.222	200.521	199.226	199.224	10+360.565
10+750.000	199.114	199.116	200.416	199.121	199.119	10+355.565
10+755.000	199.009	199.011	200.310	199.015	199.013	10+350.565
10+760.000	198.906	198.908	200.205	198.910	198.908	10+345.565
10+765.000	198.810	198.812	200.107	198.804	198.802	10+340.565
10+770.000	198.720	198.722	200.017	198.699	198.697	10+335.565
10+775.000	198.636	198.624	199.919	198.593	198.591	10+330.565
10+780.000	198.558	198.513	199.808	198.488	198.486	10+325.565
10+785.000	198.487	198.403	199.698	198.382	198.380	10+320.565
10+790.000	198.421	198.304	199.599	198.277	198.275	10+315.565
10+795.000	198.362	198.212	199.507	198.201	198.170	10+310.565
10+800.000	198.306	198.126	199.424	198.129	198.064	10+305.565
10+805.000	198.250	198.036	199.358	198.063	197.959	10+300.565
10+810.000	198.193	197.945	199.292	197.997	197.853	10+295.565
10+815.000	198.137	197.849	199.234	197.939	197.748	10+290.565
10+820.000	198.081	197.753	199.175	197.880	197.642	10+285.565
10+825.000	198.025	197.650	199.128	197.833	197.555	10+281.416
10+830.000	197.968	197.546	199.082	197.787	197.469	10+277.352
10+835.000	197.912	197.450	199.038	197.743	197.384	10+273.298
10+840.000	197.856	197.347	198.986	197.691	197.299	10+269.260
10+845.000	197.800	197.264	198.901	197.606	197.214	10+265.242
10+850.000	197.743	197.207	198.817	197.522	197.130	10+261.249
10+855.000	197.687	197.151	198.733	197.438	197.046	10+257.286
10+860.000	197.631	197.095	198.650	197.355	196.963	10+253.356
10+865.000	197.575	197.039	198.568	197.273	196.881	10+249.463
10+870.000	197.518	196.982	198.487	197.192	196.800	10+245.609
10+875.000	197.462	196.926	198.406	197.111	196.719	10+241.798
10+880.000	197.406	196.870	198.325	197.030	196.640	10+238.030
10+885.000	197.350	196.814	198.244	196.949	196.561	10+234.306
10+890.000	197.293	196.757	198.163	196.868	196.484	10+230.630
10+895.000	197.237	196.701	198.082	196.787	196.407	10+227.001
10+900.000	197.181	196.645	198.001	196.706	196.332	10+223.420

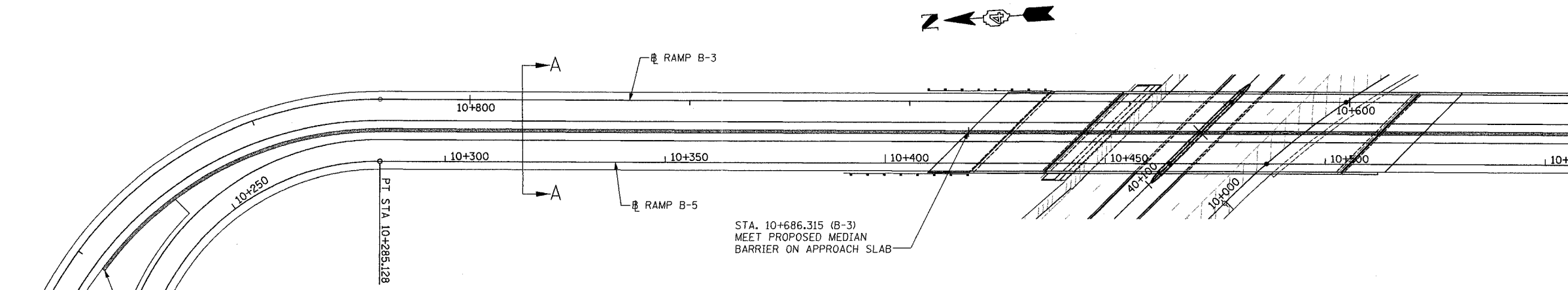
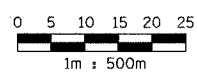

REVISIONS	
NAME	DATE

ILLINOIS DEPARTMENT OF TRANSPORTATION  
**CONCRETE BARRIER ELEVATIONS**  
 FAI ROUTE 74 (I-74) (WB)  
 RAMP B-3, B-5  
 DRAWN BY CADD  
 CHECKED BY MWP  
 DATE 11/12/04