

F.A. RTE.	SECTION	COUNTY	TOTAL SHEETS	SHEET NO.
74	(72-71R-3)	PEORIA	1360	299
STA. 143+950.000		TO STA. 144+250.000		
FED. ROAD DIST. NO.		ILLINOIS FED. AID PROJECT		

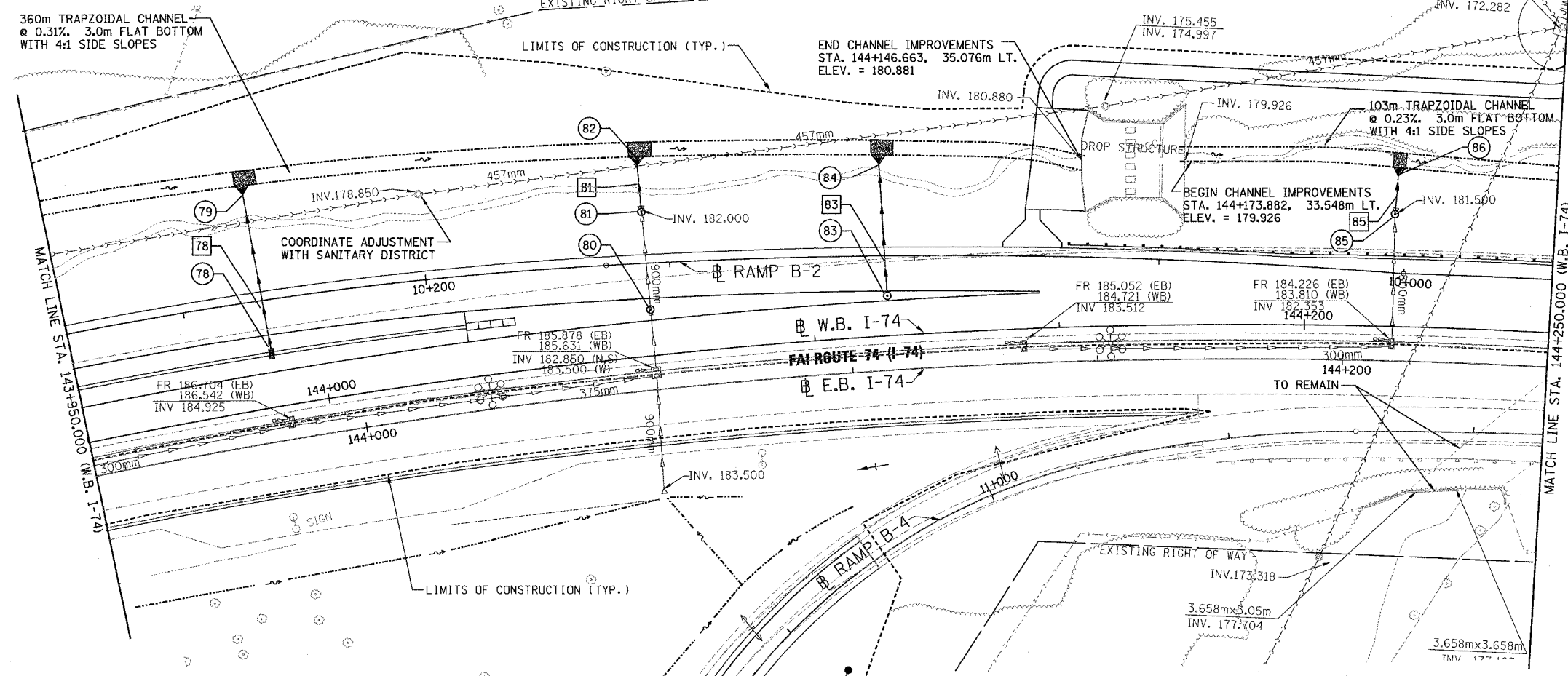

LEGEND

EXISTING	PROPOSED	EXISTING	PROPOSED

DRAINAGE STRUCTURE TABLE

#	TYPE	DIAMETER	PROFILE	FRAME/GRATE	STATION, OFFSET	FRAME ELEV.	INV. EL.
78	DS, TY 1	-	ON GRADE	TYPE 20	143+990.000 (WB), 10.968m LT.	196.880 (WB) 196.871 (B2)	195.600
79	END SECTION	300mm	ON GRADE	-	143+989.000(WB), 43.247m LT.	-	182.033
80	MH, TY A	1.8m	ON GRADE	TYPE 1, OPEN	144+067.222 (WB), 9.448m LT.	186.042	182.534
81	MH, TY A	1.8m	ON GRADE	TYPE 1, CLOSED	144+067.413 (WB), 29.385m LT.	184.030	182.000
82	END SECTION	900mm	ON GRADE	-	144+066.564(WB), 38.216m LT.	-	181.585
83	MH, TY A	1.2m	ON GRADE	TYPE 1, OPEN	144+015.262 (WB), 8.169m LT.	185.480	184.200
84	END SECTION	300mm	ON GRADE	-	144+115.262(WB), 32.499m LT.	-	181.296
85	MH, TY A	1.2m	ON GRADE	TYPE 1, OPEN	144+218.605 (WB), 23.037m LT.	182.500	181.500 (W) 180.900 (E)
86	END SECTION	300mm	ON GRADE	-	144+218.605(WB), 29.847m LT.	-	179.973

DRAINAGE PIPE TABLE

#	CLASS	TYPE	DIAMETER	LENGTH	INV. EL. UPSTREAM	INV. EL. DOWNSTREAM	REMARKS	TRENCH BACKFILL	REMARKS
78	A	1	300mm	32.0m	195.600	182.033	11.14%	22.0	
81	A	2	900mm	9.6m	182.000	181.585	4.32%	0.0	
83	A	1	300mm	27.0m	184.200	181.296	10.75%	9.7	
85	A	1	300mm	7.5m	180.900	180.000	12.00%	0.0	

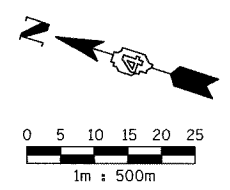

REVISIONS		ILLINOIS DEPARTMENT OF TRANSPORTATION DRAINAGE AND UTILITY PLAN FAI ROUTE 74 (I-74) (WB) STA. 143+950.000 - STA. 144+250.000
NAME	DATE	
		DRAWN BY CADD CHECKED BY KJW DATE 11/12/04

