

F.A. RTE.	SECTION	COUNTY	TOTAL SHEETS	SHEET NO.
74	(72-71R-3)	PEORIA	1360	180
STA. 142+300.000		TO STA. 142+650.000		
FED. ROAD DIST. NO.		ILLINOIS FED. AID PROJECT		

### LEGEND

- |  |  |  |   |
|--|--|--|---|
|  | CONSTRUCTED THIS STAGE                       |  | TYPE III BARRICADE WITH FLASHING LIGHTS (ROAD CLOSED) |
|  | CONSTRUCTED IN PRECEDING STAGES              |  | SIGN  |
|  | TEMPORARY PAVEMENT                           |  | LANE(S) CLOSED  |
|  | DIRECTION OF TRAFFIC                         |  |   |
|  | TEMPORARY CONCRETE BARRIER WITH GLARE SCREEN |  |   |
|  | PLASTIC DRUM                                 |  |   |

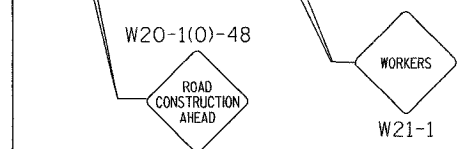
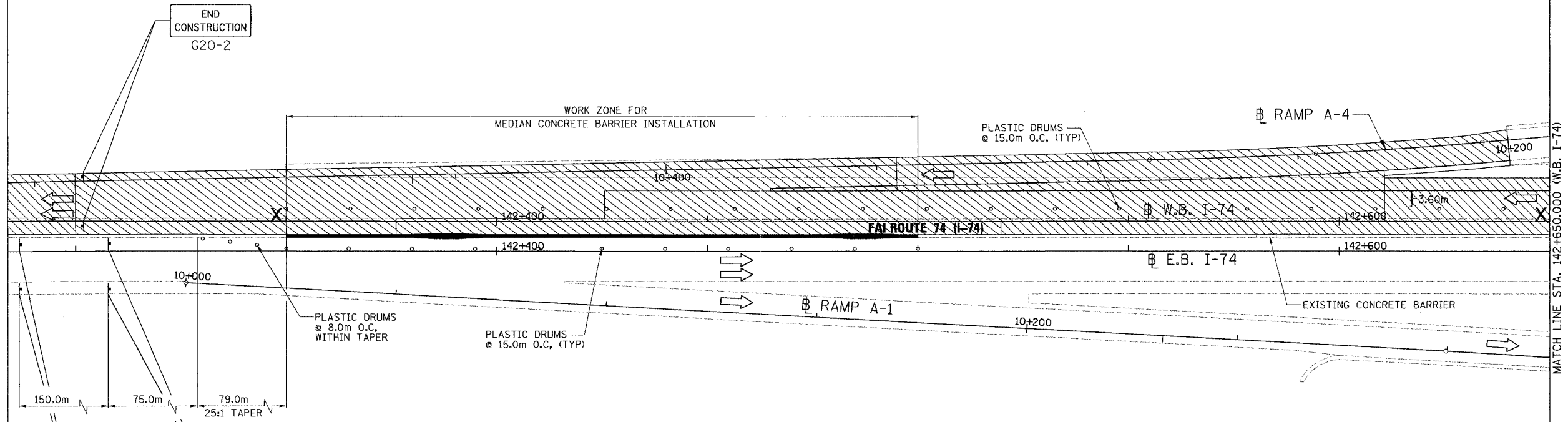

#### PAVEMENT MARKING LEGEND

- (1X) 100 (4) SOLID
- (2X) 150 (6) SOLID
- (3X) 200 (8) SOLID
- (4X) 300 (12) SOLID
- (5X) 600 (24) SOLID
- (6X) 100 (4) DOUBLE SOLID
- (7X) 100 (4) SKIP DASH
- (8X) 150 (6) SKIP DASH
- (9X) 200 (8) SKIP DASH
- (10X) 200 (8) DOTTED
- (11X) LETTERS AND ARROWS

#### RAISED REFLECTIVE PAVEMENT MARKERS

- 1 ◁ ONE-WAY CRYSTAL MARKER AT 24.38 m(80') CENTERS
- 2 ▷ ONE-WAY CRYSTAL MARKER AT 12.19 m(40') CENTERS
- 3 ◁ ONE-WAY CRYSTAL MARKER AT 6.10 m(20') CENTERS
- 4 ◁ ONE-WAY AMBER MARKER AT 12.19 m(40') CENTERS
- 5 ◆ TWO-WAY AMBER MARKER AT 12.19 m(40') CENTERS FOR SPEEDS LESS THAN 45 MPH
- 6 ◆ TWO-WAY AMBER MARKER AT 24.38 m(80') CENTERS FOR SPEEDS GREATER THAN 45 MPH

WHERE "X" DESIGNATES:

E = EPOXY                      — WHITE  
P = PAINT                        — YELLOW  
T = THERMOPLASTIC  
TP= TEMPORARY PAVEMENT MARKING TAPE  
T3= PAVEMENT MARKING TAPE, TYPE III

All dimensions are in millimeters (inches) unless otherwise shown.

#### NOTE:

1. TEMPORARY STRIPING NOT USED IF PROPOSED PERMANENT PAVEMENT MARKINGS IN PLACE. PERMANENT MARKINGS SHOWN ON PAVEMENT MARKING DRAWINGS.
2. WB INSIDE LANE TO BE OPEN DURING NON-WORKING HOURS. RELOCATE DRUMS AS NEEDED.

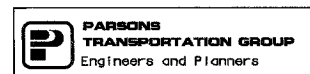
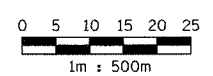

REVISIONS	
NAME	DATE

ILLINOIS DEPARTMENT OF TRANSPORTATION  
**MAINTENANCE OF TRAFFIC**  
**FAI ROUTE 74 (I-74 WB)**  
**STAGE 3-4; SUBSTAGE 1**  
**STA. 142+300.000 - STA. 142+650.000**

DATE 11/12/04  
DRAWN BY CADD  
CHECKED BY KJW