

F.A. RTE.	SECTION	COUNTY	TOTAL SHEETS	SHEET NO.
74	(72-7)R-3	PEORIA	1300	127
STA. 141+600.000		TO STA. 141+950.000		
FED. ROAD DIST. NO.		ILLINOIS FED. AID PROJECT		

LEGEND

- | | | | |
|--|--|--|---|
| | CONSTRUCTED THIS STAGE | | TYPE III BARRICADE WITH FLASHING LIGHTS (ROAD CLOSED) |
| | TEMPORARY PAVEMENT | | SIGN |
| | DIRECTION OF TRAFFIC | | LANE(S) CLOSED |
| | TEMPORARY CONCRETE BARRIER WITH GLARE SCREEN | | |
| | PLASTIC DRUM | | |

PAVEMENT MARKING LEGEND

- (1X) 100 (4) SOLID
- (2X) 150 (6) SOLID
- (3X) 200 (8) SOLID
- (4X) 300 (12) SOLID
- (5X) 600 (24) SOLID
- (6X) 100 (4) DOUBLE SOLID
- (7X) 100 (4) SKIP DASH
- (8X) 150 (6) SKIP DASH
- (9X) 200 (8) SKIP DASH
- (10X) 200 (8) DOTTED
- (11X) LETTERS AND ARROWS

RAISED REFLECTIVE PAVEMENT MARKERS

- 1 < ONE-WAY CRYSTAL MARKER AT 24.38 m(80') CENTERS
- 2 < ONE-WAY CRYSTAL MARKER AT 12.19 m(40') CENTERS
- 3 < ONE-WAY CRYSTAL MARKER AT 6.10 m(20') CENTERS
- 4 < ONE-WAY AMBER MARKER AT 12.19 m(40') CENTERS
- 5 < TWO-WAY AMBER MARKER AT 12.19 m(40') CENTERS FOR SPEEDS LESS THAN 45 MPH
- 6 < TWO-WAY AMBER MARKER AT 24.38 m(80') CENTERS FOR SPEEDS GREATER THAN 45 MPH

WHERE "X" DESIGNATES:

E = EPOXY	— WHITE
P = PAINT	— YELLOW
T = THERMOPLASTIC	

TP= TEMPORARY PAVEMENT MARKING TAPE
T3= PAVEMENT MARKING TAPE, TYPE III
W3= WET TEMPORARY PAVEMENT MARKING TAPE, TYPE III

All dimensions are in millimeters (inches) unless otherwise shown.

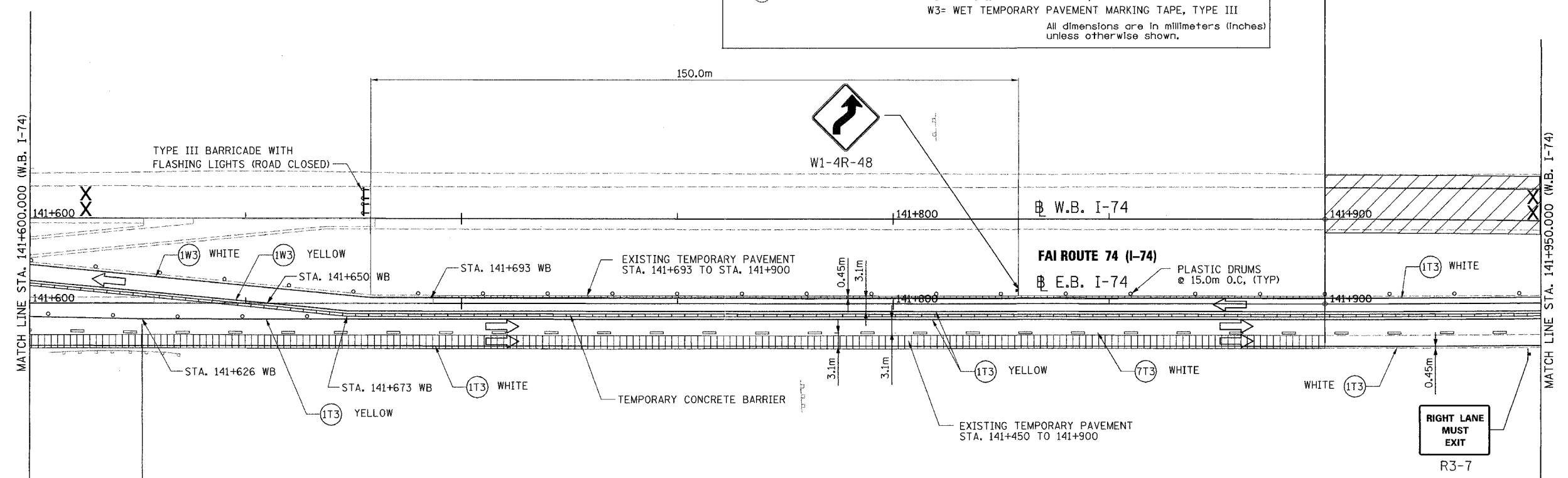

- (1W3) 100 mm SOLID, WET TEMPORARY PAVEMENT MARKING TAPE, TYPE III (WHITE)
WB RT STA. 141+600 TO STA. 141+900
- (1Y3) 100 mm SOLID, WET TEMPORARY PAVEMENT MARKING TAPE, TYPE III (YELLOW)
WB RT STA. 141+600 TO STA. 141+650
- (7T3) 100 mm SKIP DASH, TEMPORARY PAVEMENT MARKING TAPE (WHITE)
WB RT STA. 141+600 TO STA. 141+950
- (1T3) 100 mm SOLID, TEMPORARY PAVEMENT MARKING TAPE (WHITE)
WB RT STA. 141+600 TO STA. 141+950
WB RT STA. 141+900 TO STA. 141+950
- (1Y3) 100 mm SOLID, TEMPORARY PAVEMENT MARKING TAPE (YELLOW)
WB RT STA. 141+600 TO STA. 141+950
WB RT STA. 141+650 TO STA. 141+950

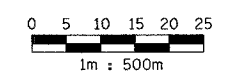

PARSONS TRANSPORTATION GROUP
Engineers and Planners

REVISIONS	
NAME	DATE

ILLINOIS DEPARTMENT OF TRANSPORTATION
MAINTENANCE OF TRAFFIC
FAI ROUTE 74 (I-74 WB)
STAGE 3-1
STA. 141+600.000 - STA. 141+950.000

DATE 11/12/04
DRAWN BY CADD
CHECKED BY KJW