

F.A. RTE.	SECTION	COUNTY	TOTAL SHEETS	SHEET NO.
74	(72-71R-3	PEORIA	1360	110
STA. 141+400.000		TO STA. 142+000.000		
FED. ROAD DIST. NO.		ILLINOIS FED. AID PROJECT		

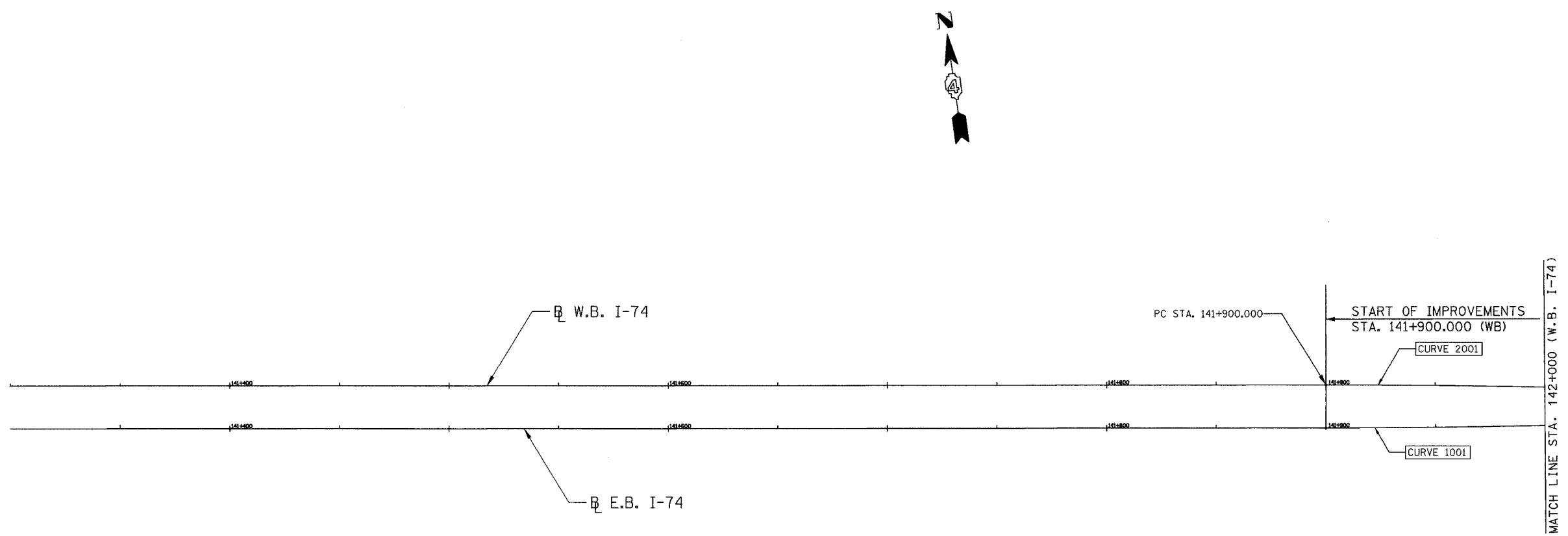

PROPOSED CURVE DATA		
CURVE NO.	1001	2001
ALIGNMENT	E.B. I-74	W.B. I-74
DESIGN SPEED	110 KM/H	110 KM/H
P.I. STA	142+005.761	141+693.587
R	5000.000m	5000.000m
T	150.761m	63.473m
L	211.491m	126.940m
E	1.118m	0.403m
S.E.	N.C.	N.C.
TRANSITION IN	N/A	N/A
TRANSITION OUT	N/A	N/A
P.C. STA	141+900.000	141+900.113
P.T. STA	142+111.491	142+027.053

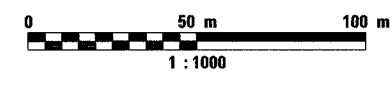

REVISIONS	
NAME	DATE

ILLINOIS DEPARTMENT OF TRANSPORTATION  
**SCHEMATIC DRAWING**  
 FAI ROUTE 74 (I-74) (WB)  
 STA. 141+400 TO STA. 142+000  
 DRAWN BY CADD  
 CHECKED BY KJW  
 DATE 11/12/04