

F.A.P. RTE.	SECTION	COUNTY	TOTAL SHEETS	SHEET NO.
317	*	LIVINGSTON	205	198
STA. 352+50.00		TO STA. 353+00.00		
CONTRACT NO. 66261				
* 25 RS-2 & 26 RS-4				

FINAL SURVEY BY: _____ DATE: _____
 SURVEYED BY: _____
 PLOTTED BY: _____
 NOTE BOOK NO. _____
 AREAS CHECKED: _____

ORIGINAL SURVEY BY: _____ DATE: _____
 SURVEYED BY: _____
 PLOTTED BY: _____
 NOTE BOOK NO. _____
 AREAS CHECKED: _____

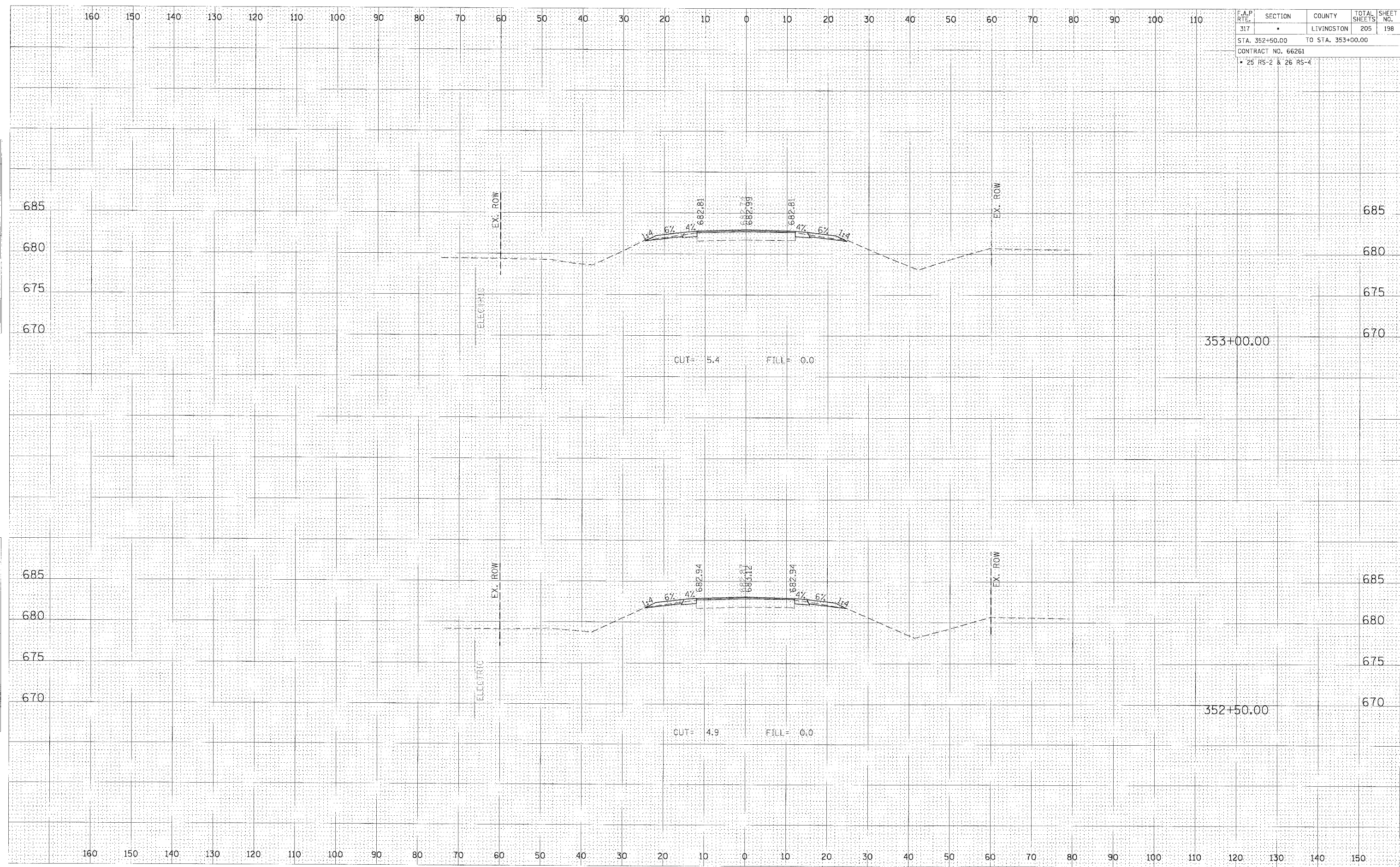

CROSS SECTION, STA 352+50.00 TO 353+00.00, FAP 317 (US ROUTE 24)