

F.A.P. RTE.	SECTION	COUNTY	TOTAL SHEETS	SHEET NO.
317	-	LIVINGSTON	205	184
STA. 338+50.00		TO STA. 339+00.00		
CONTRACT NO. 66261				
• 25 RS-2 & 26 RS-4				

DATE: _____
 BY: _____
 CHECKED: _____
 NO. _____

DATE: _____
 BY: _____
 CHECKED: _____
 NO. _____

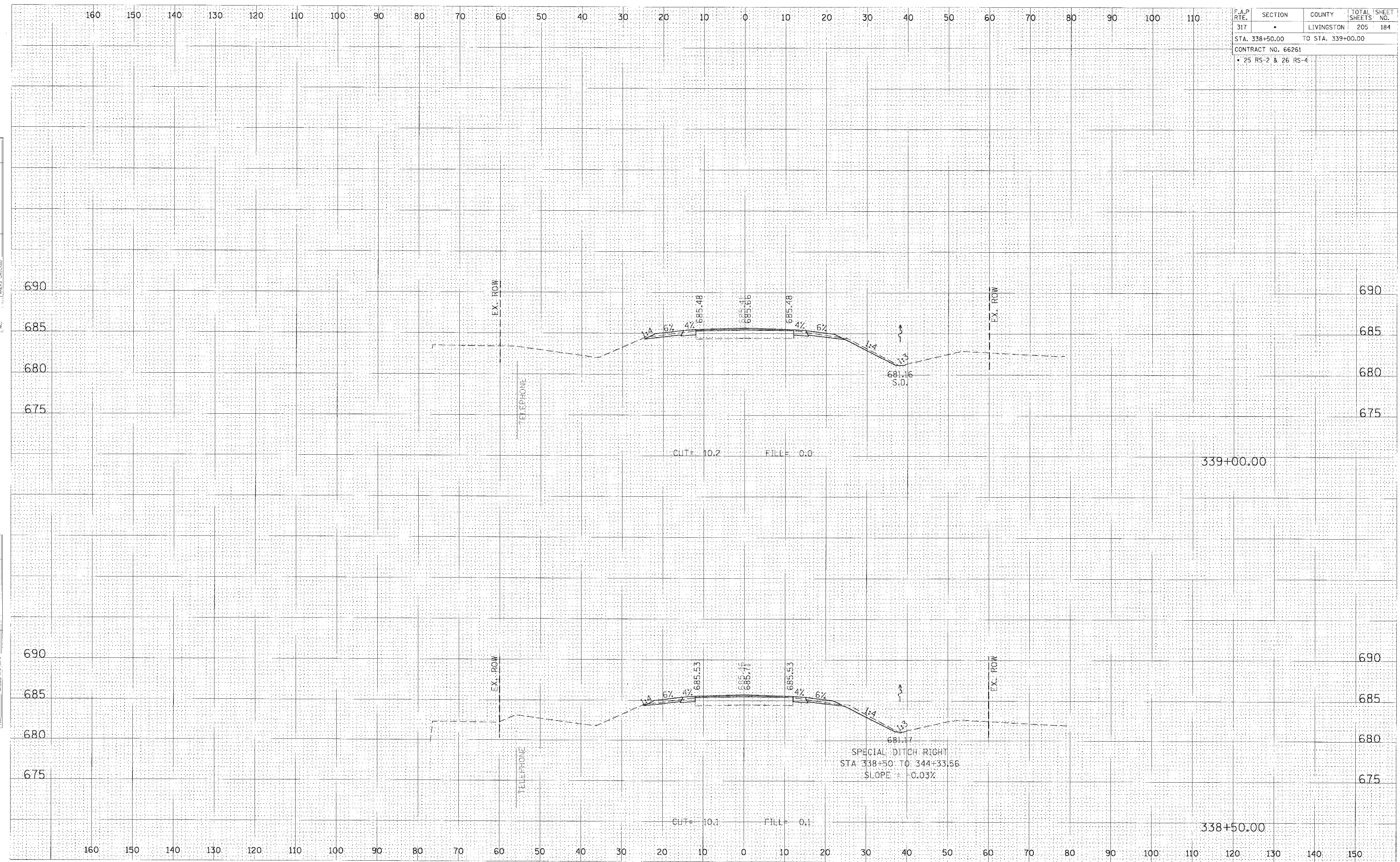

CROSS SECTION, STA 338+50.00 TO 339+00.00, FAP 317 (US ROUTE 24)