

F.A.P. RTE.	SECTION	COUNTY	TOTAL SHEETS	SHEET NO.
317	*	LIVINGSTON	205	156
STA. 313+00.00		TO STA. 313+50.00		
CONTRACT NO. 66261				
• 25 RS-2 & 26 RS-4				

FINAL SURVEY BY DATE  
 SURVEYED BY DATE  
 PLANNED BY DATE  
 NOTE BOOK NO.  
 AREAS CHECKED

ORIGINAL SURVEY BY DATE  
 SURVEYED BY DATE  
 PLANNED BY DATE  
 NOTE BOOK NO.  
 AREAS CHECKED

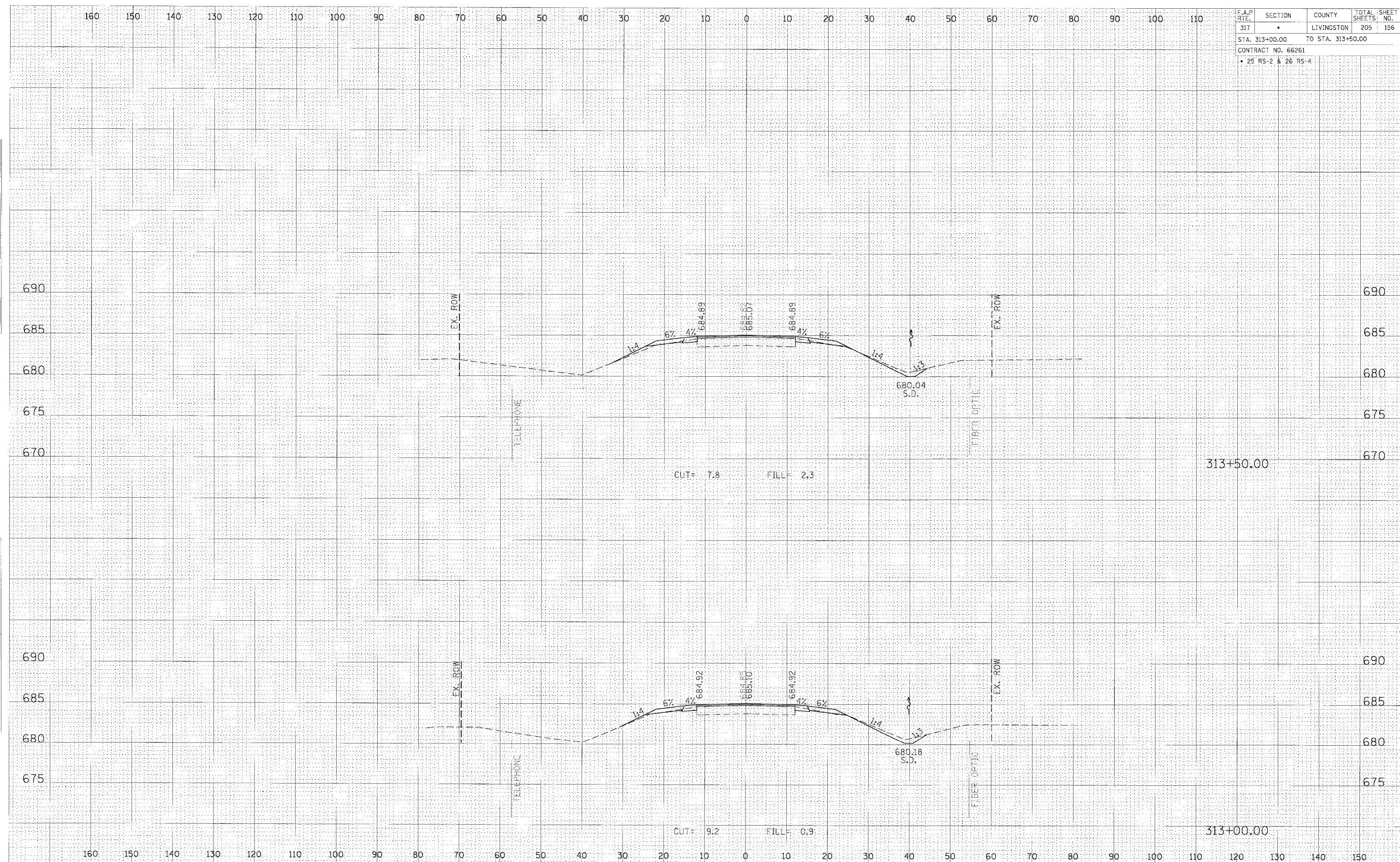

CROSS SECTION, STA 313+00.00 TO 313+50.00, FAP 317 (US ROUTE 24)