

F.A.P. RTE.	SECTION	COUNTY	TOTAL SHEETS	SHEET NO.
317	•	LIVINGSTON	205	154
STA. 311+10.39		TO STA. 311+40.00		
CONTRACT NO. 66261				
• 25 RS-2 & 26 RS-4				

FINAL SURVEY	SURVEYED	DATE
NOTE BOOK	PLOTTED	
NO.	TEMPLATE	
	AREAS CHECKED	

ORIGINAL SURVEY	SURVEYED	DATE
NOTE BOOK	PLOTTED	
NO.	TEMPLATE	
	AREAS CHECKED	

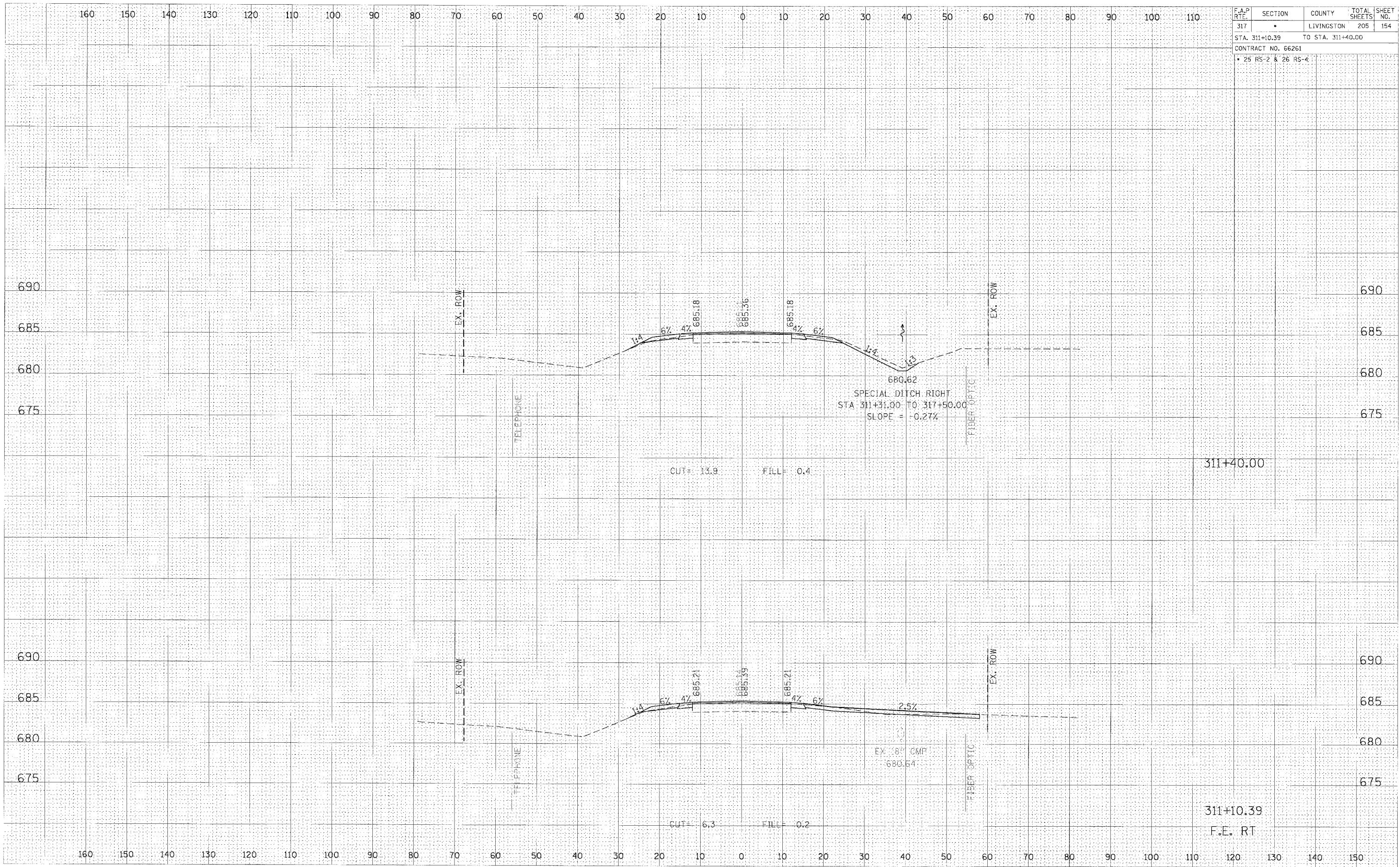

CROSS SECTION, STA 311+10.39 TO 311+40.00, FAP 317 (US ROUTE 24)