

F.A.P. RTE.	SECTION	COUNTY	TOTAL SHEETS	SHEET NO.
317	*	LIVINGSTON	205	120
STA. 282+00.00 TO STA. 282+50.00				
CONTRACT NO. 66261				
* 25 RS-2 & 26 RS-4				

DATE	BY

DATE	BY

DATE	BY

DATE	BY

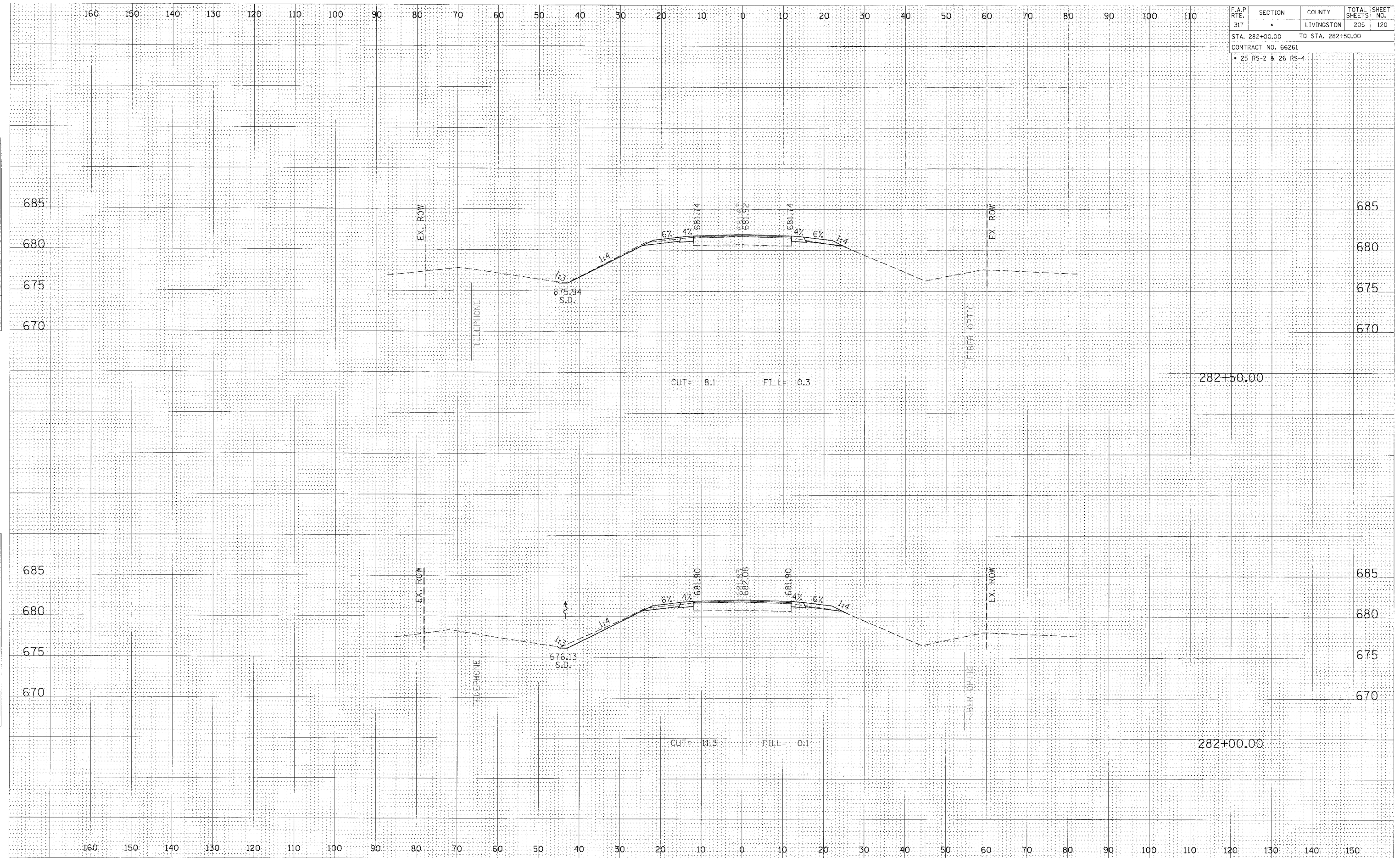

CROSS SECTION, STA 282+00.00 TO 282+50.00, FAP 317 (US ROUTE 24)