

F.A.P. RTE.	SECTION	COUNTY	TOTAL SHEETS	SHEET NO.
317	*	LIVINGSTON	205	100
STA. 264+00.00		TO STA. 264+50.00		
CONTRACT NO. 66261				
* 25 RS-2 & 26 RS-4				

BY	DATE
DESIGNED	
CHECKED	
PLOTTED	
NOTED	
AREAS CHECKED	

BY	DATE
DESIGNED	
CHECKED	
PLOTTED	
NOTED	
AREAS CHECKED	

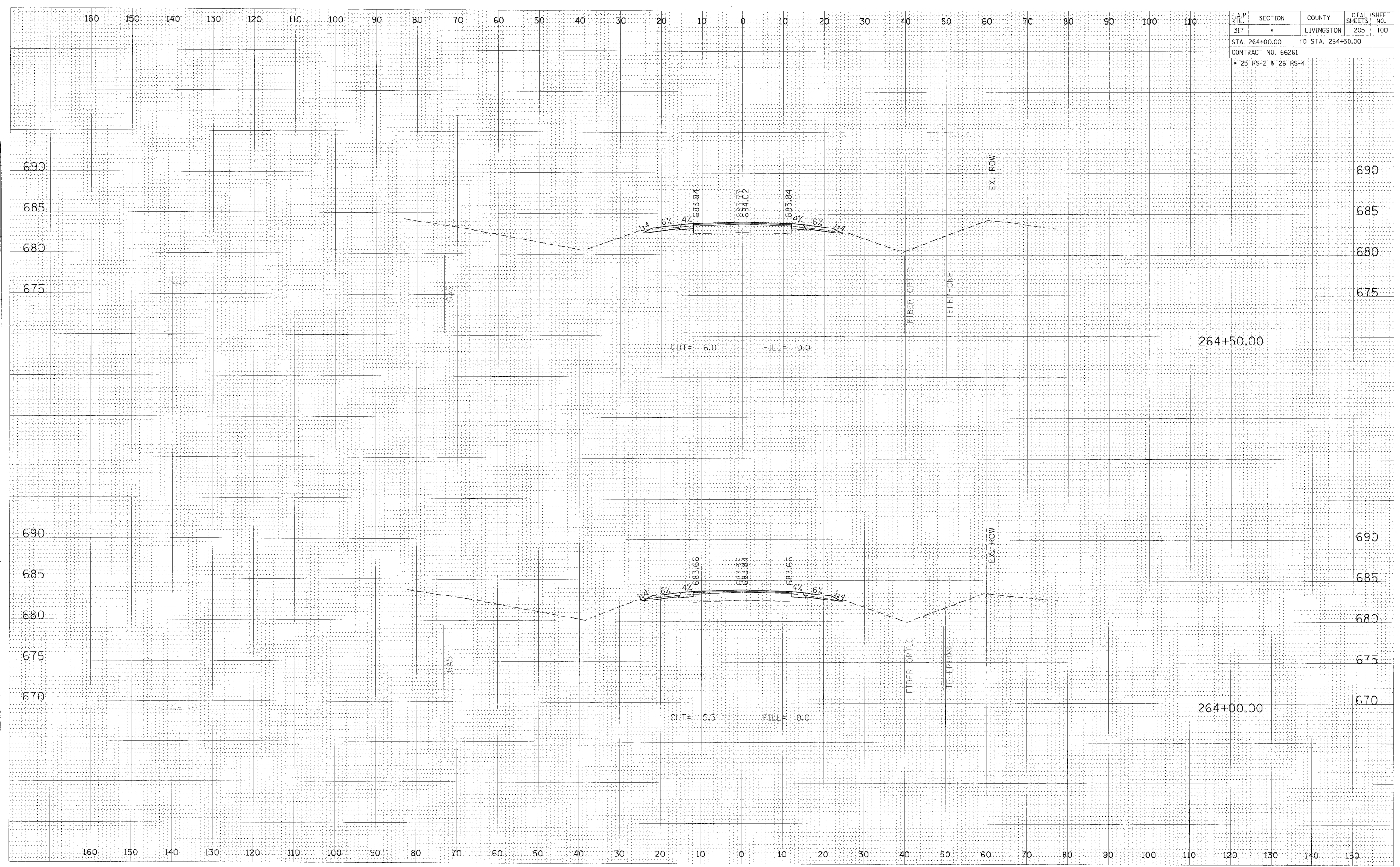

CROSS SECTION, STA 264+00.00 TO 264+50.00, FAP 317 (US ROUTE 24)