

F.A.P. RTE.	SECTION	COUNTY	TOTAL SHEETS	SHEET NO.
317	*	LIVINGSTON	205	93
STA. 257+00.00 TO STA. 257+50.0				
CONTRACT NO. 66261				
* 25 RS-2 & 26 RS-4				

FINAL SURVEY	SURVEYED	PLOTTED	DATE
NO. E. BOOK	NO. E. BOOK	NO. E. BOOK	NO. E. BOOK
NO.	NO.	NO.	NO.

ORIGINAL SURVEY	SURVEYED	PLOTTED	DATE
NO. E. BOOK	NO. E. BOOK	NO. E. BOOK	NO. E. BOOK
NO.	NO.	NO.	NO.

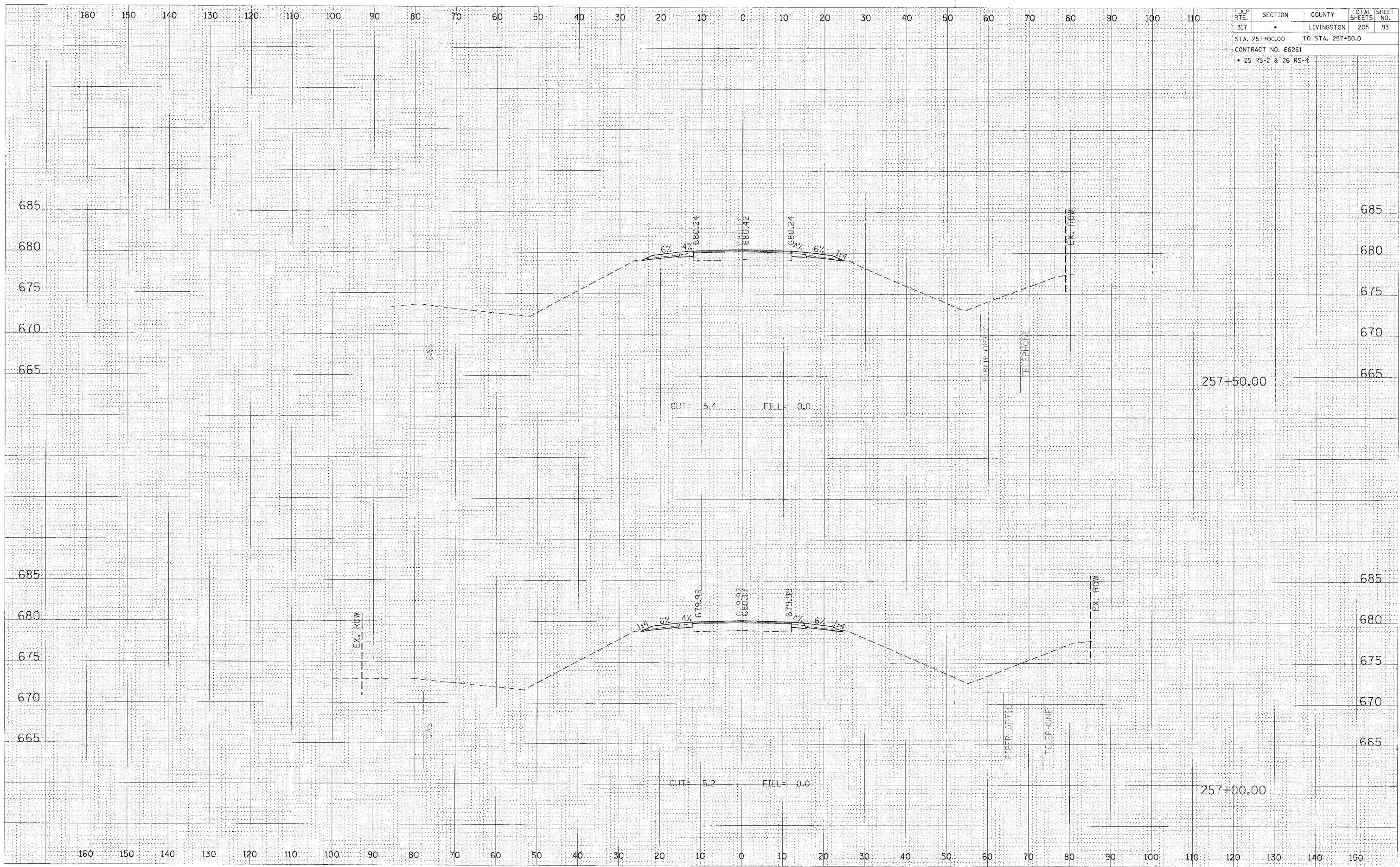

CROSS SECTION, STA 257+00.00 TO 257+50.00, FAP 317 (US ROUTE 24)