

F.A.P. RTE.	SECTION	COUNTY	TOTAL SHEETS	SHEET NO.
317	*	LIVINGSTON	205	92
STA. 256+06.30		TO STA. 265+50.00		
CONTRACT NO. 66261				
* 25 RS-2 & 26 RS-4				

FINAL SURVEY
 SURVEY PLOTTED
 NOTE BOOK
 NO.

ORIGINAL SURVEY
 SURVEY PLOTTED
 NOTE BOOK
 NO.

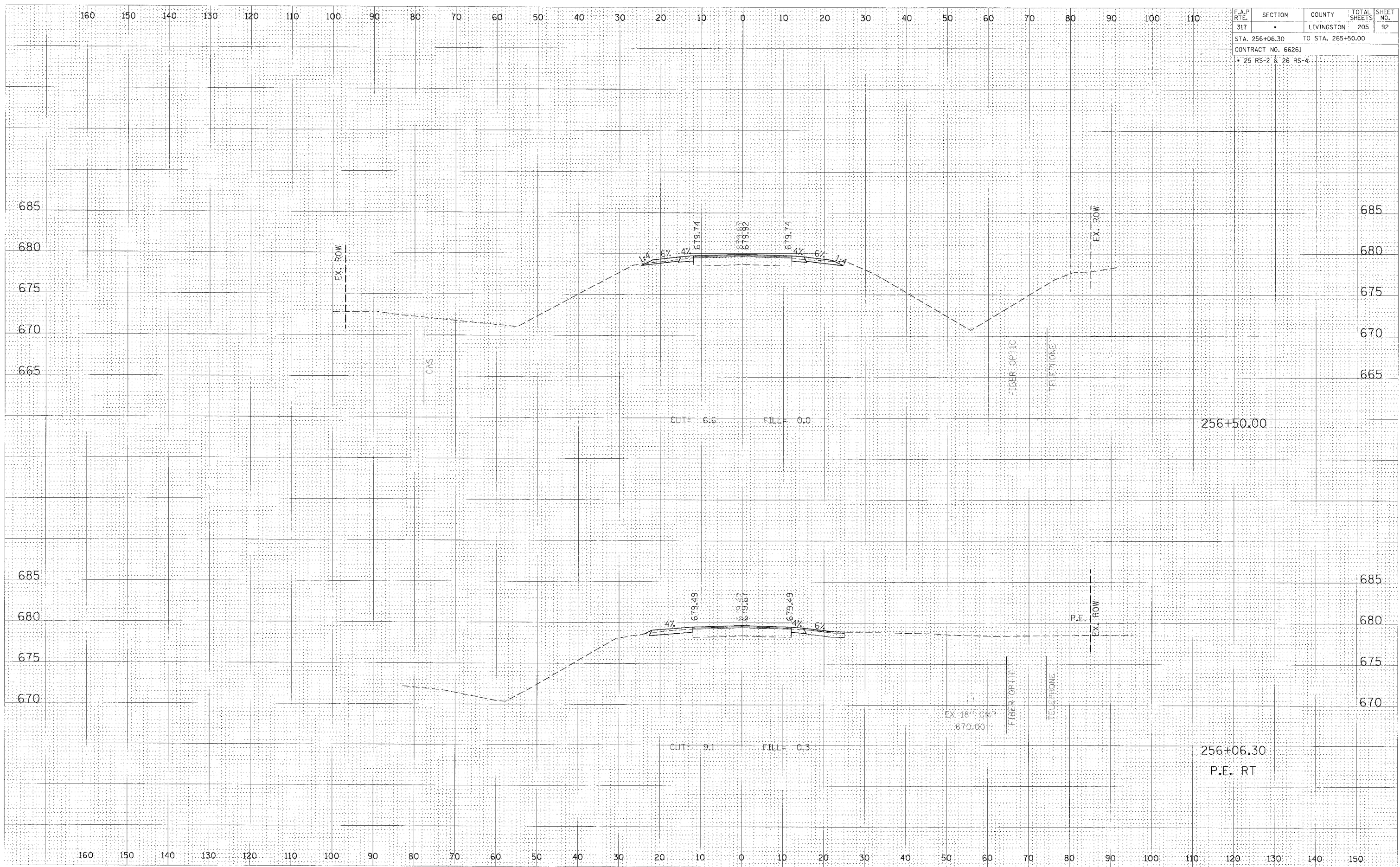

CROSS SECTION, STA 256+06.30 TO 256+50.00, FAP 317 (US ROUTE 24)