

F.A.P. RTE.	SECTION	COUNTY	TOTAL SHEETS	SHEET NO.
317	*	LIVINGSTON	205	90
STA. 254+00.00		TO STA. 254+50.00		
CONTRACT NO. 66261				
* 25 RS-2 & 26 RS-4				

DATE: \_\_\_\_\_ BY: \_\_\_\_\_  
 SURVEYED: \_\_\_\_\_ PLOTTED: \_\_\_\_\_  
 NOTE BOOK: \_\_\_\_\_ AREA: \_\_\_\_\_  
 NO. \_\_\_\_\_ AREA CHECKED: \_\_\_\_\_

DATE: \_\_\_\_\_ BY: \_\_\_\_\_  
 SURVEYED: \_\_\_\_\_ PLOTTED: \_\_\_\_\_  
 NOTE BOOK: \_\_\_\_\_ AREA: \_\_\_\_\_  
 NO. \_\_\_\_\_ AREA CHECKED: \_\_\_\_\_

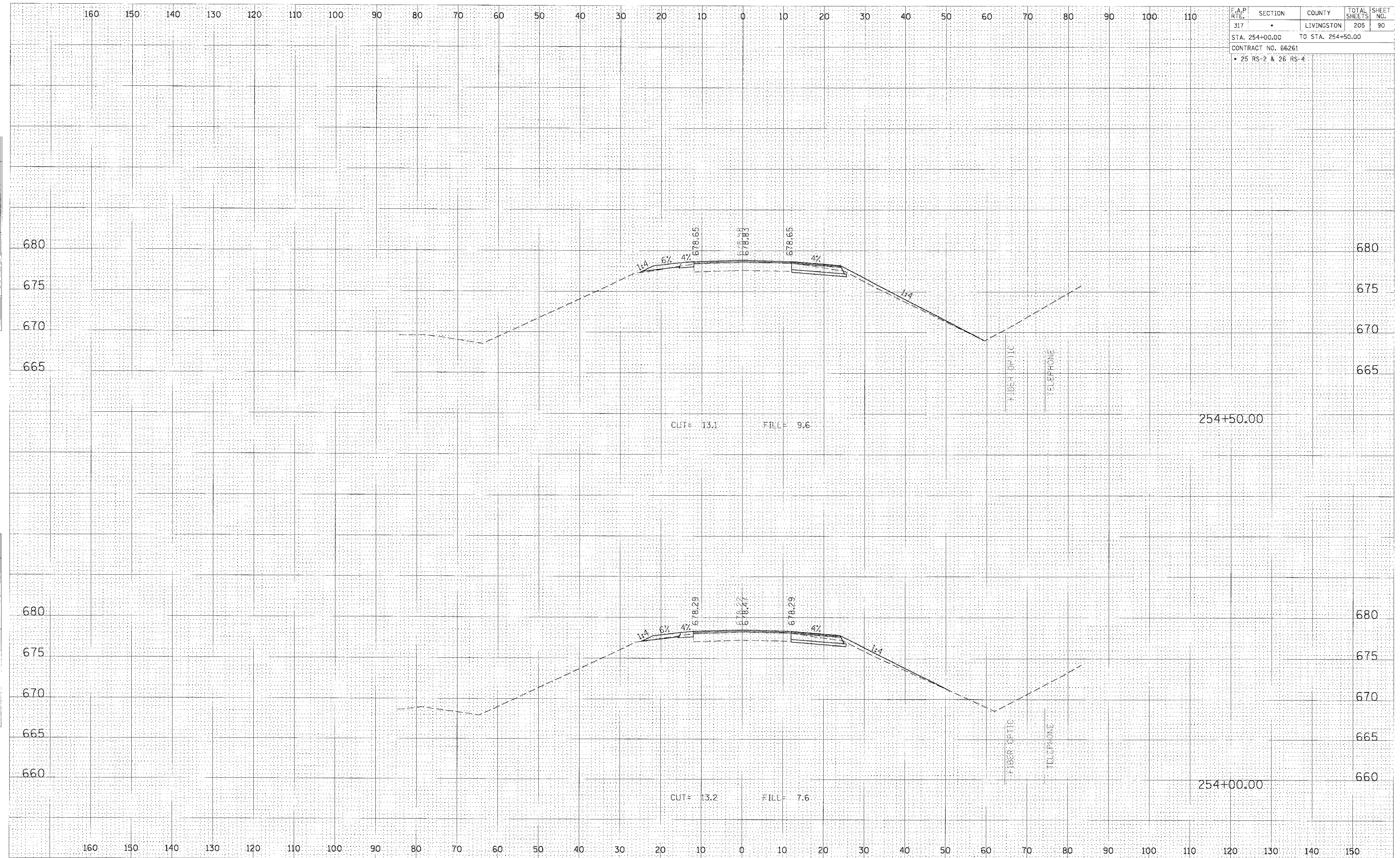

CUT= 13.1

FILL= 9.6

254+50.00

CUT= 13.2

FILL= 7.6

254+00.00

CROSS SECTION, STA 254+00.00 TO 254+50.00, FAP 317 (US ROUTE 24)