

F.A.P. RTE.	SECTION	COUNTY	TOTAL SHEETS	SHEET NO.
317	•	LIVINGSTON	205	88
STA. 252+00.00		TO STA. 252+50.00		
CONTRACT NO. 66261				
• 25 RS-2 & 26 RS-4				

DATE	
BY	
FINAL SURVEY	
PLOTTED	
NOTE BOOK	
NO.	
AREAS CHECKED	

DATE	
BY	
ORIGINAL SURVEY	
PLOTTED	
NOTE BOOK	
NO.	
AREAS CHECKED	

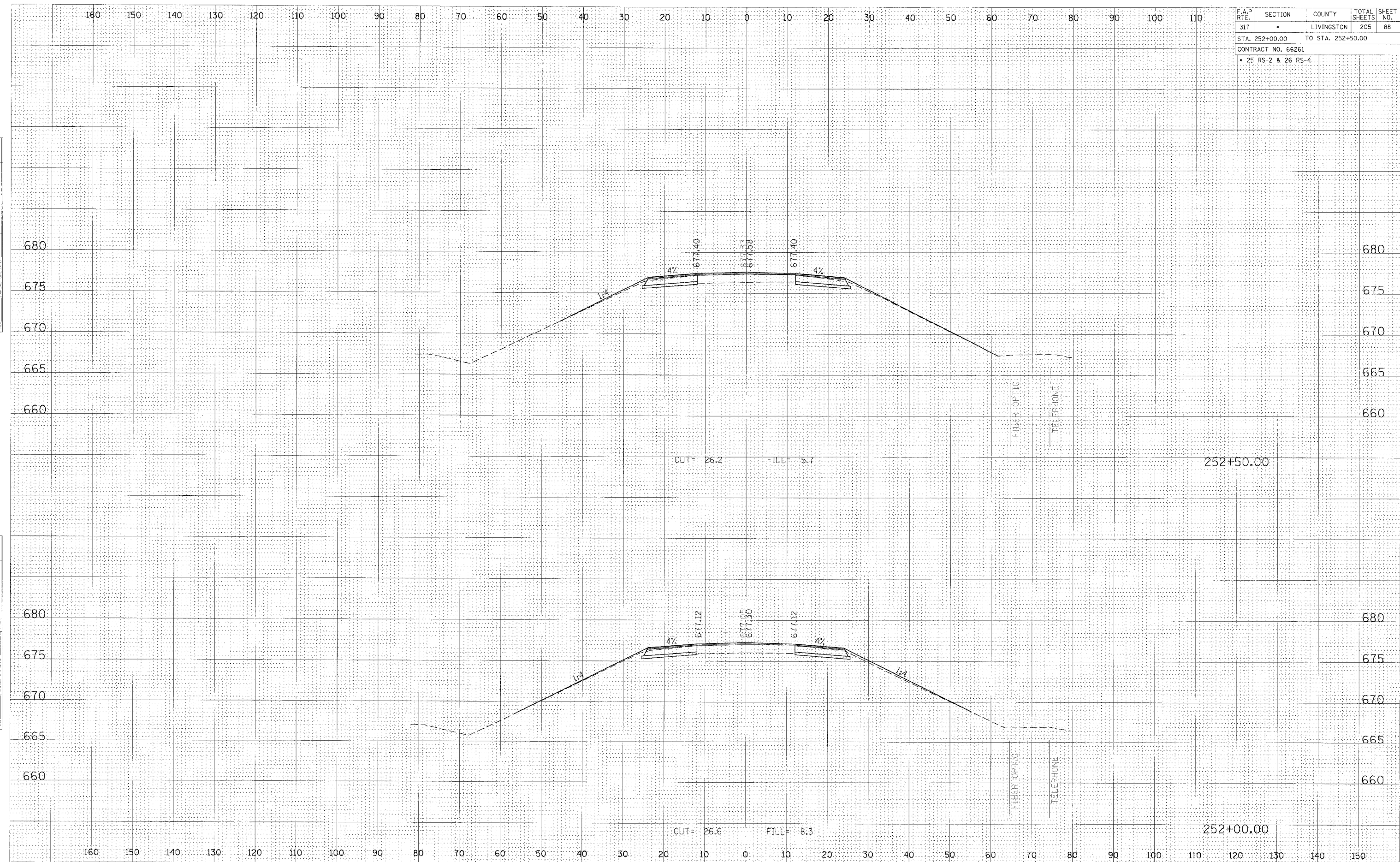

CROSS SECTION, STA 252+00.00 TO 252+50.00, FAP 317 (US ROUTE 24)