

F.A.P. RTE.	SECTION	COUNTY	TOTAL SHEETS	SHEET NO.
317	•	LIVINGSTON	205	83
STA. 247+50.00		TO STA. 248+00.00		
CONTRACT NO. 66261				
• 25 RS-2 & 26 RS-4				

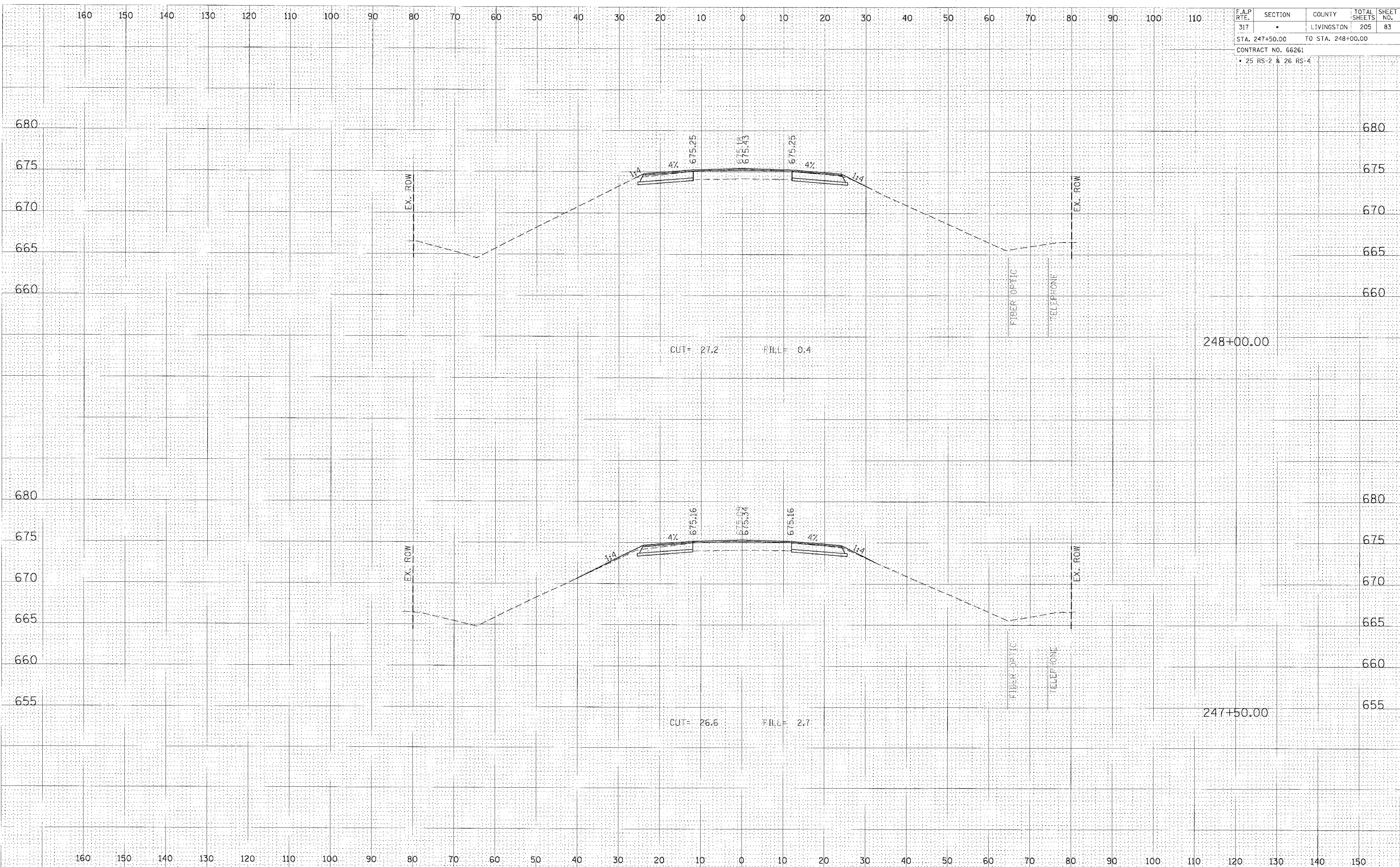

DATE: _____
 BY: _____
 SURVEYED FROM _____
 PLOTTED DATE: _____
 NOTE BOOK NO. _____
 AREAS CHECKED: _____

DATE: _____
 BY: _____
 SURVEYED FROM _____
 PLOTTED DATE: _____
 NOTE BOOK NO. _____
 AREAS CHECKED: _____

CROSS SECTION, STA 247+50.00 TO 248+00.00, FAP 317 (US ROUTE 24)