

F.A.P. RTE.	SECTION	COUNTY	TOTAL SHEETS	SHEET NO.
317	*	LIVINGSTON	205	77
STA. 241+50.00		TO STA. 242+00.00		
CONTRACT NO. 66261				
* 25 RS-2 & 26 RS-4				

DATE	BY
NO. _____	NO. _____
ORIGINAL SURVEY	SURVEYED
NOTE BOOK	PLOTTED
NO. _____	TEMPLATE
	AREAS CHECKED

DATE	BY
NO. _____	NO. _____
ORIGINAL SURVEY	SURVEYED
NOTE BOOK	PLOTTED
NO. _____	TEMPLATE
	AREAS CHECKED

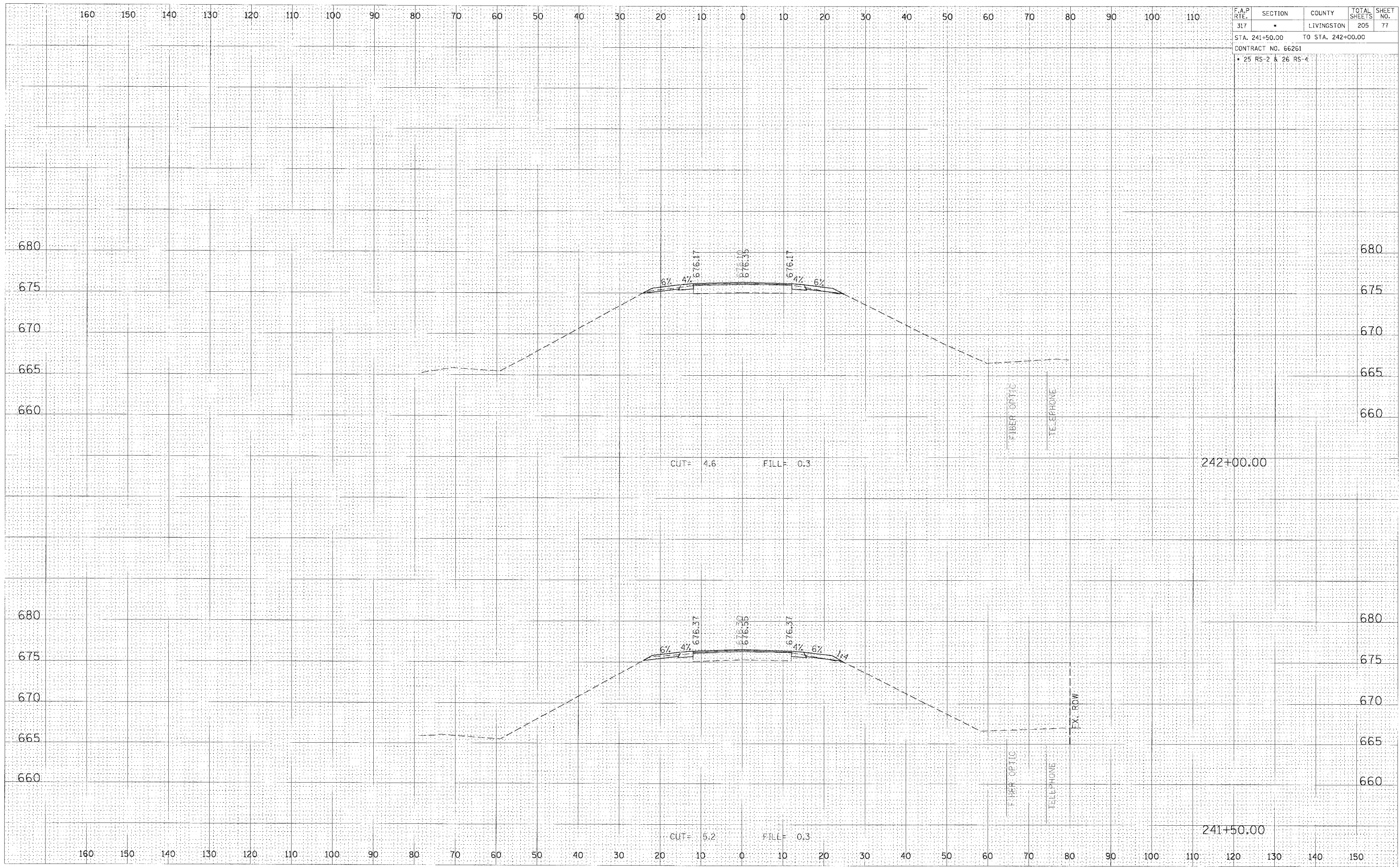

CROSS SECTION, STA 241+50.00 TO 242+00.00, FAP 317 (US ROUTE 24)