

F.A.P. RTE.	SECTION	COUNTY	TOTAL SHEETS	SHEET NO.
317	*	LIVINGSTON	205	73
STA. 236+50.00 TO STA. 237+00.00				
CONTRACT NO. 66261				
• 25 RS-2 & 26 RS-4				

BY	DATE

BY	DATE

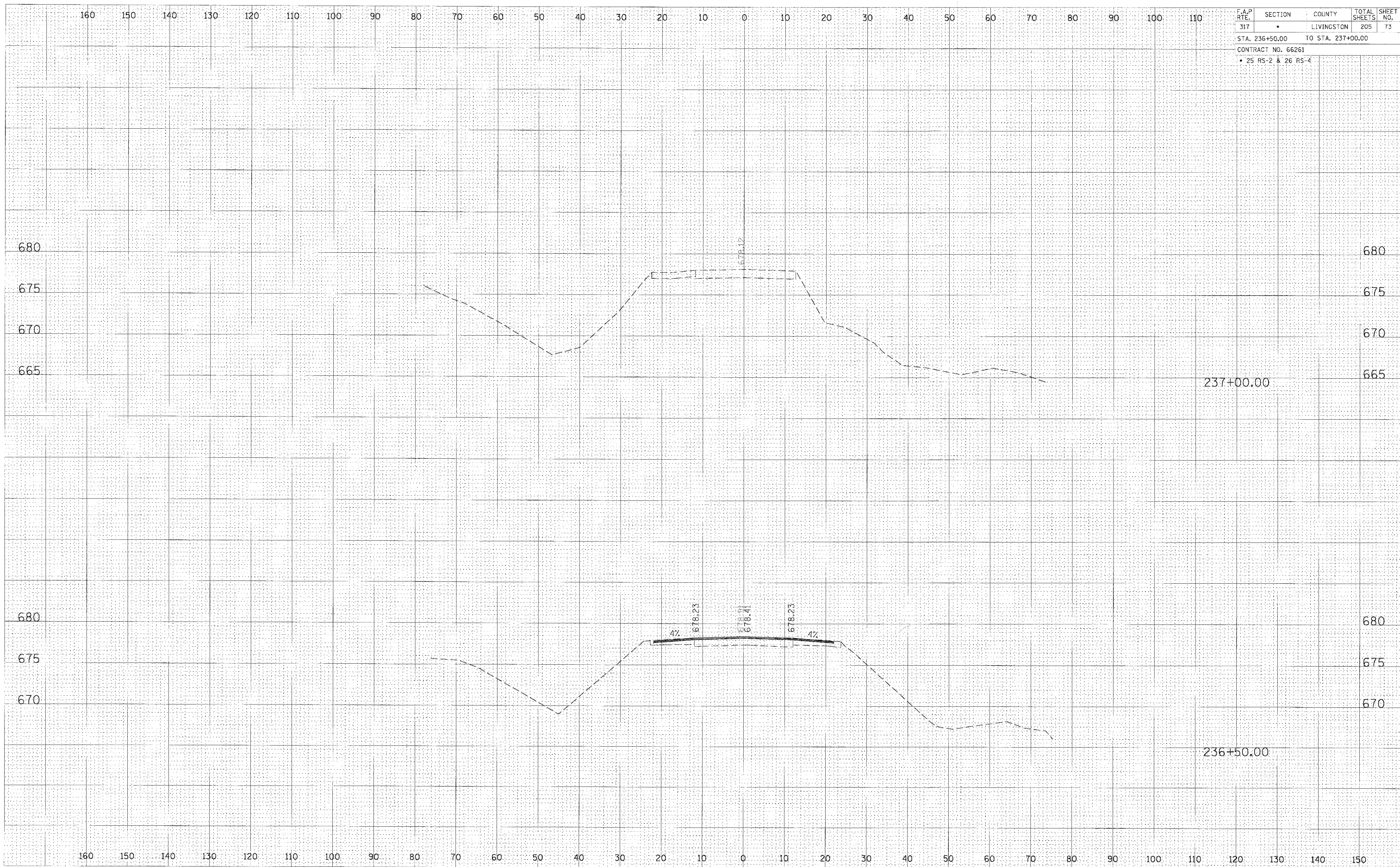

CROSS SECTION, STA 236+50.00 TO 237+00.00, FAP 317 (US ROUTE 24)