

F.A.P. RTE.	SECTION	COUNTY	TOTAL SHEETS	SHEET NO.
317		LIVINGSTON	205	67

STA. 232+00.00 TO STA. 232+25.00  
 CONTRACT NO. 66261  
 • 25 RS-2 & 26 RS-4

DATE	
BY	
FINAL SURVEY	
INLINED	
NOTED	
NO. OF PAGES	
NO.	

DATE	
BY	
ORIGINAL SURVEY	
INLINED	
NOTED	
NO. OF PAGES	
NO.	

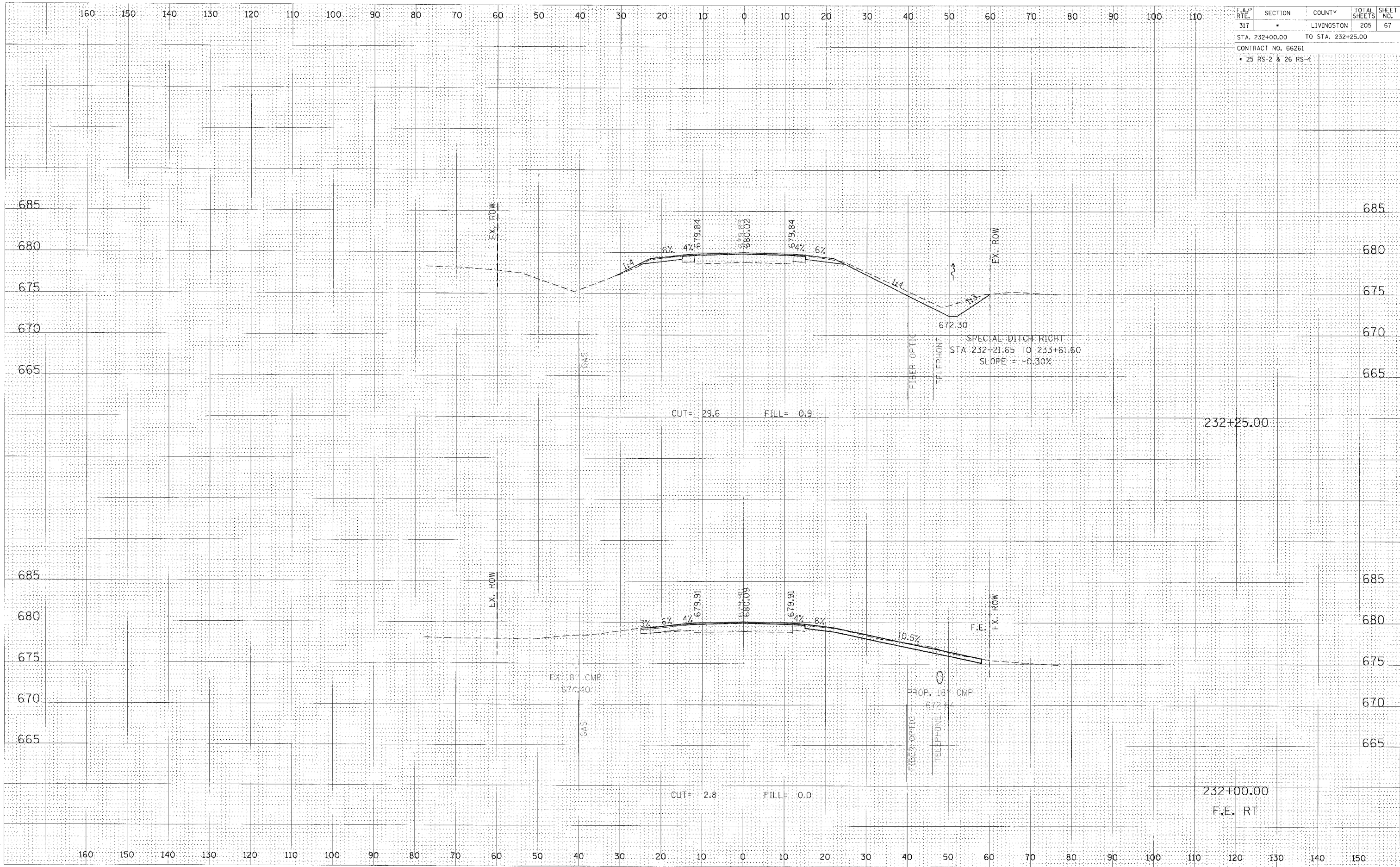

CROSS SECTION, STA 232+00.00 TO 232+25.00, FAP 317 (US ROUTE 24)