

F.A.P. RTE.	SECTION	COUNTY	TOTAL SHEETS	SHEET NO.
317		LIVINGSTON	205	61
STA. 229+50.00		TO STA. 229+55.00		
CONTRACT NO. 66261				
• 25 RS-2 & 26 RS-4				

BY	DATE
FINAL SURVEYED	
SUPPLY PLOTTED	
NOTE BOOK	
AREAS CHECKED	
NO.	

BY	DATE
ORIGINAL SURVEYED	
PLOTTED	
NOTE BOOK	
AREAS CHECKED	
NO.	

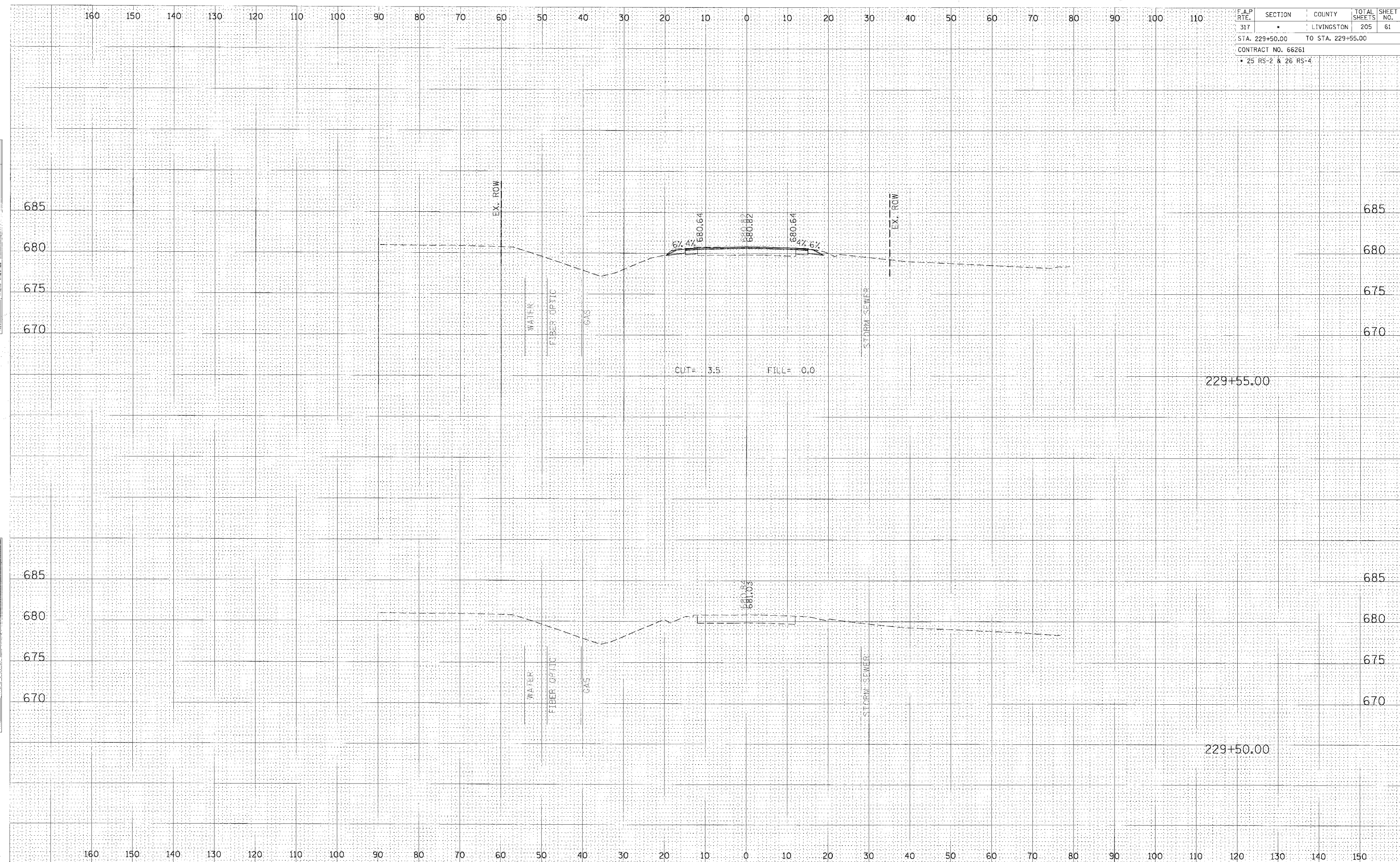

CROSS SECTION, STA 229+50.00 TO 229+55.00, FAP 317 (US ROUTE 24)