

F.A.P. RTE.	SECTION	COUNTY	TOTAL SHEETS	SHEET NO.
317		LIVINGSTON	205	40
STA.	TO STA.			
CONTRACT NO. 66261				
• 25 RS-2 & 26 RS-4				

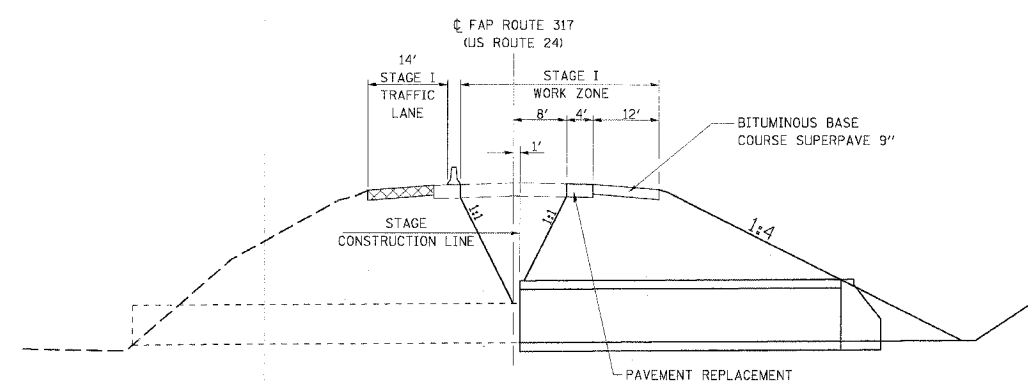
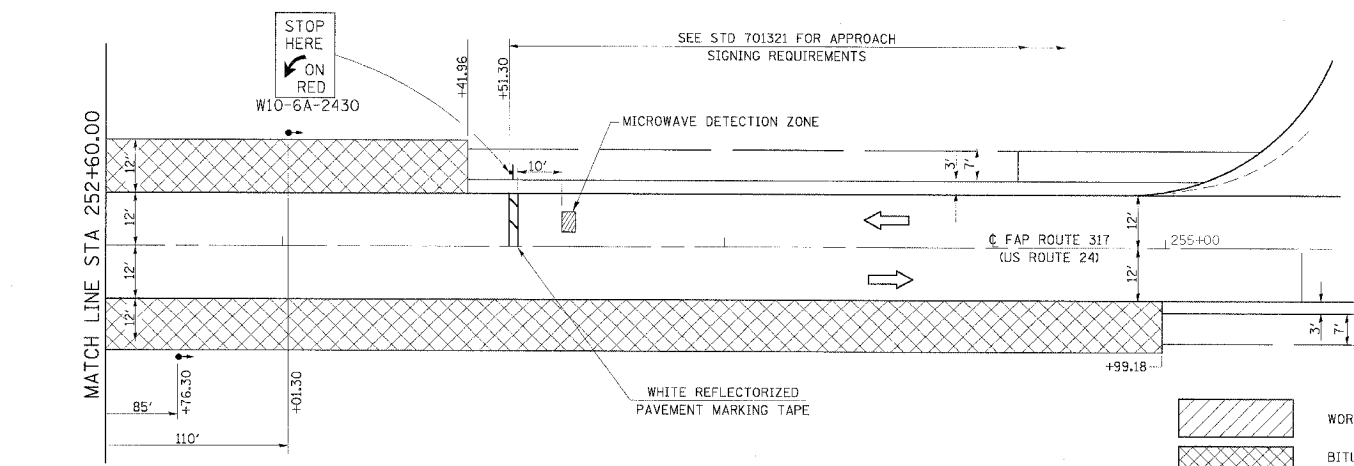
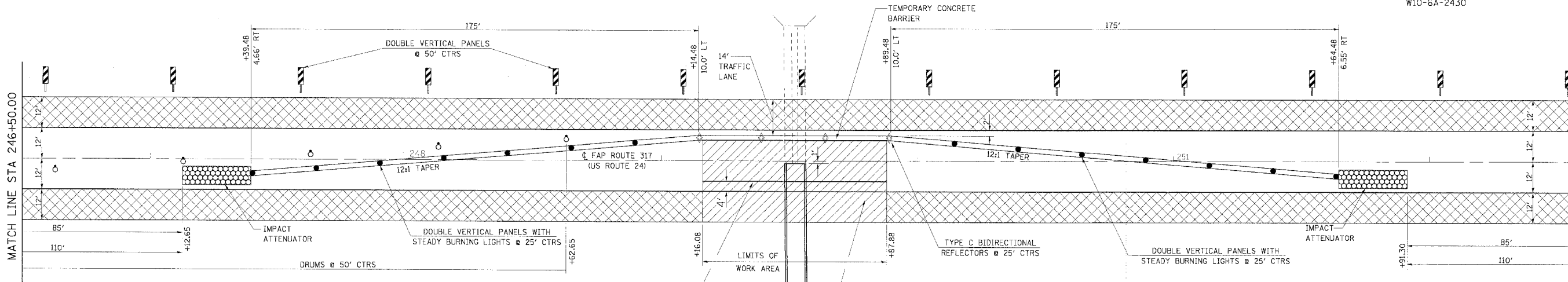
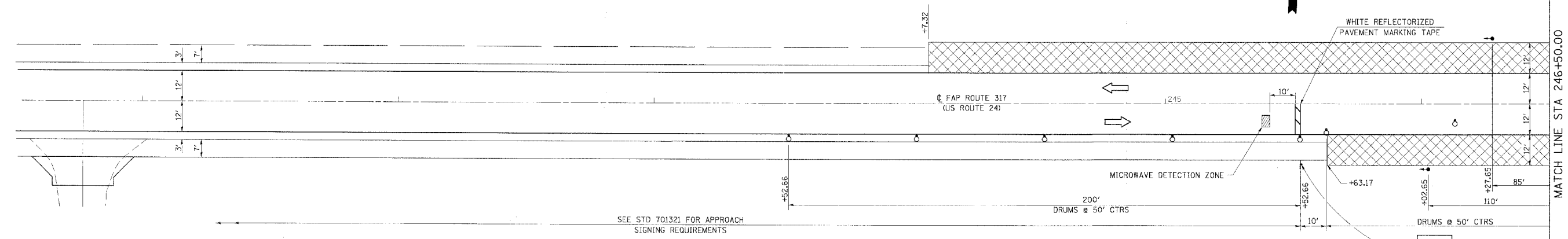

LEGEND

- WORK AREA
- BITUMINOUS BASE COURSE SUPERPAVE 9" TO BE COMPLETED BEFORE STAGE I
- SIGN
- DRUM WITH STEADY BURNING LIGHT
- TRAFFIC SIGNAL
- IMPACT ATTENUATOR
- DOUBLE VERTICAL PANELS
- TYPE C BIDIRECTIONAL REFLECTOR
- STEADY BURNING LIGHTS AND DOUBLE VERTICAL PANELS

REVISIONS	
NAME	DATE

ILLINOIS DEPARTMENT OF TRANSPORTATION
TRAFFIC CONTROL AND PROTECTION, STAGE I
 FAP 317 (US ROUTE 24)
 SECTION 25 RS-2 & 26 RS-4
 LIVINGSTON COUNTY
 SCALE: _____
 DATE _____
 DRAWN BY BANDY
 CHECKED BY STELIART