

F.A.P. RTE.	SECTION	COUNTY	TOTAL SHEETS	SHEET NO.
333/336	2004-110RS	MCHENRY	18	1

STATE OF ILLINOIS
DEPARTMENT OF TRANSPORTATION
DIVISION OF HIGHWAYS
PROPOSED
HIGHWAY PLANS

FOR INDEX OF SHEETS, SEE SHEET NO. 2

TRAFFIC DATA

LOCATION 1:
ADT = 24,000 (2003)
SPEED LIMIT = 30 MPH

LOCATION 2:
ADT = 19,900 (2003)
SPEED LIMIT = 35 MPH

LOCATION 1: F.A.P ROUTE 336: IL 31 (RICHMOND ROAD)
NORTH OF IL 120
LOCATION 2: F.A.P ROUTE 333: IL 120 (ELM STREET)
EAST OF FOX RIVER
SECTION: 2004-110RS
RESURFACING
MCHENRY COUNTY
C-91-030-05

IMPROVEMENT LOCATED IN THE CITY OF MCHENRY

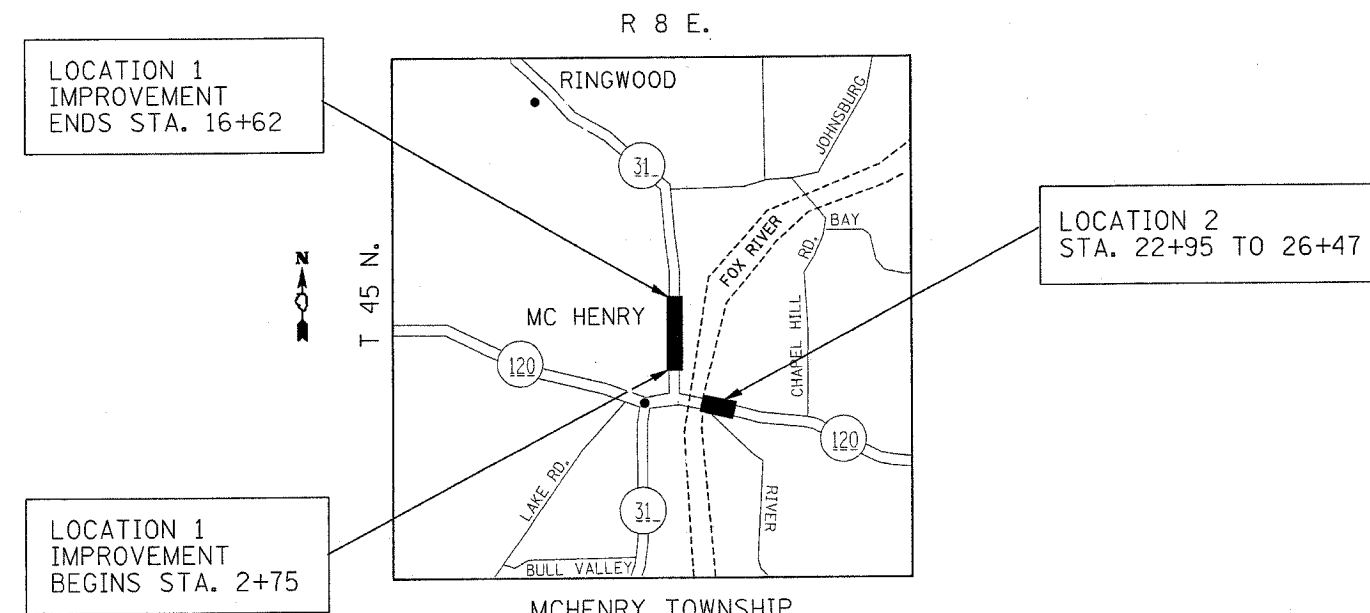
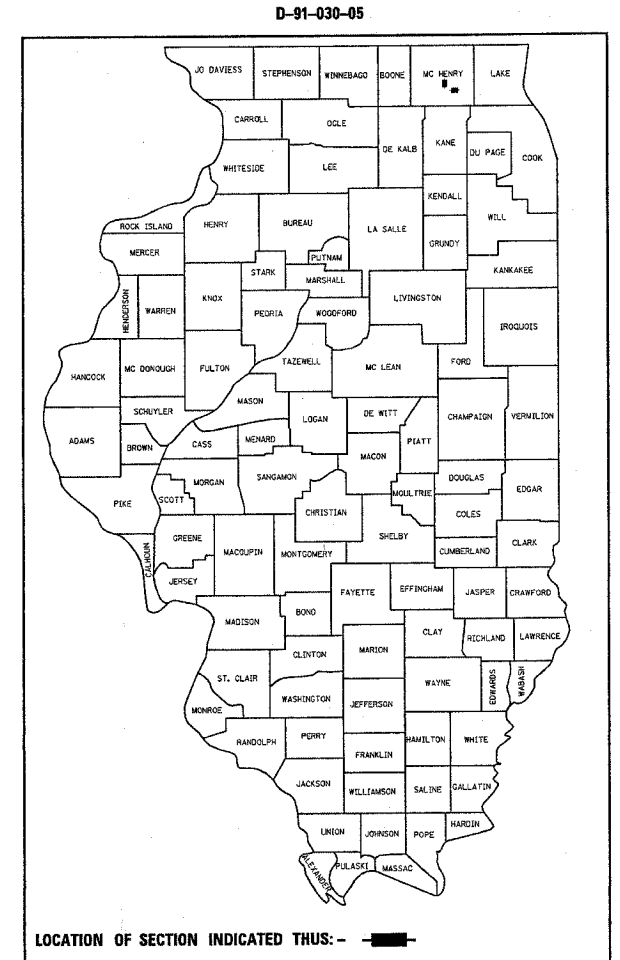

GROSS LENGTH OF IMPROVEMENT
 LOCATION 1: 1387 FT = 0.263 MI.
 LOCATION 2: 472 FT = 0.089 MI.
 TOTAL = 1859 FT = 0.352 MI.

NET LENGTH OF IMPROVEMENT
 LOCATION 1: 1387 FT = 0.283 MI.
 LOCATION 2: 472 FT = 0.089 MI.
 TOTAL = 1859 FT = 0.352 MI.

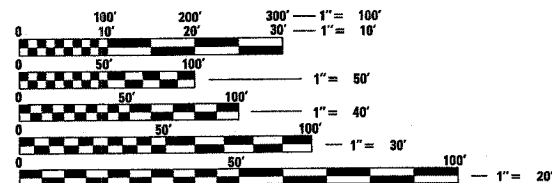

FULL SIZE PLANS HAVE BEEN PREPARED USING STANDARD ENGINEERING SCALES. REDUCED SIZED PLANS WILL NOT CONFORM TO STANDARD SCALES. IN MAKING MEASUREMENTS ON REDUCED PLANS, THE ABOVE SCALES MAY BE USED.

J.U.L.I.E.
 JOINT UTILITY LOCATION INFORMATION FOR EXCAVATION
 1-800-892-0123

CONTRACT NO. 62855

STATE OF ILLINOIS
 DEPARTMENT OF TRANSPORTATION
 DIVISION OF HIGHWAYS

SUBMITTED February 18, 20 05
Dina O'Keefe/AP
 DEPUTY DIRECTOR OF HIGHWAYS, REGION ENGINEER

March 25, 20 05
Mike Hine/ED
 ENGINEER OF DESIGN AND ENVIRONMENT

March 25, 20 05
Victor Mader/ED
 DIRECTOR OF HIGHWAYS, CHIEF ENGINEER

PRINTED BY THE AUTHORITY OF THE STATE OF ILLINOIS

DISTRICT ONE DESIGN PLAN PREPARATION ENGINEER K. ENG/R. BORO (847) 705-4178