

STATE OF ILLINOIS
DEPARTMENT OF TRANSPORTATION

F.A.P. RTE.	SECTION	COUNTY	TOTAL SHEETS	SHEET NO.
776	102DR-1	HAMILTON	13	1
		ILLINOIS	78991	

FOR INDEX OF SHEETS, SEE SHEET NO. 3
FOR SUMMARY OF QUANTITIES, SEE SHEET NO. 4

**PROPOSED
HIGHWAY PLANS**

FAP ROUTE 776 (IL 242)
SECTION 102DR-1
CHANNEL MAINTENANCE
HAMILTON COUNTY

TRAFFIC DATA

2021 ADT = 1250
WITH 17% TRUCKS

TOWNSHIPS

SOUTH CROUCH

IMPROVEMENT LOCATION
DITCH NORTH BLAIRSVILLE RD.
STA 759+02 - STA 765+44

COORDINATE SYSTEM : STATE PLANE ZONE - ILLINOIS EAST
POSTED SPEED : 55 MPH

J.U.L.I.E.
JOINT UTILITY LOCATION INFORMATION FOR EXCAVATION
1-800-892-0123
OR 811

PROJECT ENGINEER: GRANT DETERDING
PROJECT DESIGNER: ZACH LOMAX

CONTRACT NO. 78991



C-99-038-23

RANGE 6E

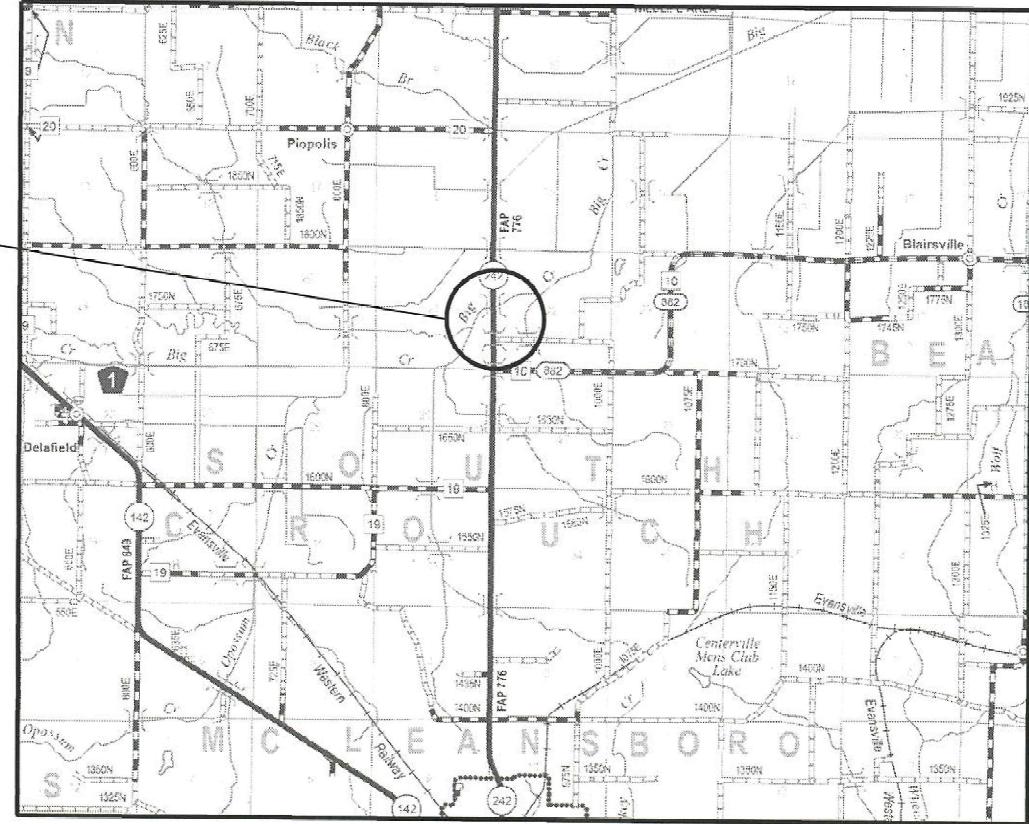

GROSS LENGTH = 642.0 FT. = 0.123 MILES
NET LENGTH = 642.0 FT. = 0.123 MILES

D-99-025-23



LOCATION OF SECTION INDICATED THUS: - [black rectangle] -

STATE OF ILLINOIS
DEPARTMENT OF TRANSPORTATION

SUBMITTED Jan 11 20 23
Kirk H. Brown
REGION FIVE ENGINEER

March 24, 2023
[Signature]
ENGINEER OF DESIGN AND ENVIRONMENT

March 24, 2023
[Signature]
DIRECTOR OF HIGHWAYS PROJECT IMPLEMENTATION

PRINTED BY THE AUTHORITY
OF THE STATE OF ILLINOIS

MODEL: Cover Sheet.dwg
FILE NAME: p:\p\lde\paw\lntley\comp\p\DOT\Documents\DOT Offices\District 9\ORD Projects\78991\CAD\Drawings\CAD\Drawings\78991_SMA-Cover_Sig.dgn

Prepared By: Charles Stein
DISTRICT STUDIES & PLANS ENGINEER

Examined By: Nancy Lee
DISTRICT LAND ACQUISITION ENGINEER

Examined By: Con Nelson
DISTRICT PROGRAM DEVELOPMENT ENGINEER

Examined By: [Signature]
DISTRICT OPERATIONS ENGINEER

Examined By: Daryl J. Tuelink
DISTRICT PROJECT IMPLEMENTATION ENGINEER

Examined By: Daryl J. Tuelink
DISTRICT CONSTRUCTION ENGINEER

Examined By: Aam Hayes
DISTRICT MATERIALS ENGINEER

USER NAME = Zachary.Lomax	DESIGNED - _____	REVISED - _____
PLOT SCALE = 0.16666633' / in.	DRAWN - _____	REVISED - _____
PLOT DATE = 1/6/2023	CHECKED - _____	REVISED - _____
	DATE - _____	REVISED - _____

STATE OF ILLINOIS
DEPARTMENT OF TRANSPORTATION

SIGNATURE SHEET

SCALE: _____ SHEET 2 OF 13 SHEETS STA. _____ TO STA. _____

F.A.P. RTE. 776	SECTION 102DR-1	COUNTY HAMILTON	TOTAL SHEETS 13	SHEET NO. 2
CONTRACT NO. 78991				
ILLINOIS FED. AID PROJECT				

INDEX OF SHEETS

1	COVER SHEET
2	SIGNATURES SHEET
3	INDEX OF SHEETS, STANDARDS & GENERAL NOTES
4	SUMMARY OF QUANTITIES
5	GENERAL PLAN
6	RIPRAP DETAIL
7-13	CROSS SECTIONS (P)

GENERAL NOTES

1) FACTORS USED FOR ESTIMATING PLAN QUANTITIES ARE AS FOLLOWS AND SHALL NOT BE USED FOR THE BASIS OF FINAL QUANTITIES:

ALL AGGREGATE	2.05 TONS/CU YD
RIPRAP	1.50 TONS/CU YD

COMMITMENTS

NONE

STANDARDS

000001-08	STANDARD SYMBOLS, ABBREVIATIONS AND PATTERNS
001006	DECIMAL OF AN INCH AND OF A FOOT
701001-02	OFF-RD OPERATIONS, 2L, 2W, MORE THAN 15' AWAY
701006-05	OFF-RD OPERATIONS, 2L, 2W, 15' TO 24" FROM PAVEMENT EDGE
701201-05	LANE CLOSURE, 2L, 2W, DAY ONLY, FOR SPEEDS \geq 45 MPH
701901-08	TRAFFIC CONTROL DEVICES

MODEL INDEX OF SHEETS STANDARDS GENERAL NOTES and COMMITMENTS (Sheet)
FILE NAME: p:\illinois\p102dr1\documents\102dr1\DOT Office\District 9\BRO Projects\78991\CADD\AutoCAD\Sheets\0978991-SHE-Index_GenNotes.dgn

USER NAME = Zachary.Lomax	DESIGNED - _____	REVISED - _____
	DRAWN - _____	REVISED - _____
PLOT SCALE = 0.16666633 '1/ in.	CHECKED - _____	REVISED - _____
PLOT DATE = 1/19/2023	DATE - _____	REVISED - _____

**STATE OF ILLINOIS
DEPARTMENT OF TRANSPORTATION**

INDEX OF SHEETS, STANDARDS & GENERAL NOTES

SCALE: _____ SHEET 3 OF 13 SHEETS STA. _____ TO STA. _____

F.A.P. RTE.	SECTION	COUNTY	TOTAL SHEETS	SHEET NO.
776	102DR-1	HAMILTON	13	003
CONTRACT NO. 78991				
ILLINOIS FED. AID PROJECT				

SUMMARY OF QUANTITIES

0004

COUNTY:	HAMILTON COUNTY
ROUTE:	FAP 776
FUNDING:	100% STATE
LOCATION:	RURAL

CODE NUMBER	ITEM DESCRIPTION	UNIT	TOTAL QUANTITY
21400100	GRADING AND SHAPING DITCHES	FT	642
25000200	SEEDING, CLASS 2	ACRE	0.25
25000400	NITROGEN FERTILIZER NUTRIENT	POUND	23
25000500	PHOSPHORUS FERTILIZER NUTRIENT	POUND	23
25000600	POTASSIUM FERTILIZER NUTRIENT	POUND	23
25000700	AGRICULTURAL GROUND LIMESTONE	TON	0.5
25100630	EROSION CONTROL BLANKET	SQ YD	1099
28000250	TEMPORARY EROSION CONTROL SEEDING	POUND	50
28100801	STONE DUMPED RIPRAP, CLASS A1	TON	542
28100807	STONE DUMPED RIPRAP, CLASS A4	TON	1391
28200200	FILTER FABRIC	SQ YD	1961
67100100	MOBILIZATION	L SUM	1
70100450	TRAFFIC CONTROL AND PROTECTION, STANDARD 701201	L SUM	1
70107025	CHANGEABLE MESSAGE SIGN	CAL DA	42

REV. - MS

MODEL: S40 (Sheet)
FILE NAME: P:\fileshare\benley.com\PMIDOT\Documents\DOT Offices\District 9\BPD Projects\78991\CADD\Draws\CAD\Draws\78991-SUM-004.dgn

USER NAME = Zachary.Lomax	DESIGNED - _____	REVISED - _____
	DRAWN - _____	REVISED - _____
PLOT SCALE = 0.16666633 1/ in.	CHECKED - _____	REVISED - _____
PLOT DATE = 1/30/2023	DATE - _____	REVISED - _____

**STATE OF ILLINOIS
DEPARTMENT OF TRANSPORTATION**

SUMMARY OF QUANTITIES

SCALE: _____ SHEET 4 OF 13 SHEETS STA. _____ TO STA. _____

F.A.P. RTE.	SECTION	COUNTY	TOTAL SHEETS	SHEET NO.
776	102DR-1	HAMILTON	13	004
CONTRACT NO. 78991				
ILLINOIS FED. AID PROJECT				

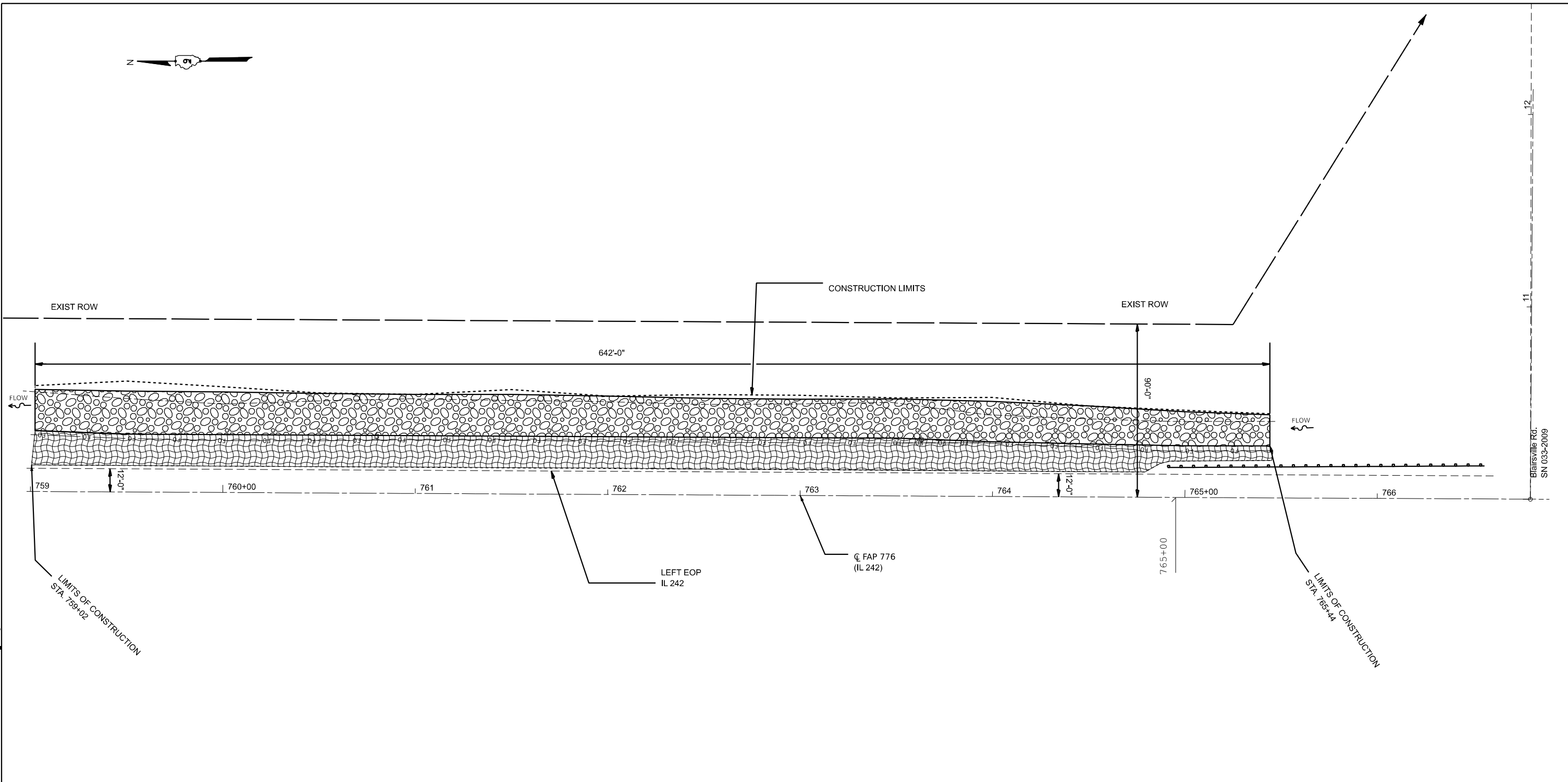

Blairsville Rd. SN 033-2009



STONE RIPRAP, CLASS A4



EROSION CONTROL BLANKET

MODEL: Plan View (Sheet)
FILE NAME: p:\fileserver\dot\Documents\DOT\Office\District 9\BDD Projects\78991\CADD\Drawings\CAD\Drawings\78991-SN033-2009-Plan.dwg

USER NAME = Zachary.Lomax	DESIGNED - _____	REVISED - _____
	DRAWN - _____	REVISED - _____
PLOT SCALE = 0.16666633 1/ in.	CHECKED - _____	REVISED - _____
PLOT DATE = 1/19/2023	DATE - _____	REVISED - _____

**STATE OF ILLINOIS
DEPARTMENT OF TRANSPORTATION**

GENERAL PLAN

SCALE: _____ SHEET 5 OF 13 SHEETS STA. _____ TO STA. _____

F.A.P. RTE.	SECTION	COUNTY	TOTAL SHEETS	SHEET NO.
776	102DR-1	HAMILTON	13	005
CONTRACT NO. 78991				
ILLINOIS FED. AID PROJECT				

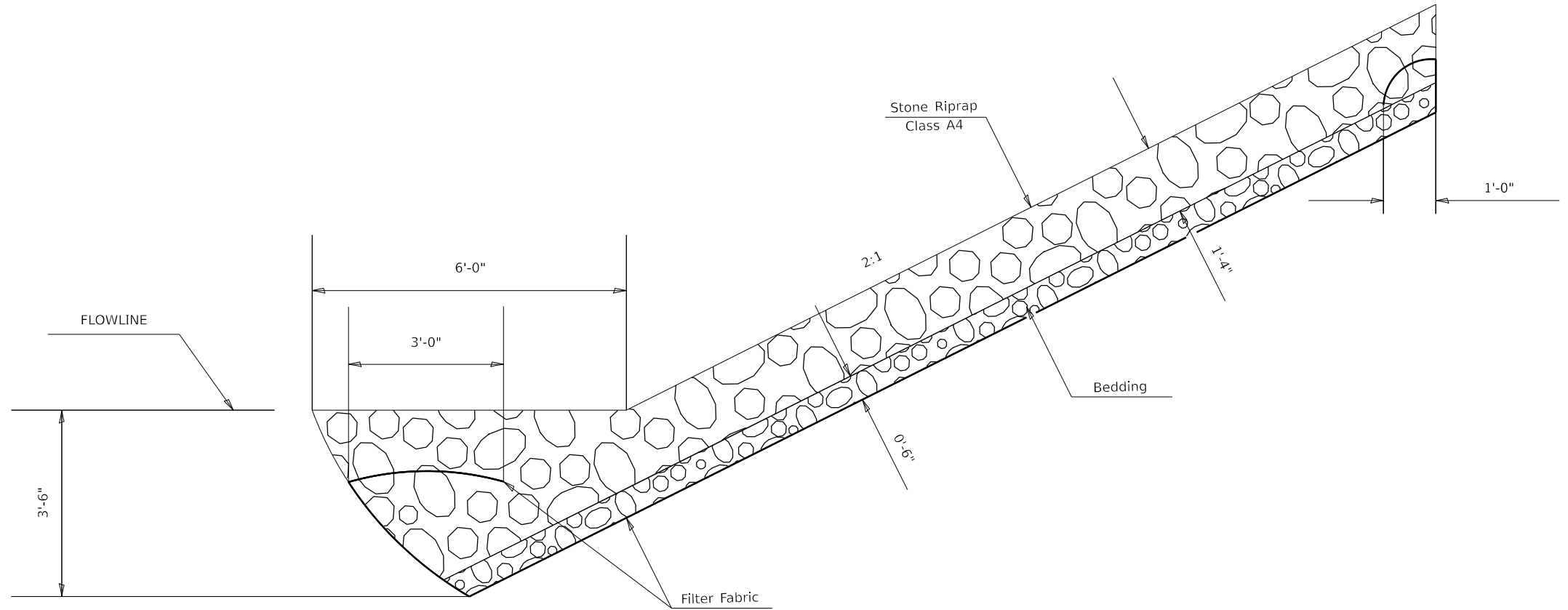

MODEL: Riprap Detail (Sheet)
 FILE NAME: P:\fileserver\pwworkspace\pwworkspace\DOT\Office\District 9\BBD\Projects\78991\CADD\Drawings\CADDsheets\0978991-SUB-Typical.dgn

USER NAME = Zachary.Lomax	DESIGNED - _____	REVISED - _____
	DRAWN - _____	REVISED - _____
PLOT SCALE = 0.16666633 1/ in.	CHECKED - _____	REVISED - _____
PLOT DATE = 1/19/2023	DATE - _____	REVISED - _____

**STATE OF ILLINOIS
DEPARTMENT OF TRANSPORTATION**

RIPRAP DETAIL

SCALE: _____ SHEET **6** OF 13 SHEETS STA. _____ TO STA. _____

F.A.P. RTE.	SECTION	COUNTY	TOTAL SHEETS	SHEET NO.
776	102DR-1	HAMILTON	13	006
CONTRACT NO. 78991				
ILLINOIS FED. AID PROJECT				

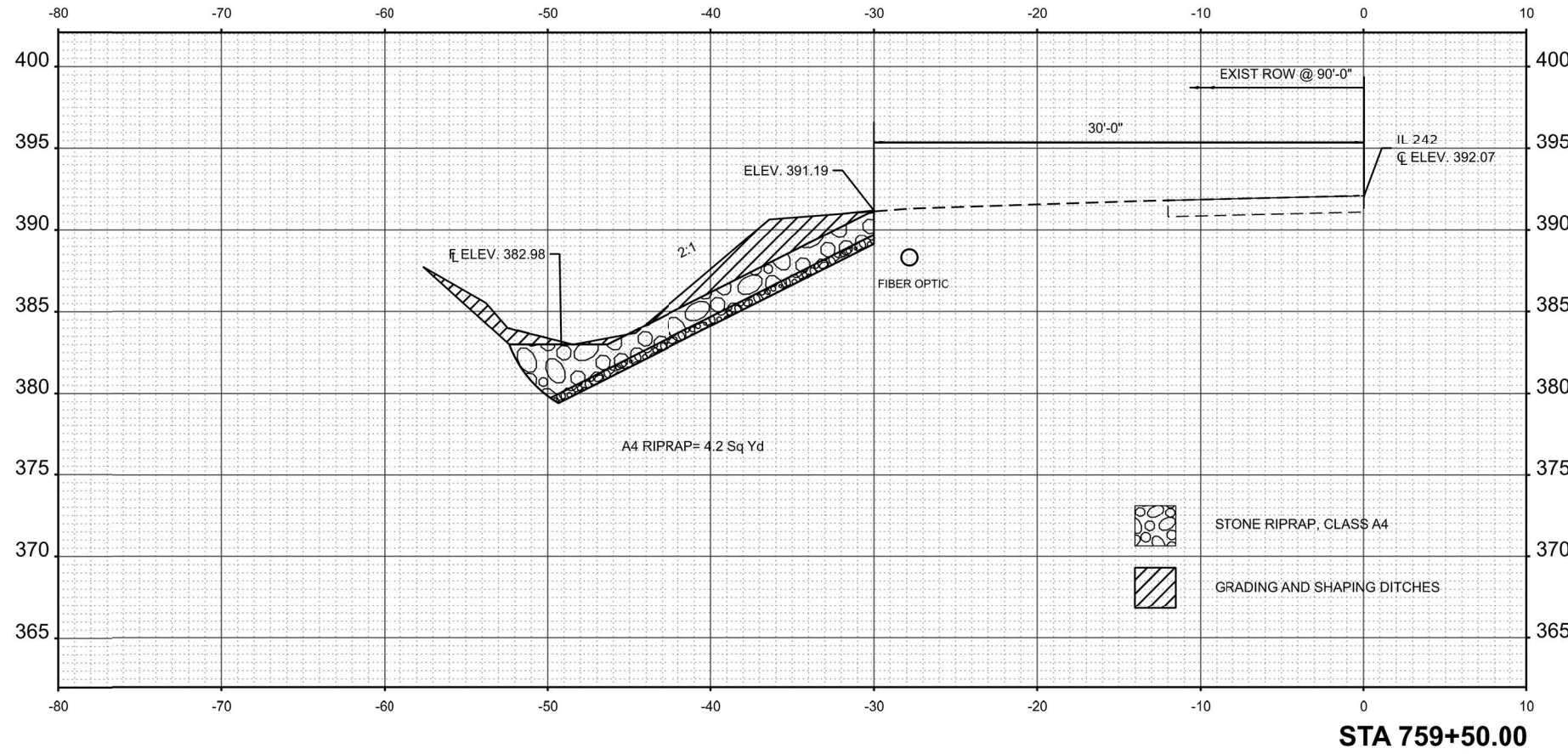

STA 759+50.00

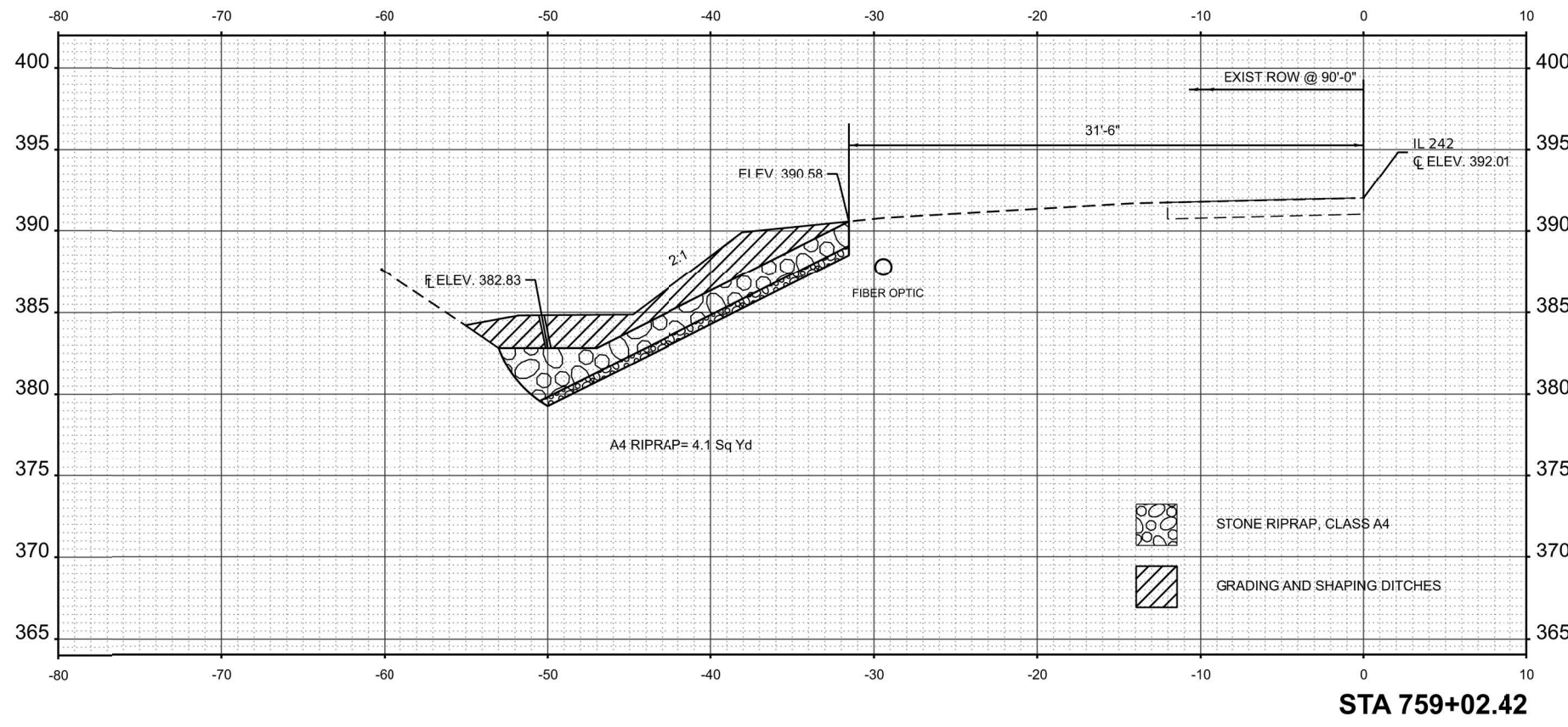

STA 759+02.42

MODEL: I:\2023\759+02.42 (Sheet)
 FILE NAME: P:\DOT\Documents\DOT Office\District 9\CRD Projects\78991\CADD\Drawings\78991-Sub-X-Section.dgn

USER NAME = Zachary.Lomax	DESIGNED - _____	REVISED - _____
	DRAWN - _____	REVISED - _____
PLOT SCALE = 0.16666633' / in.	CHECKED - _____	REVISED - _____
PLOT DATE = 1/19/2023	DATE - _____	REVISED - _____

STATE OF ILLINOIS
DEPARTMENT OF TRANSPORTATION

CROSS SECTIONS

SCALE: 1"=5' SHEET 007 OF 13 SHEETS STA. _____ TO STA. _____

F.A.P. RTE.	SECTION	COUNTY	TOTAL SHEETS	SHEET NO.
776	102DR-1	HAMILTON	13	7
CONTRACT NO. 78991				
ILLINOIS FED. AID PROJECT				

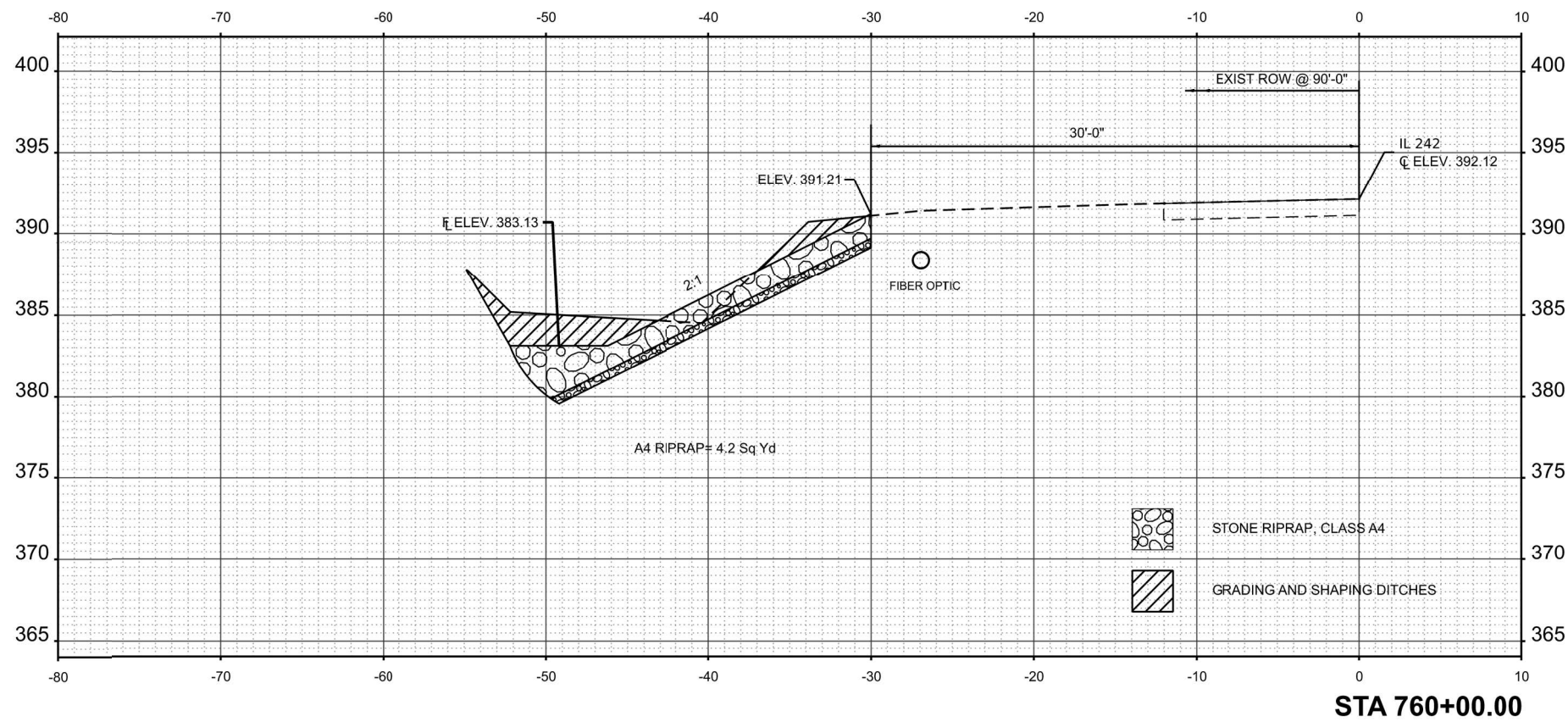
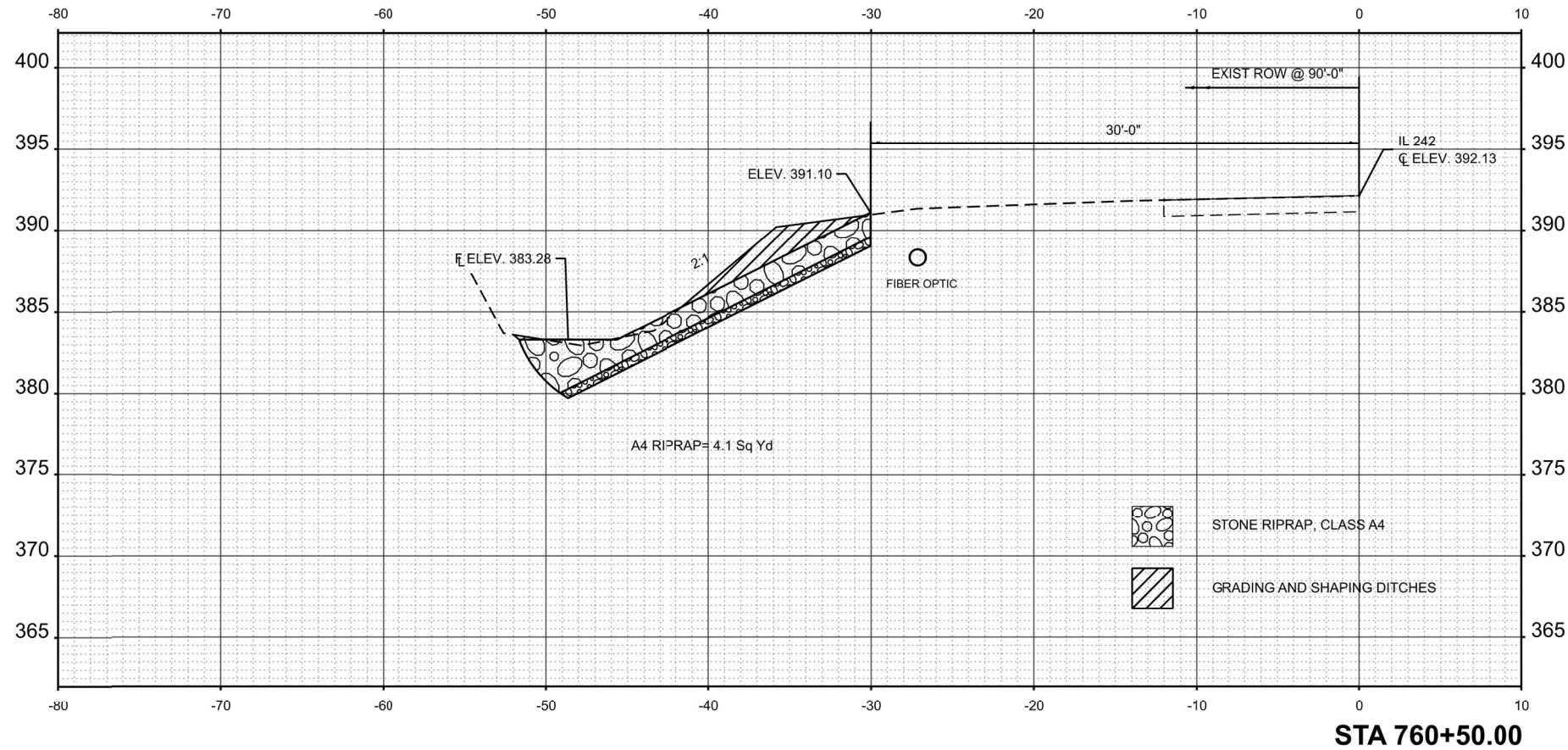

MODEL: IL242-7_760+00.00 [Sheet]
 FILE NAME: P:\GIS\Projects\DOT\Office\District 9\CRD\Project\78991\CADD\Sheet\09891-Sub-X-Section.dgn

USER NAME = Zachary.Lomax	DESIGNED - _____	REVISED - _____
	DRAWN - _____	REVISED - _____
PLOT SCALE = 0.16666633' / in.	CHECKED - _____	REVISED - _____
PLOT DATE = 1/19/2023	DATE - _____	REVISED - _____

**STATE OF ILLINOIS
DEPARTMENT OF TRANSPORTATION**

CROSS SECTIONS

SCALE: 1"=5' SHEET 008 OF 13 SHEETS STA. _____ TO STA. _____

F.A.P. RTE.	SECTION	COUNTY	TOTAL SHEETS	SHEET NO.
776	102DR-1	HAMILTON	13	8
CONTRACT NO. 78991				
ILLINOIS FED. AID PROJECT				

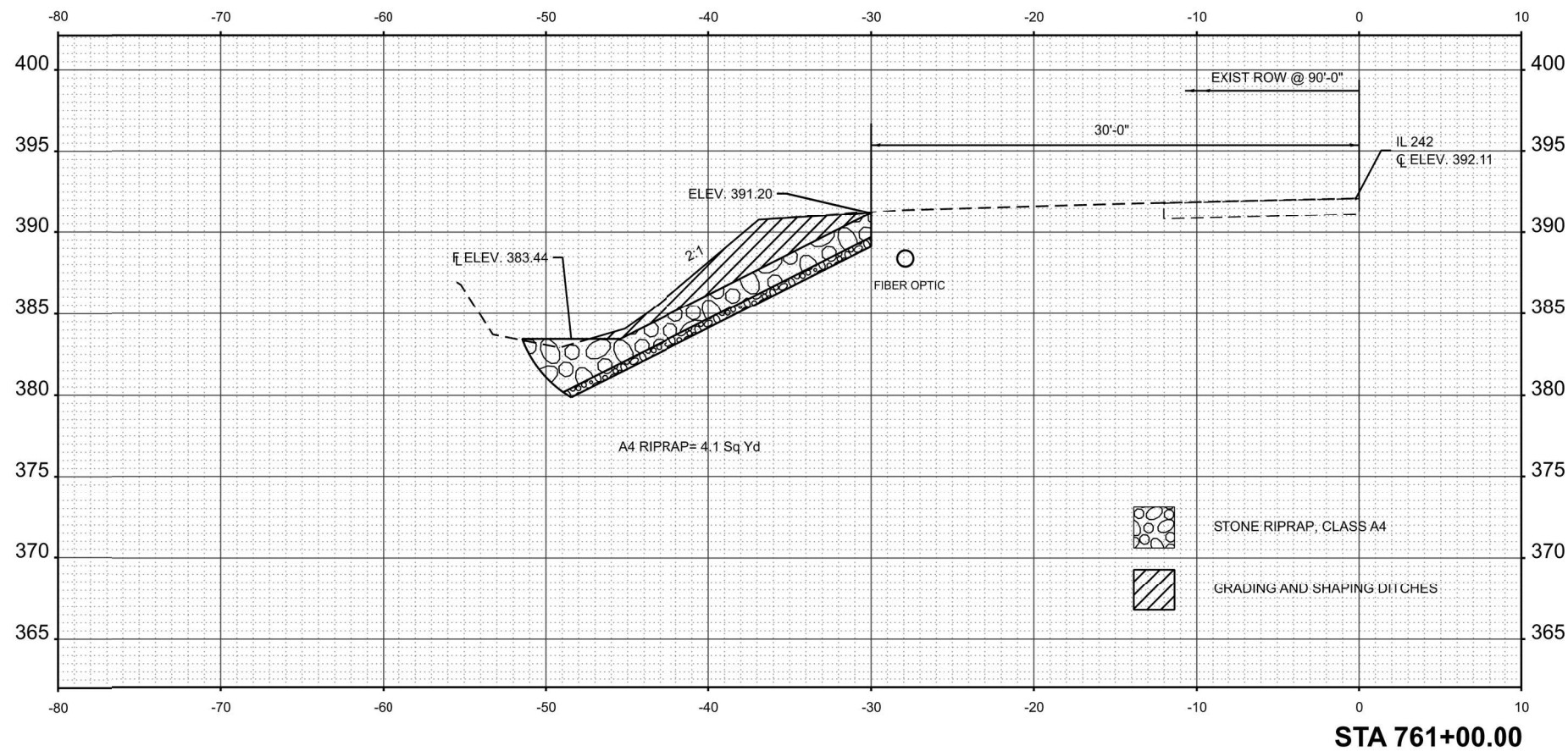
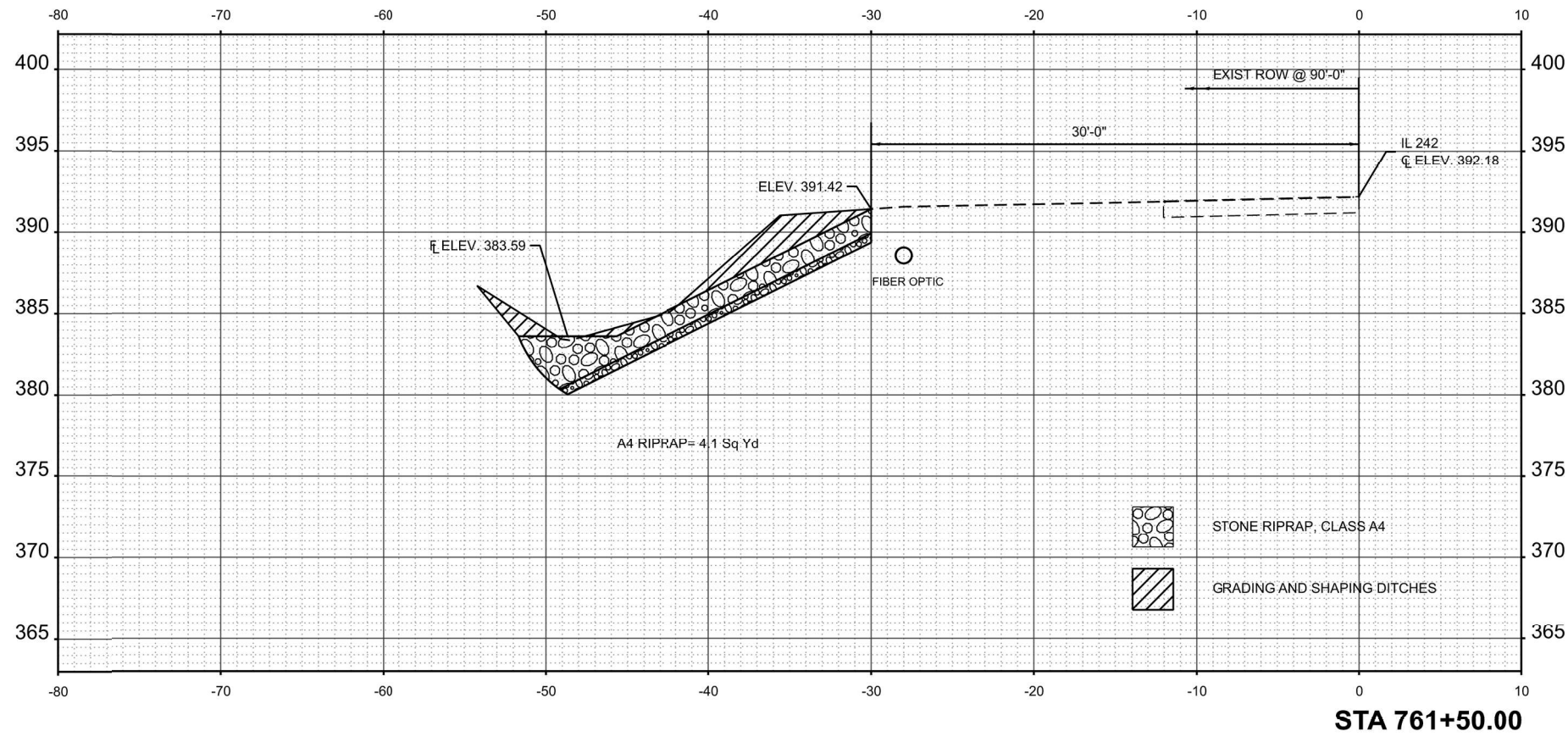

MODEL: IL242-7_761+00.00 [Sheet]
 FILE NAME: P:\GIS\Projects\DOT\Office\District 9\CRD\Projects\78991\CADD\Drawings\DOT\9891-Sub-X-Section.dgn

USER NAME = Zachary.Lomax	DESIGNED - _____	REVISED - _____
	DRAWN - _____	REVISED - _____
PLOT SCALE = 0.16666633' / in.	CHECKED - _____	REVISED - _____
PLOT DATE = 1/19/2023	DATE - _____	REVISED - _____

**STATE OF ILLINOIS
DEPARTMENT OF TRANSPORTATION**

CROSS SECTIONS

SCALE: 1"=5' SHEET 009 OF 13 SHEETS STA. _____ TO STA. _____

F.A.P. RTE.	SECTION	COUNTY	TOTAL SHEETS	SHEET NO.
776	102DR-1	HAMILTON	13	9
CONTRACT NO. 78991				
ILLINOIS FED. AID PROJECT				

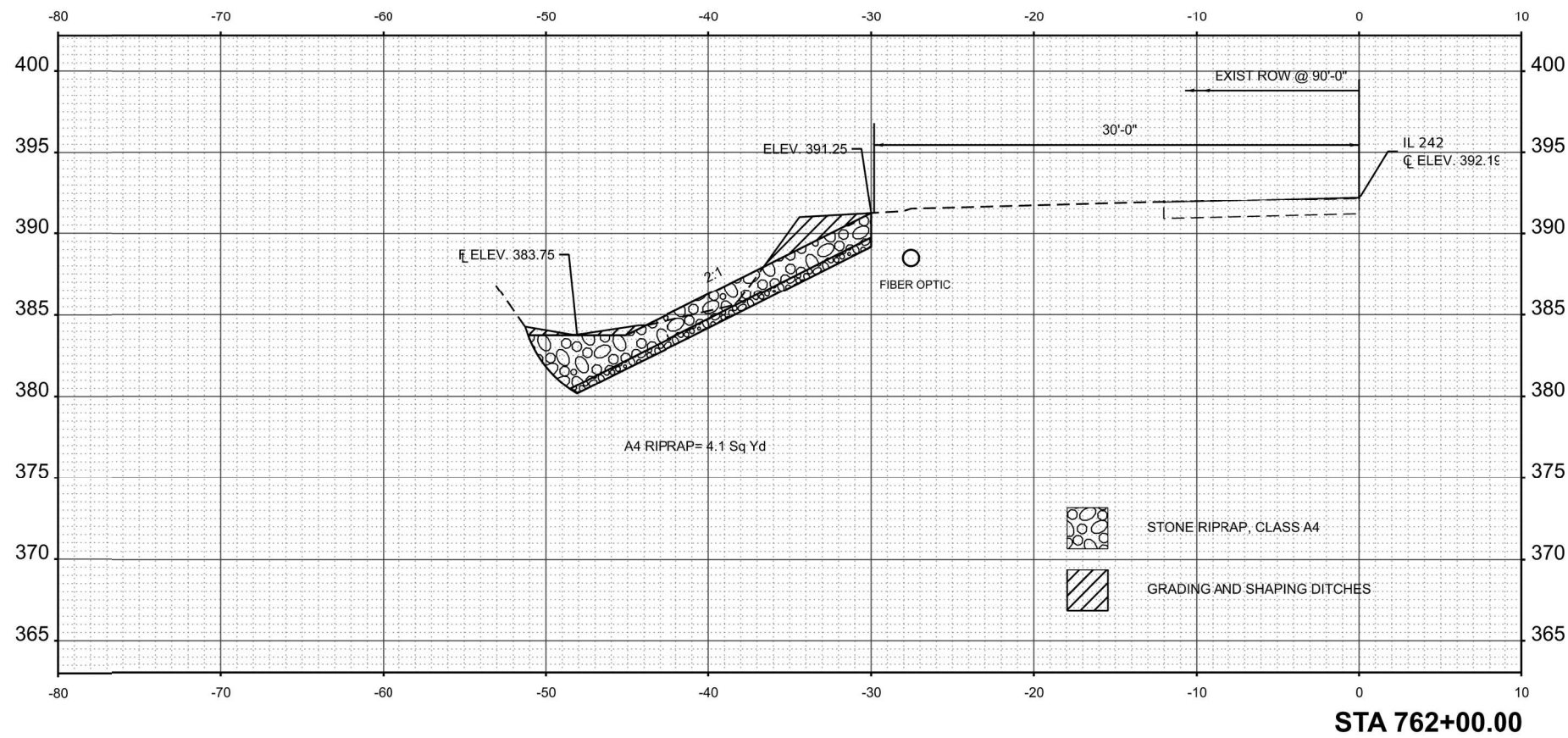
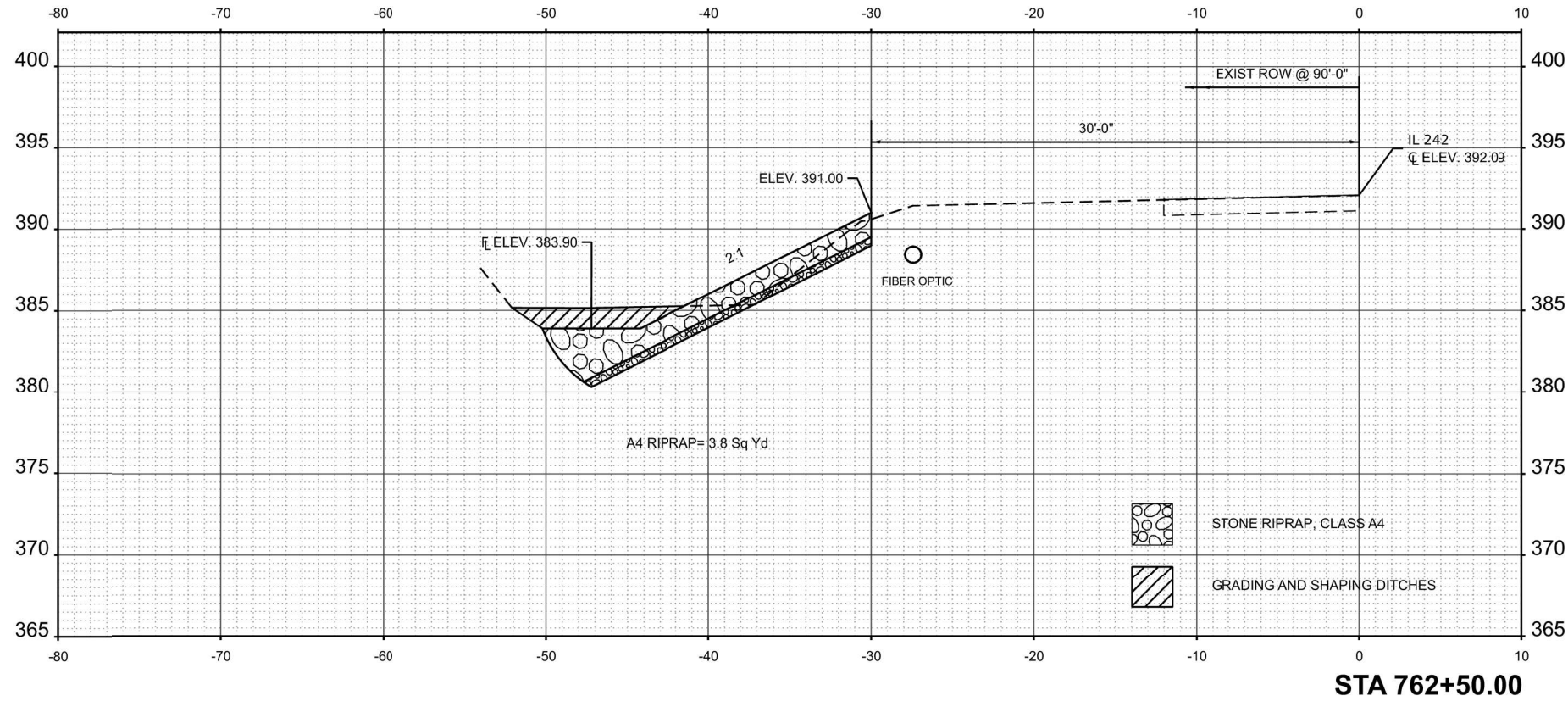

MODEL: I:\24-7-762+00.00 (Sheet)
 FILE NAME: P:\GIS\Projects\DOT\Office\District 9\CRD\Project\762+00.00\762+00.00-Sub-X-Section.dgn

USER NAME = Zachary.Lomax	DESIGNED - _____	REVISED - _____
	DRAWN - _____	REVISED - _____
PLOT SCALE = 0.16666633' / in.	CHECKED - _____	REVISED - _____
PLOT DATE = 1/19/2023	DATE - _____	REVISED - _____

**STATE OF ILLINOIS
DEPARTMENT OF TRANSPORTATION**

CROSS SECTIONS

SCALE: 1"=5' SHEET 010 OF 13 SHEETS STA. _____ TO STA. _____

F.A.P. RTE.	SECTION	COUNTY	TOTAL SHEETS	SHEET NO.
776	102DR-1	HAMILTON	13	10
CONTRACT NO. 78991				
ILLINOIS FED. AID PROJECT				

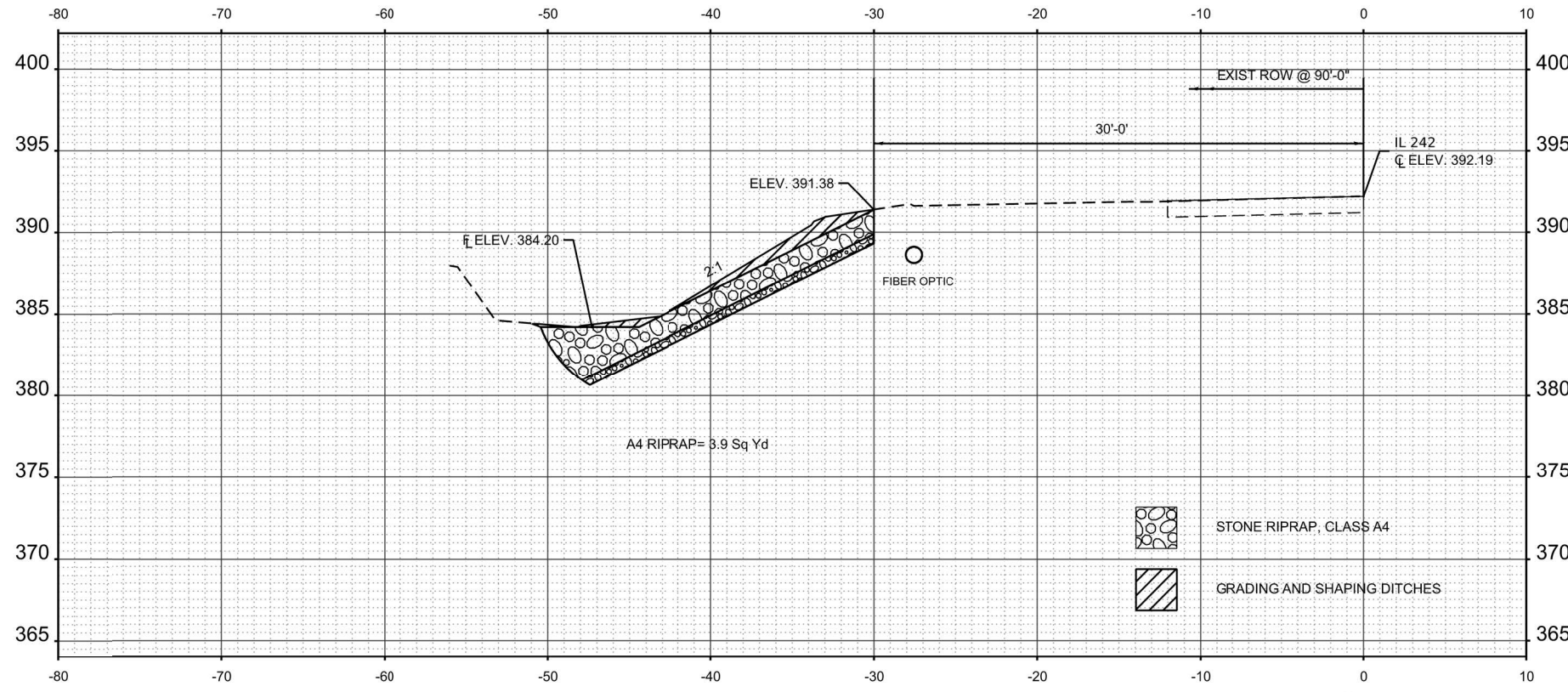

STA 763+50.00

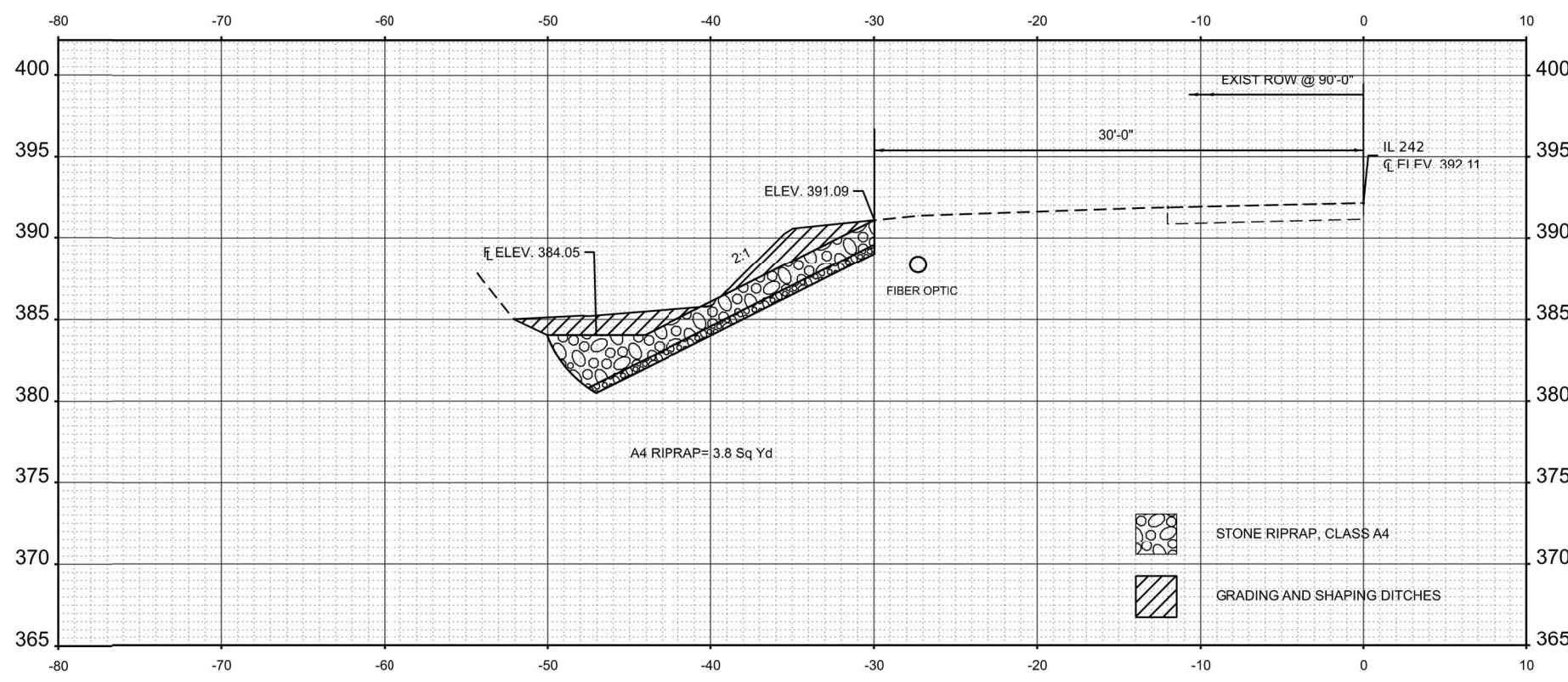

STA 763+00.00

MODEL: I:\24-7-763+00.00 [Sheet]
 FILE NAME: P:\GIS\Projects\DOT\Office\District 9\CRD\Project\763+00.00\763+00.00_Sheet.dgn

USER NAME = Zachary.Lomax	DESIGNED - _____	REVISED - _____
	DRAWN - _____	REVISED - _____
PLOT SCALE = 0.16666633' / in.	CHECKED - _____	REVISED - _____
PLOT DATE = 1/19/2023	DATE - _____	REVISED - _____

**STATE OF ILLINOIS
DEPARTMENT OF TRANSPORTATION**

CROSS SECTIONS

SCALE: 1"=5' SHEET 011 OF 13 SHEETS STA. _____ TO STA. _____

F.A.P. RTE.	SECTION	COUNTY	TOTAL SHEETS	SHEET NO.
776	102DR-1	HAMILTON	13	11
CONTRACT NO. 78991				
ILLINOIS FED. AID PROJECT				

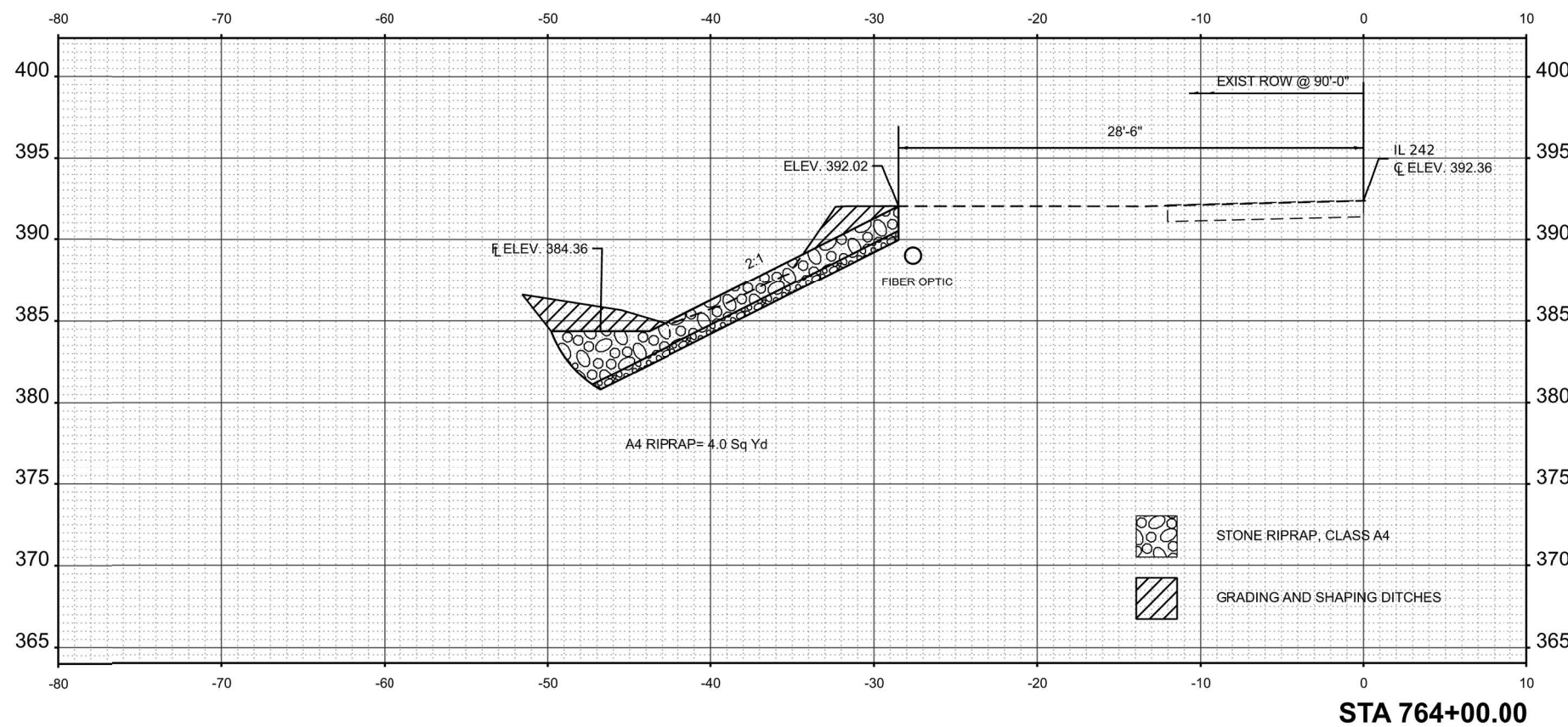
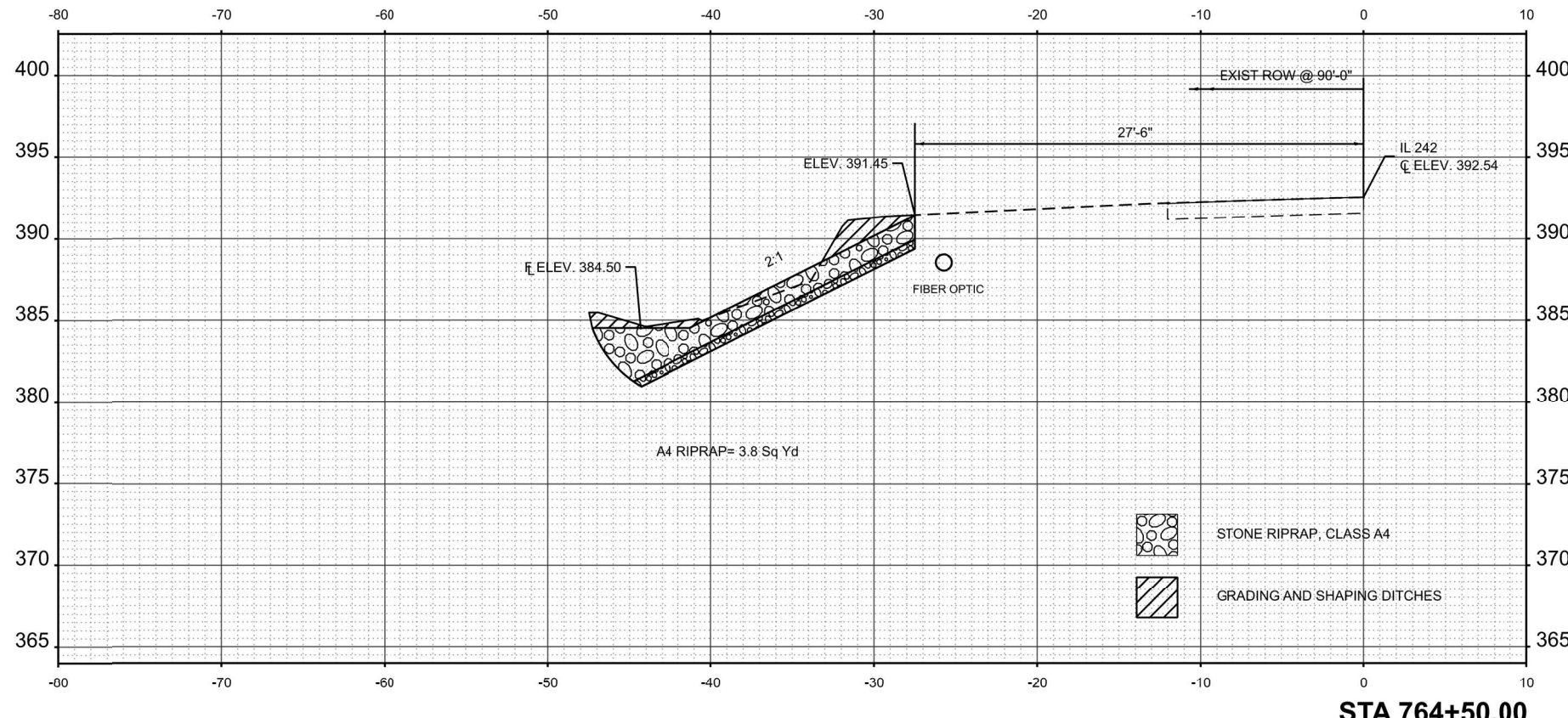

MODEL: IL242-7-764+00.00 [Sheet]
 FILE NAME: P:\GIS\Projects\DOT\Office\District 9\CRD\Projects\78991\CADD\Sheet\0918991_ShtX-XSection.dgn

USER NAME = Zachary.Lomax	DESIGNED - _____	REVISED - _____
	DRAWN - _____	REVISED - _____
PLOT SCALE = 0.16666633' / in.	CHECKED - _____	REVISED - _____
PLOT DATE = 1/19/2023	DATE - _____	REVISED - _____

STATE OF ILLINOIS
DEPARTMENT OF TRANSPORTATION

CROSS SECTIONS

SCALE: 1"=5' SHEET 012 OF 13 SHEETS STA. _____ TO STA. _____

F.A.P. RTE.	SECTION	COUNTY	TOTAL SHEETS	SHEET NO.
776	102DR-1	HAMILTON	13	12
				CONTRACT NO. 78991
ILLINOIS FED. AID PROJECT				

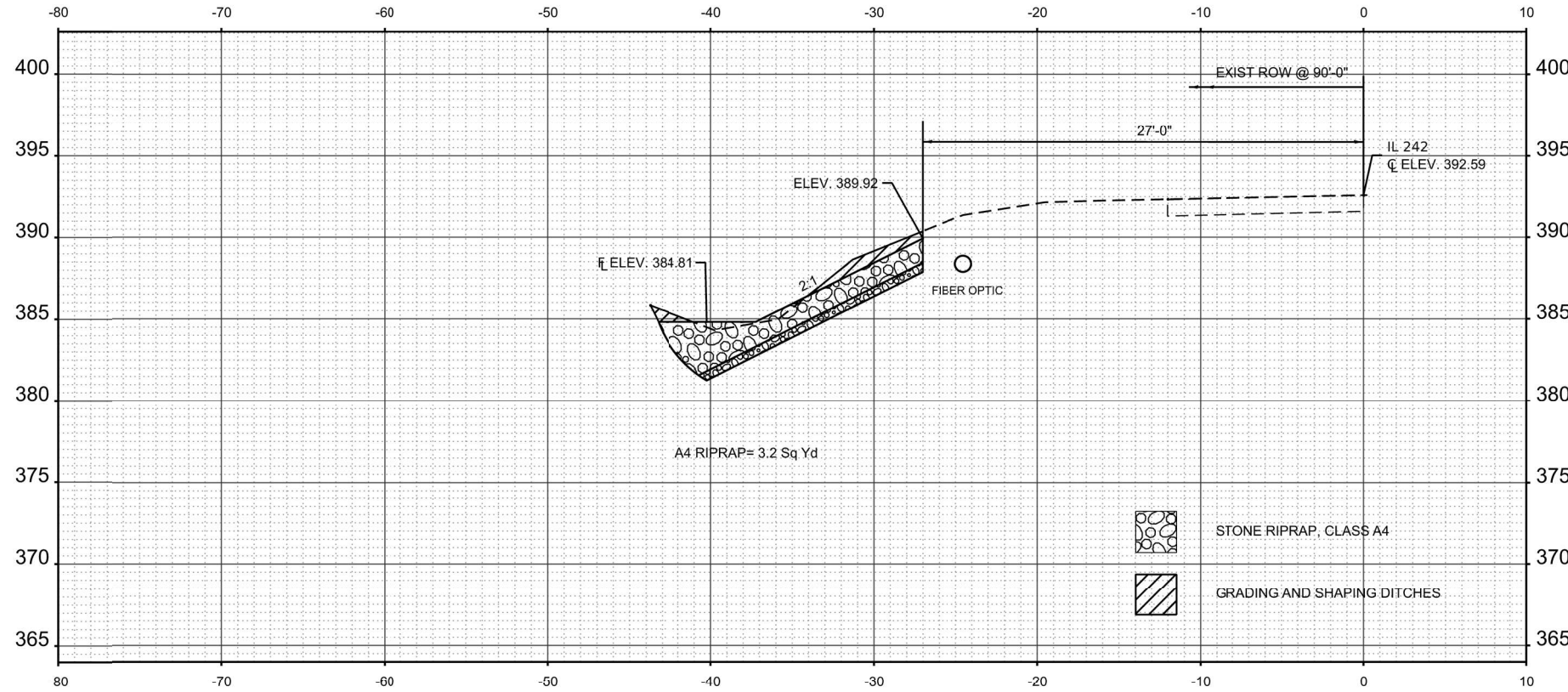

STA 765+44.15

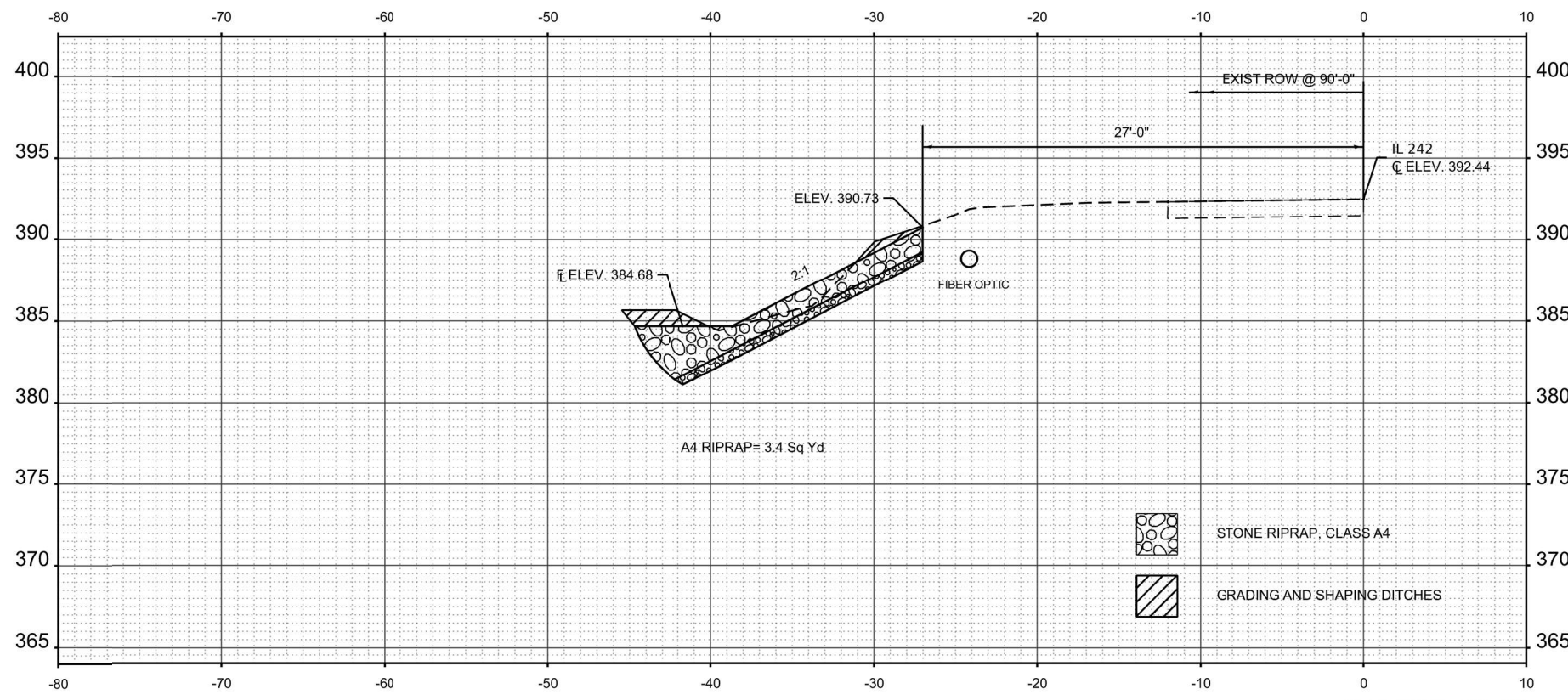

STA 765+00.00

MODEL: I:\24-7-765+00.00 [Sheet]
 FILE NAME: P:\GIS\Projects\DOT\Office\District 9\CRD\Project\765+00.00\765+00.00-Station.dgn

USER NAME = Zachary.Lomax	DESIGNED - _____	REVISED - _____
	DRAWN - _____	REVISED - _____
PLOT SCALE = 0.16666633' / in.	CHECKED - _____	REVISED - _____
PLOT DATE = 1/19/2023	DATE - _____	REVISED - _____

**STATE OF ILLINOIS
DEPARTMENT OF TRANSPORTATION**

CROSS SECTIONS

SCALE: 1"=5' SHEET 013 OF 13 SHEETS STA. _____ TO STA. _____

F.A.P. RTE.	SECTION	COUNTY	TOTAL SHEETS	SHEET NO.
776	102DR-1	HAMILTON	13	13
CONTRACT NO. 78991				
ILLINOIS FED. AID PROJECT				