

ROUTE NO.	SECTION	COUNTY	TOTAL SHEETS	SHEET NO.
FAS 788 (C.H. 24/ C.H. 16)	03-00075- 00-BR WASH. 03-00082- 00-BR CLIN.	WASHINGTON CLINTON	22	10

FINAL SURVEY

DATE: _____

NO. 1: _____

NO. 2: _____

NO. 3: _____

NO. 4: _____

NO. 5: _____

ORIGINAL SURVEY

DATE: _____

NO. 1: _____

NO. 2: _____

NO. 3: _____

NO. 4: _____

NO. 5: _____

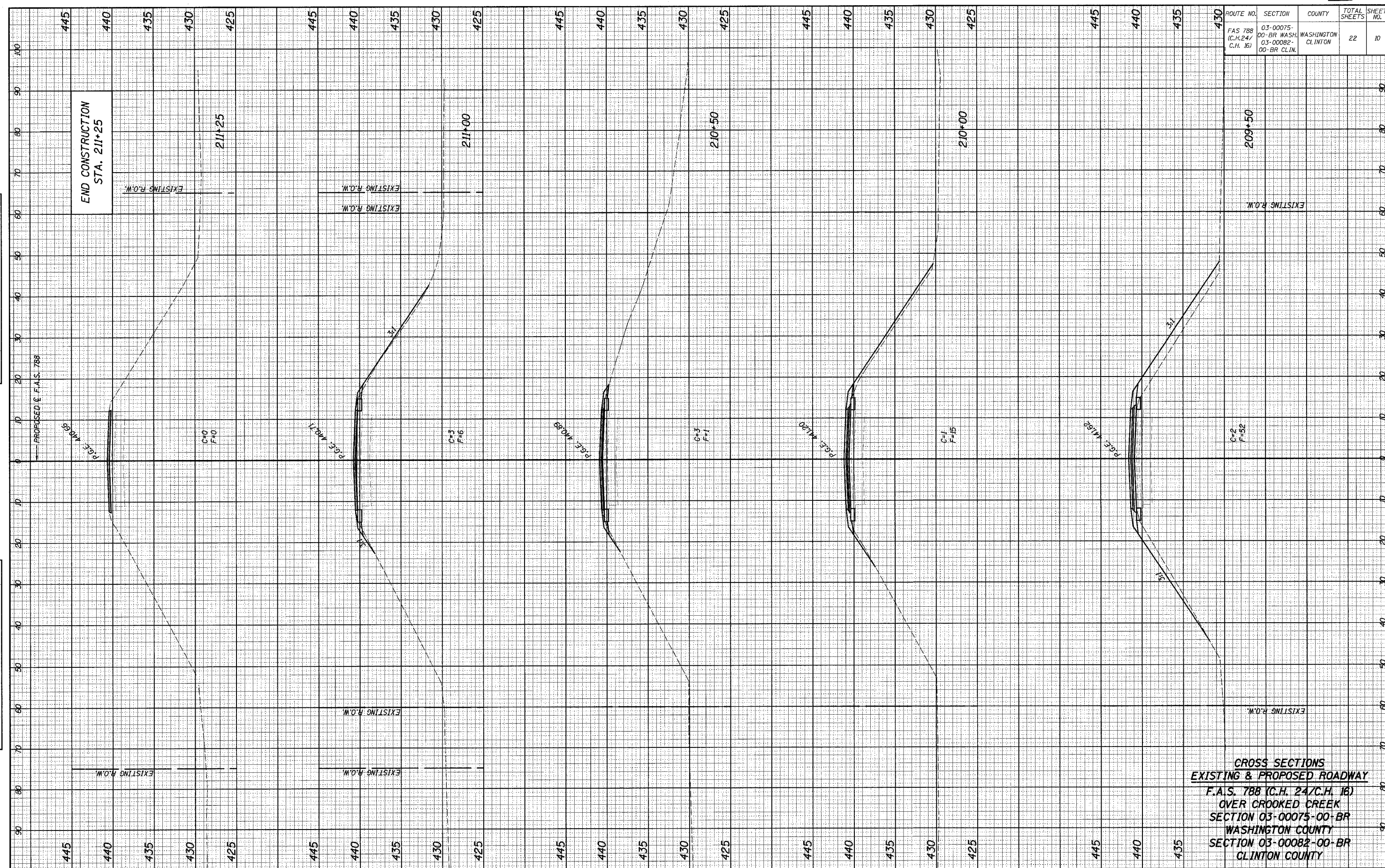

**CROSS SECTIONS
EXISTING & PROPOSED ROADWAY**
 F.A.S. 788 (C.H. 24/C.H. 16)
 OVER CROOKED CREEK
 SECTION 03-00075-00-BR
 WASHINGTON COUNTY
 SECTION 03-00082-00-BR
 CLINTON COUNTY